



TRITONPRO™ COMMERCIAL SELECTABLE STRIP LIGHT, GEN 1

CSSL1



CSSL14B1UNVFD8CSLFGSP

Project Name:	
Catalog Number:	
Type:	
Note:	
Date:	



Intended Use

- The TritonPro CSSL1 linear fixture is used in various settings due to its versatility and energy efficiency. It is ideal for low bay, assembly line, strip, surface mount, continuous run or task options in warehouse, commercial, and retail environments where linear lighting is needed.

Construction

- Available in 2', 4' and 8' fixture lengths.
- Easily accessible dip switches allow the user to select CCT and lumen output in the field providing flexibility to adapt to different work environment dynamics.
- White finish steel body.
- Frosted impact polycarbonate lens for increased durability, high impact resistance and safety.

Electrical

- Standard 2kV surge protection per ANSI C82.77-5-2015.
- Standard with 120v-277v 0-10v dimming drivers.
- Field selectable wattage between 5 settings.
- Field selectable CCT between 3000K, 3500K, 4000K, 5000K, and 6500K at 80CRI.

Controls and Sensor Options

- Factory and field-installed standalone and bluetooth control options allow luminaire controllability, contributing to additional energy savings. Refer to page 5 for more information.

Additional Options

- Factory and field installable battery backup available.

Standard Part Number	DLC Product ID	DLC Listing
CSSL12A1UNVFD8CSLFGSP	S-C9N3BP	Standard
CSSL14B1UNVFD8CSLFGSP	S-SMVBQ2	Standard
CSSL18C1UNVFD8CSLFGSP	S-DTHXPX	Standard

Installation

- Surface and suspended mounting options.
- Optional continuous end-to-end connection. Standard wiring harness ships from factory (not applicable for battery back up). Additional mounting plate sold separately [see details on page 2].

Fixture Certifications & Listings

- cULus Listed
- UL/cUL Listed for Damp Locations
- FCC Certified
- RoHS Compliant
- DesignLights Consortium™ Standard qualified luminaire
- Visit the [DLC QPL](#) for listed models

Warranty

- 5 year warranty standard.
- Optional 10 year warranty available at additional cost.
- See Orion's [Product Limited Warranty](#) for more details and information.



TRITONPRO™ COMMERCIAL SELECTABLE STRIP LIGHT, GEN 1

Ordering Information Example (NOTE: No dashes or spaces unless noted below)

CSSL14B1UNVFD8CSLFGSP

CSSL1

Ordering Information [Enter Selected Catalog Number Below for Factory-Installed Options]

Series	Fixture Size	Nominal Lumen Code ¹	Voltage	Fixture Type	CRI; Color Temp	Lens Options	Power Connection	Fixture Options	Packaging
CSSL1 = TritonPro Commercial Selectable Strip, Gen 1	2 = 2' 4 = 4' 8 = 8'	2 ' A1 = 1,000lm/ 1,400lm/ 1,800lm/ 2,200lm/ 2,600lm 4 ' B1 = 2,600lm/ 3,200lm/ 3,900lm/ 4,500lm/ 5,200lm 8 ' C1 = 5,200lm/ 6,500lm/ 7,800lm/ 9,100lm/ 10,400lm	UNV = 120v-277v	FD = Full Dimming 0-10v	8CS = 80 CRI; Selectable CCT 3000K/ 3500K/ 4000K/ 5000K/ 6500K	LFG = Lens, General Distribution	[blank] = Hardwire	[blank] = No Options BB08 = Battery Back Up, 8w ² SBM = Integrated Basic Microwave Sensor [RC100 remote for programming]	SP = Single Pack
		All fixtures are set to the max lumen output at 6500K ¹ For actual performance information, see performance table			All fixtures are set to the max lumen output at 6500K			² In emergency mode, the fixture operates at 6500K	

Standard Mounting Accessories Included



Accessories [Field Installed] [View our Install Instructions Here](#)

Battery Back Up Kit Options	
CSSL1-2FT-BB08-KIT	Field Installed Battery Back Up Kit, 2'
CSSL1-BB08-KIT	Field Installed Battery Back Up Kit, 4' and 8'
Continuous Mounting Plate	
CSSL1-CSP-KIT	Continuous End-to-End Plate Kit
For safety, do not connect more than six - 2' fixtures, four - 4' fixtures, and three - 8' fixtures in a row	
Controls and Sensors	
KIT-CSSL1-SBM	Integrated - Sharkward Microwave, Input Voltage 12V DC, 13' Mounting Height Max, DIP Switch Programming, Optional RC-100 Programming Remote
KIT-CSSL1-KBP	End Mounted - Keilton Basic PIR, Input Voltage 12V DC, High Bay Lens 40' Mounting Height Max, SC02-AUX 3.5mm 90° External Adapter, Requires RM51 Programming Remote
KIT-CSSL1-KBM	End Mounted - Keilton Basic Microwave, Input Voltage 12V DC, 20' Mounting Height Max, SC02-AUX 3.5mm 90° External Adapter, Requires RM51 Programming Remote
KIT-CSSL1-KAP	End Mounted - Keilton +Autani Bluetooth Mesh Sensor, Input Voltage 12V DC, High Bay Lens 40' Mounting Height Max, SC02-AUX 3.5mm 90° External Adapter
KIT-CSSL1-KACN	End Mounted - Keilton +Autani Bluetooth Mesh Control Node, Input Voltage 12V DC, High Bay Lens 40' Mounting Height Max, SC02-AUX 3.5mm 90° External Adapter
Sensor Accessories	
RC100	Remote Control for Sharkward Microwave Sensor, (KIT-CSSL1-SBM), optional for Sharkward sensors programming
RM51	Remote Control for Keilton Basic Microwave Sensor (KIT-CSSL1-KBM and KIT-CSSL1-KBP), required for Keilton sensors programming



TRITONPRO™ COMMERCIAL SELECTABLE STRIP LIGHT, GEN 1

CSSL1

Performance Information, 120v, ≥ 80 CRI³

Nominal Lumen Code	Wattage	3000K		3500K		4000K		5000K		6500K	
		Lumens	LPW	Lumens	LPW	Lumens	LPW	Lumens	LPW	Lumens	LPW
2'											
A1	8w	1,023lm	128	1,023lm	128	1,045lm	131	1,055lm	132	1,060lm	133
	11w	1,406lm	128	1,407lm	128	1,437lm	131	1,451lm	132	1,458lm	133
	14w	1,790lm	128	1,791lm	128	1,829lm	131	1,846lm	132	1,856lm	133
	17w	2,173lm	128	2,175lm	128	2,221lm	131	2,242lm	132	2,253lm	133
	20w	2,557lm	128	2,558lm	128	2,613lm	131	2,637lm	132	2,651lm	133
4'											
B1	20w	2,570lm	128	2,571lm	129	2,626lm	131	2,651lm	133	2,664lm	133
	25w	3,212lm	128	3,214lm	129	3,282lm	131	3,313lm	133	3,331lm	133
	30w	3,855lm	128	3,857lm	129	3,939lm	131	3,976lm	133	3,997lm	133
	35w	4,497lm	128	4,499lm	129	4,595lm	131	4,638lm	133	4,663lm	133
	40w	5,114lm	128	5,117lm	129	5,225lm	131	5,275lm	133	5,302lm	133
8'											
C1	40w	5,093lm	127	5,204lm	130	5,204lm	130	5,253lm	131	5,281lm	132
	50w	6,367lm	127	6,505lm	130	6,505lm	130	6,567lm	131	6,601lm	132
	60w	7,640lm	127	7,806lm	130	7,806lm	130	7,880lm	131	7,921lm	132
	70w	8,913lm	127	9,107lm	130	9,107lm	130	9,193lm	131	9,107lm	132
	80w	10,123lm	127	10,343lm	130	10,343lm	130	10,441lm	131	10,496lm	132

Lumen Maintenance⁴

Fixture Size	Nominal Lumen Code	Operating Temperature	Calculated Lumen Maintenance		
			L70	L80	L90
2'	A1	25°C	170,000	106,000	52,000
		45°C	168,000	106,000	51,000
4'	B1	25°C	170,000	106,000	52,000
		45°C	168,000	106,000	51,000
8'	B1	25°C	170,000	106,000	52,000
		45°C	168,000	106,000	51,000

Battery Back Up - Lumen Output in Emergency Mode

Nominal Lumen Code	Voltage	Wattage	Lumen Output
All Lumen Codes	UNV	8w	1,040lm

Ambient Operating Temperatures

Nominal Lumen Code	Standard Operating Range	With Battery Back Up
All Lumen Packages	-40°C to 45°C [-40°F to 113°F]	Min. Operating Temp. 0°C [32°F]
Operating Ranges with Sensors		
KIT-CSSL1-SBM	-40°C to 45°C [32°F to 113°F]	
KIT-CSSL1-KBP	-30°C to 45°C -22°F to 113°F]	
Kit-CSSL1-KBM	-30°C to 45°C -22°F to 113°F]	
KIT-CSSL1-KAP	-30°C to 45°C -22°F to 113°F]	
KIT-CSSL1-KACN	-30°C to 45°C -22°F to 113°F]	

Additional Specification Information

³ Actual performance may vary by up to ±10% of values listed; facility factors and fixture options can affect performance values

⁴ Calculated hours based on TM-21 projections and components used at the time of testing. Warranty is not associated with Calculated Lumen Maintenance



TRITONPRO™ COMMERCIAL SELECTABLE STRIP LIGHT, GEN 1

CSSL1

Photometrics

Visit orionlighting.com to obtain all .IES files

2' A1 840

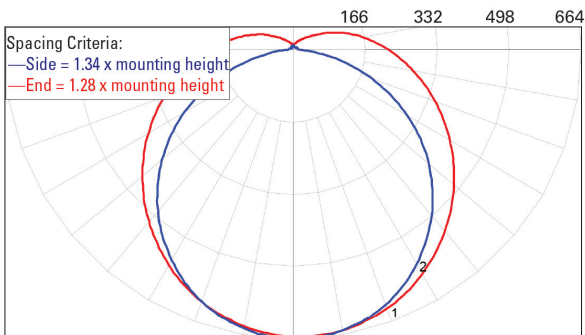

4' B1 840

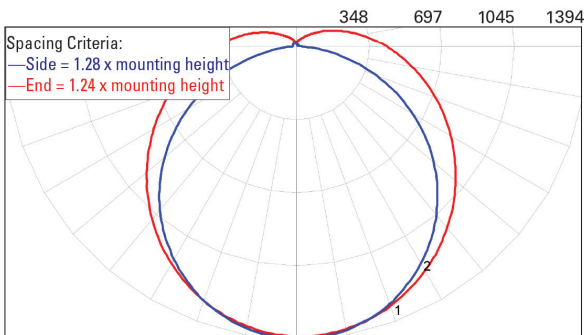

8' C1 840

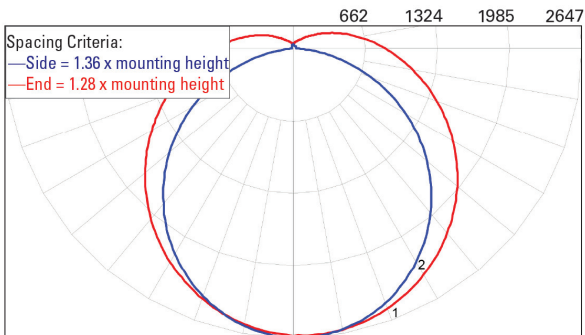

Physical Information

Fixture Size	Nominal Lumen Code	Length	Width	Depth	Weight ⁵
2'	A1	24.02"	2.48"	3.15"	2.25lbs
4'	B1	47.24"	2.48"	3.15"	3.75lbs
8'	C1	94.49"	2.48"	3.15"	6.75lbs.

8ft Front View

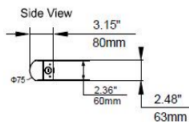
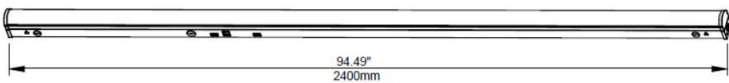

4ft Front View

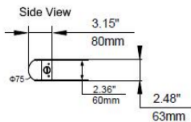
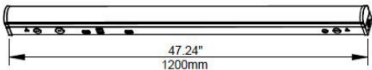

2ft Front View

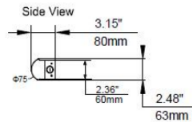
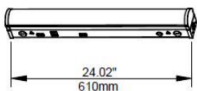

Additional Specification Information

⁵ Weight varies based on option selected



Controls

Standalone Sensors

Simple, standalone commercial lighting controls including switches, fixture-integrated sensors, and infrared remotes that provide lighting control without networking or radios.

- **SBM** – The ANT-3A Series is a microwave sensor for occupancy sensing. Different modes can be selected for various applications using dip switches at the sensor level or the RC100 IR remote controller.
- **KBM** – The EFS07 Series PIR sensor combines occupancy sensing with a photocell. Different modes can be selected for various applications using the RM51 IR remote controller.
- **KBP** – The EFS06R is an external mount Photocell and Microwave sensor. Different modes can be selected for various applications using the RM51 IR remote controller.
- **RM51** – The RM51 Remote is used to program the configurations of the Keilton Basic sensors using infrared (IR) communications with the devices. It offers 6 default modes of configurations plus manual settings. Customer configurations can be created, saved and then sent to each device ensuring a rapid deployment.
- **RC100** – The RC-100 Remote is used to program the configurations of the Sharkward sensors using infrared (IR) communications with the devices. It offers 4 custom modes of configurations plus manual settings. Customer configurations can be created, saved and then sent to each device ensuring a rapid deployment.

Bluetooth Mesh Sensors – Keilton+Autani

DLC-listed gateway-free local room-based Bluetooth® mesh commercial lighting control software and hardware products that include mobile apps, sensors, controllers, switches and other devices for commercial lighting.

- **KAP** – The EFS106 is ideal for Luminaire Level Lighting Control [LLLC/NLC5] applications. Featuring integrated daylight harvesting and PIR motion sensors, the sensors are equipped with the AlgoH2 algorithm to maximize detection for high bay applications up to 40 ft without false triggers.
- **KACN** – The WPPA102 is an advanced Bluetooth® control node that enables wireless linking with the Keilton+Autani ecosystem.

For more detailed instructions on commissioning, settings, and features please visit [Keilton App Instructions](#)



Keilton iOS



Keilton Android
@GooglePlay

Accessories (Field Installed)

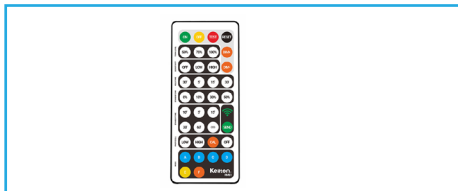

Keilton Basic Handheld Sensor Remote
(RM51)



Continuous End-to-End Plate Kit
(CSSL1-CSP-KIT)



End Mounted Sensor
(KIT-CSSL1-Kxxx)