

## LED Lumen & CCT Selectable Vaportight

Instruction Number: P-INT-X-467

Product Series: VTSS1

Use these standard assembly instructions for the VTSS1 fixture.

### Components

- 1 VTSS1 Fixture

### Tools Required for Installation

- Cordless Drill
- Philips Screwdriver and Flat Head Screwdriver
- Wirestripper/cutter
- Wire nuts

### WARNING!



1. Field installers are responsible for recognizing specific site requirements and making adjustment to assure a complete, functional installation.
2. Electrical connections must be made by a qualified electrician and in accordance with NEC and local codes.
3. Make all power connections using UL listed components.
4. Make sure the supply voltage is the same as the rated voltage of the luminaire.
5. Proper grounding is required to ensure safety.
6. Please wear gloves to avoid injury before installation.
7. Check if there is any damage during shipping. If so, contact manufacturer immediately.
8. Read the installation instruction carefully to check whether all the accessories are included. After confirmation, then install the fixture according to installation steps.
9. Appropriate safety equipment needed during installation, to be determined by installer and per applicable safety standards and precautions.
10. Risk of fire or electrical shock. DO NOT cover fixture with insulation or similar material.
11. DO NOT install on unstable or easily breakable surface.

### Standard Wiring Diagram

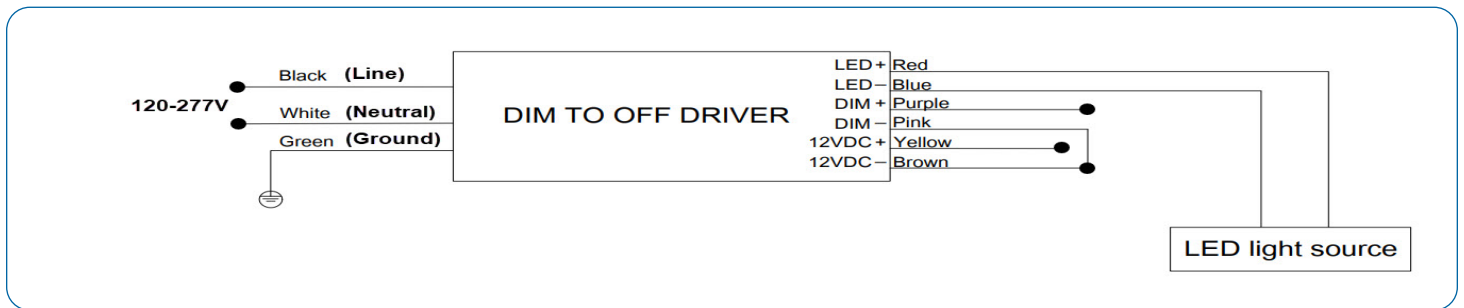

### Field Adjustable Wattage and CCT

End users can adjust the color temperature and lumen output to the desired level by the two dip switches located on the back of the driver channel. Each switch offers three options (3 lumen outputs and 3 color temperatures). See below for label and Fig. A for switch locations.

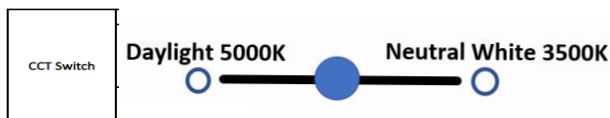

Lumen code	Wattage Switch	Position		
		Left	Middle	Right
A1	34W	30W	30W	25W
	4,500lm	4,000lm	4,000lm	3,500lm
B1	54W	46W	38W	38W
	7,000lm	6,000lm	5,000lm	5,000lm

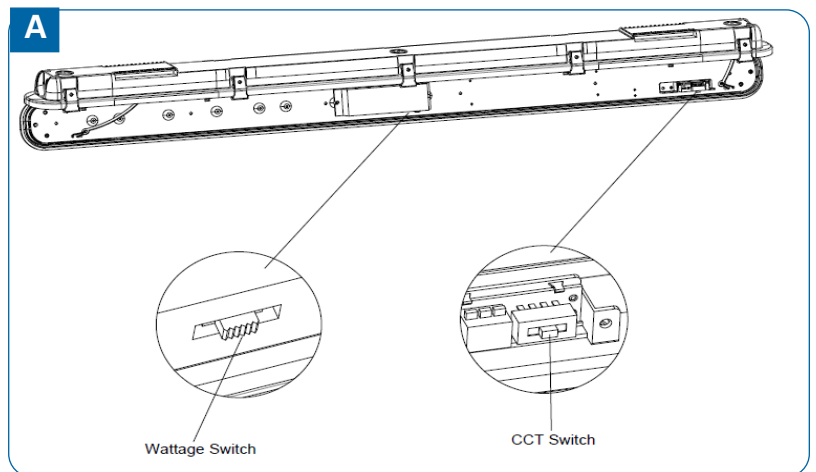

## LED Lumen & CCT Selectable Vaportight

Instruction Number: P-INT-X-467

Product Series: VTSS1

### Wiring Instructions

- 1 Turn off power supply before installation. Review product label for voltage and amperage load per fixture and use minimum 90°C supply wires.
- 2 Open fixture by releasing lens latches (10x) on each side of the fixture (See Fig. 1)
- 3 Make all electrical connections per NEC and local codes. For dimming wires, use class 1 wiring methods. Cap each dimming wires separately if not used. See wiring diagram on page 1.
- 4 Place lens cover assembly onto housing assembly. Making sure no wires are pinched and lens is properly inserted in housing gasket channel.
- 5 Position lens latches over the lens groove (See Fig. 1)
- 6 Fasten lens latches (10x) and verify each are locked in place.
- 7 Hang fixture per standard installation instructions and restore power and test fixture.

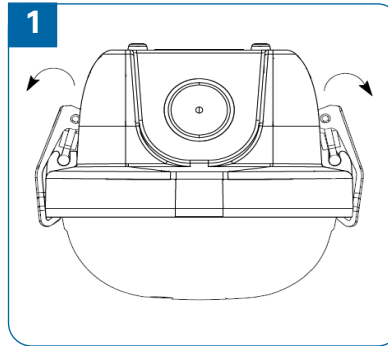

### Surface Mounting Installation

**Note:** Surface mount bracket comes standard with fixture and ships with hardware in a separate bag.

- 1 Turn off power.
- 2 Locate and predrill holes 33" apart into mounting surface and set anchor for mounting brackets (See Fig. 1a)
- 3 Mount the surface mount brackets with two screws and screw anchors (provided).
- 4 Push fixture into each mounting bracket. Confirm positive click engagement (See Fig. 2a).
- 5 Make all electrical connections per NEC and local codes.
- 6 Restore power to fixture and test.

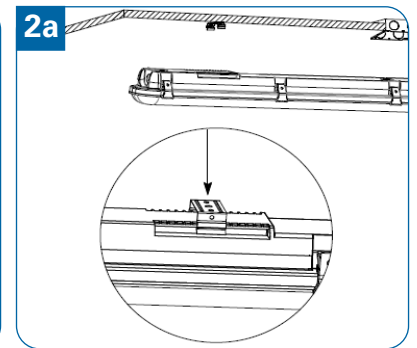
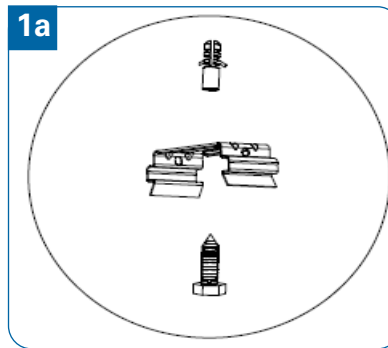

### Suspended Mounting Installation

**Note:** V bracket comes standard with fixture, attaches to surface mount brackets, and ships with hardware in a separate bag.

- 1 Turn off power.
- 2 Insert V brackets into surface mounting brackets holes ( See Fig. 1b).
- 3 Push fixture into each mounting bracket. Confirm positive click engagement.
- 4 Hang fixture to chain or cable (not provided).
- 5 Make all electrical connections per NEC and local codes.
- 6 Restore power to fixture and test.

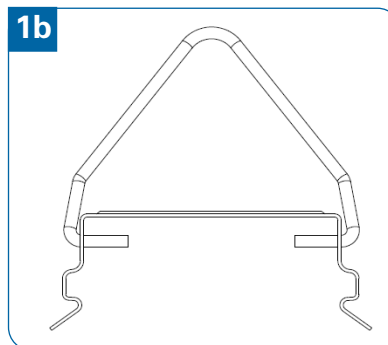

## LED Lumen & CCT Selectable Vaportight

Instruction Number: P-INT-X-467

Product Series: VTSS1

### Emergency Battery Back Up Information

**Note:** Emergency mode CCT is only 4000K or 5000K. See page 1 for CCT selection diagram and chart.

**Caution:** Battery is rechargeable LiFePO<sub>4</sub> type and must be recycled or disposed of properly.

- An un-switched AC power source of 100V AC to 277V AC must be connected to this emergency backup driver to allow battery to charge when AC power is available.
- Do not join the Battery Connector until installation is complete and AC power is supplied to the emergency backup driver (see Fig. 1c).
- During normal AC operation, the charging indicator is illuminated, and the battery is being charged. When power fails, the emergency LED driver automatically switches to emergency power (internal battery), operating the LED load for a minimum of 90 minutes. When AC power is restored, the emergency driver returns to the charging mode.
- Test switch can be located on the fixture shown in Fig. 2c

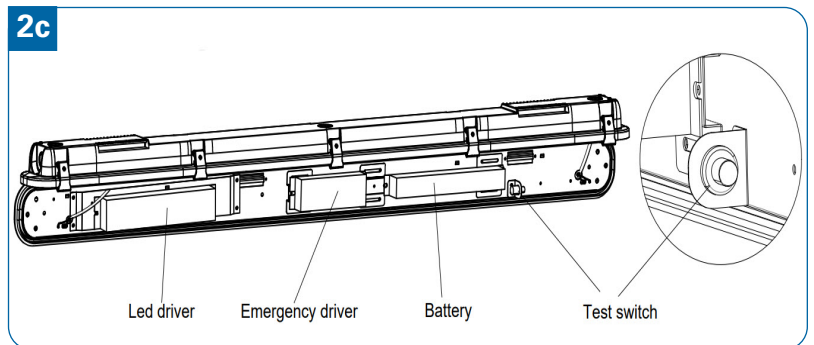
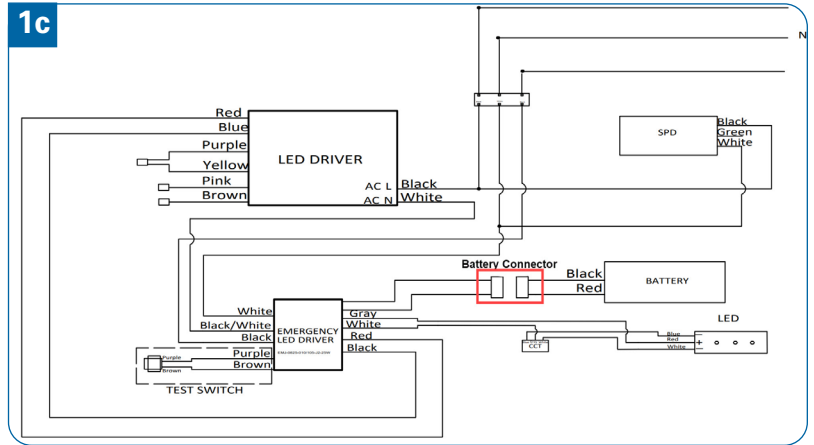

## LED Lumen & CCT Selectable Vaportight

Instruction Number: P-INT-X-467.1

Product Series: VTSS1

Use this instruction to install the sensor for the VTSS1 fixture in the field.

### Components

- 1 VTSS1 Fixture
- 2 VTSS-VMW (Kit Includes: Sensor, Wire harness, wire connector)

### Tools Required for Installation

- Cordless Drill
- Philips Screwdriver and Flat Head Screwdriver
- Wirestripper/cutter
- Wire nuts

### WARNING!



1. Field installers are responsible for recognizing specific site requirements and making adjustment to assure a complete, functional installation.
2. Electrical connections must be made by a qualified electrician and in accordance with NEC and local codes.
3. Make all power connections using UL listed components.
4. Make sure the supply voltage is the same as the rated voltage of the luminaire.
5. Proper grounding is required to ensure safety.
6. Please wear gloves to avoid injury before installation.
7. Check if there is any damage during shipping. If so, contact manufacturer immediately.
8. Read the installation instruction carefully to check whether all the accessories are included. After confirmation, then install the fixture according to installation steps.
9. Appropriate safety equipment needed during installation, to be determined by installer and per applicable safety standards and precautions.
10. Risk of fire or electrical shock. DO NOT cover fixture with insulation or similar material.
11. DO NOT install on unstable or easily breakable surface.

### Sensor Wiring Diagram

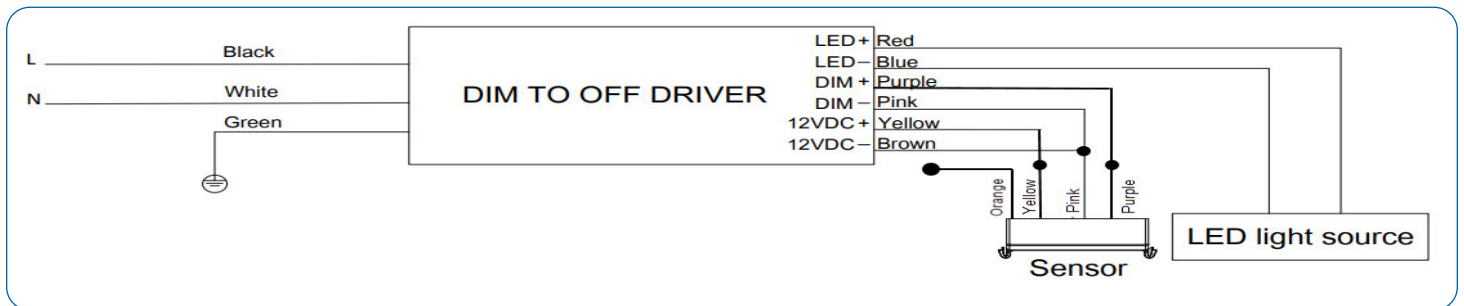

LED Lumen & CCT Selectable Vaportight

Instruction Number: P-INT-X-467.1

Product Series: VTSS1

Internal Motion Sensor Installation

**Note:** These instructions are for an uninstalled fixture. If fixture is already installed, turn off power and remove from installation completely.

- 1 Release each lens latch (10x) on each side of the fixture (See Fig. 1).
- 2 Open the fixture by releasing the lens latches and place lens face down on work surface.
- 3 Remove sensor cover plate from LED metal tray (See Fig. 2)
- 4 Connect the wire harness flat connector to the sensor terminal.
- 5 Connect wires to LED Driver wire connectors per wiring diagram and NEC and local codes (See wiring diagram on previous page).
- 6 Connect wire connector (provided) to unused Orange wire (See wiring diagram on previous page).
- 7 Snap the sensor module to LED tray (See Fig. 3).
- 8 Place lens cover onto housing assembly making sure no wires are pinched and lens is properly inserted into housing gasket channel (See Fig. 4).
- 9 Position lens latches over lens groove and fasten lens latches (10x) and verify each are locked in place.
- 10 Hang fixture per standard installation instructions and restore power and test fixture.

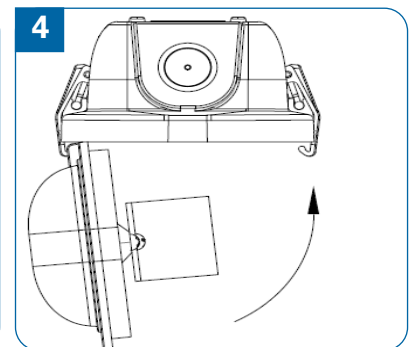
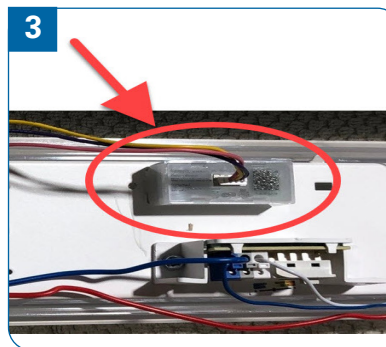
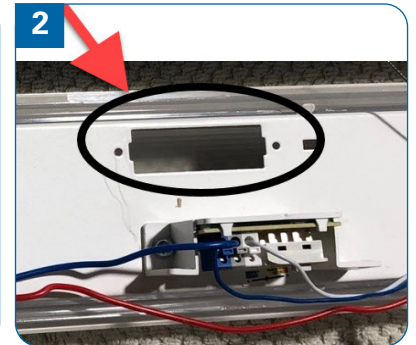
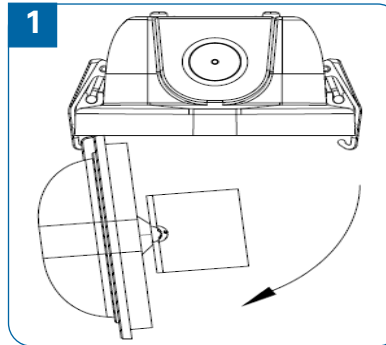

Sensor Factory Default Settings:	
Trim Level	100%
Sensitivity	HIGH
Hold Time	5 min.
Standby Dim	30%
Standby Time	60 min.
Photocell	OFF

**Note:** For additional commissioning of the sensor, order RM51 remote separately