

## Troffer Selectable, Gen 4

Instruction Number: P-INT-X-484

Product Series: TritonPro™ LTHES4

Use this instruction to install the LTHES4.

### Components

- 1 LTHES4 Fixture

### Tools Required for Installation

- Cordless drill or Philips Screwdriver and Flat Head Screwdriver
- Wire cutter/stripper



### WARNING!

Risk of fire or electric shock. To reduce risk of electrical shock, turn off power supply before installation or servicing.

1. This product should be installed, inspected, and maintained by a qualified electrician only, in accordance with local building codes with the NEC (National Electric Code) and all local codes.
2. Use only UL (or other NRTL) approved wire for input/output connections.
3. Minimum 90°C supply conductors.
4. Make sure LEDs and drivers are cool to touch when performing maintenance.
5. Make sure the supply voltage is the same as the rated voltage of the luminaire.
6. Wear gloves and safety goggles at all times when removing luminaires from carton, installing, servicing or performing maintenance.
7. Avoid direct eye exposure to the illuminated light source.
8. Put aside small parts and dispose packing material properly.
9. To avoid hazards and unnecessary failures due to misuse, please read carefully all warnings and instructions included and all labels.
10. Green ground screw provided in proper location. Do not relocate.
11. Suitable for Damp location, Type IC.
12. Always check the product before installation. Do not install damaged product.

### Standard Wiring Diagram

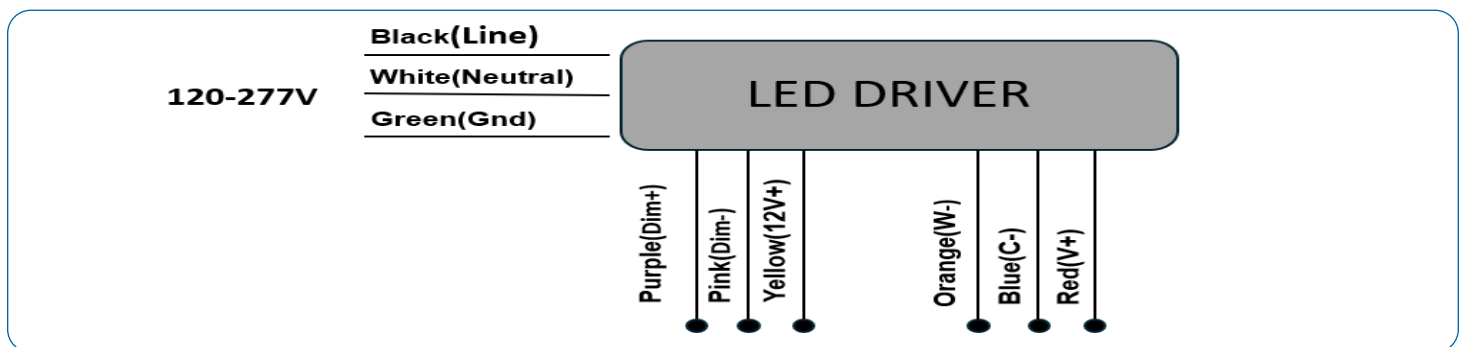

**FCC Statement:** Any changes or modifications to this unit not expressly approved by the party responsible for compliance could void the user's authority to operate the equipment.

**NOTE:** This equipment has been tested and found to comply with the limits for a Class A digital device, pursuant to part 15 of the FCC Rules. These limits are designed to provide reasonable protection against harmful interference when the equipment is operated in a commercial environment. This equipment generates, uses, and can radiate radio frequency energy and, if not installed and used in accordance with the instruction manual, may cause harmful interference to radio communications. Operation of this equipment in a residential area is likely to cause harmful interference in which case the user will be required to correct the interference at his own expense.

## Troffer Selectable, Gen 4

Instruction Number: P-INT-X-484

Product Series: TritonPro™ LTHES4

### Step-by-Step Instructions

- 1 Remove the fixture from packaging.
- 2 Turn off power supply from main circuit breaker.
- 3 Confirm size of fixture to size of ceiling panel. Confirm ceiling supports the weight of the fixture. Replace existing light fixture with the LTHES4. The fixture must be fully recessed in the channels. Space for adjustment cannot be more than 1/8" or fixture will fall (See Fig. 3).
- 4 Bend security tabs 90° on each corner of the fixture so they stand securely over the T-Bar grid (See Fig. 2).
- 5 Remove driver cover and secure conduit with incoming power supply. (See Fig. 3)
- 6 Make electrical connections per NEC and local codes. Insert the wires and secure the driver cover (Note: Do not pinch wires). (See Fig. 4)
- 7 Restore power and test fixture.

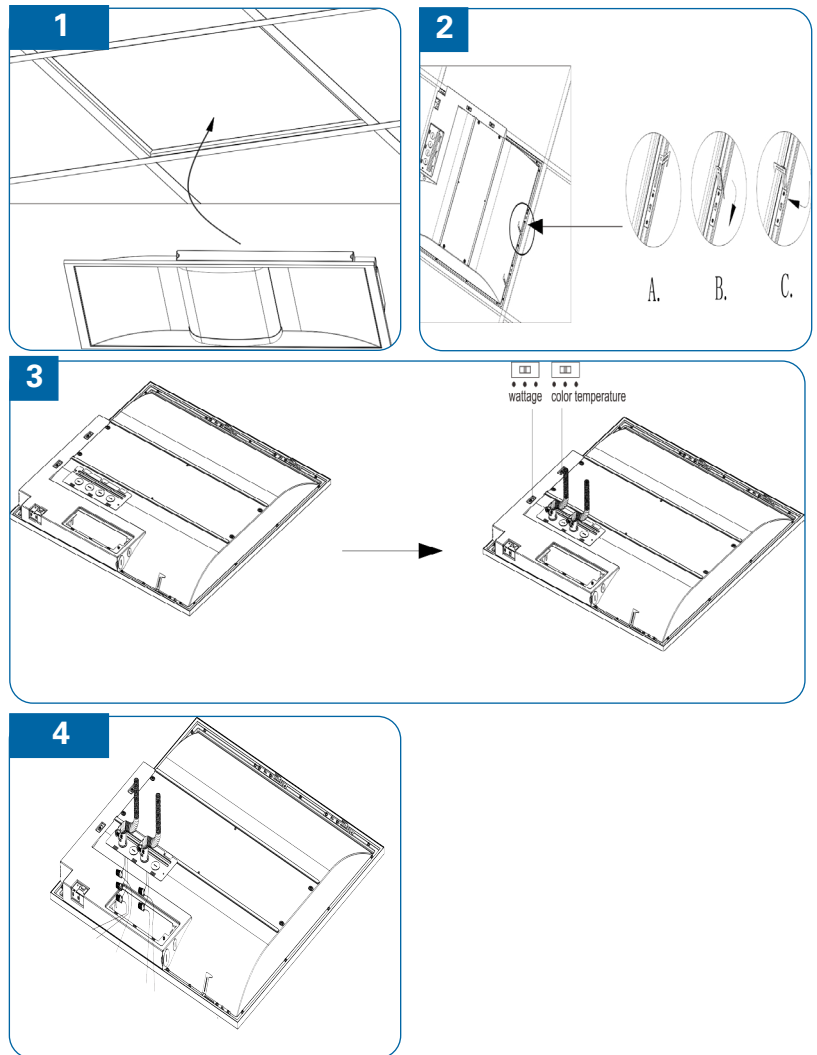

### Field Adjustable Wattage and CCT

End users can adjust the color temperature and lumen output to the desired level by using the two dip switches located on the back of the driver channel. Each switch offers three options (3 lumen outputs and 3 color temperatures). See below for configurations and Fig. 1a for switch locations.

CCT Adjustment	3500K	4000K	5000K	
Wattage Adjustment	Fixture Size	Lumen Code	Wattage	Lumen Output
	1' x 4'	A1	18w	2200lm
			26w	3300lm
			35w	4400lm
	2' x 2'	A1	18w	2200lm
			26w	3300lm
			35w	4400lm
	2' x 4'	B1	26w	3300lm
			35w	4400lm
			44	5500lm

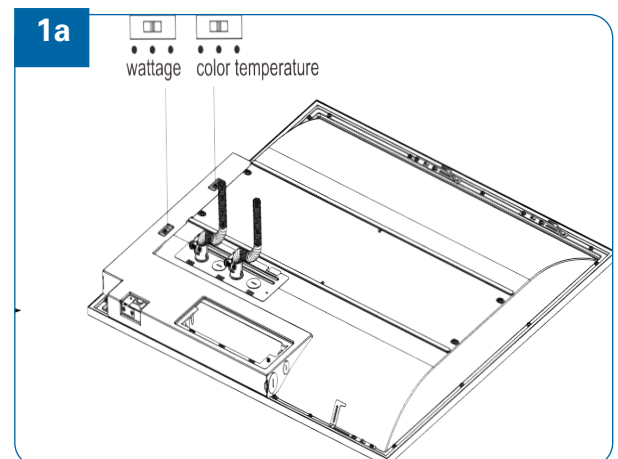

## Troffer Selectable, Gen 4

Instruction Number: P-INT-X-484

Product Series: TritonPro™ LTHES4

Use this instruction to install the battery back up kit on the LTHES4 in the field.

### Components

- 1 LTHES4 Fixture
- 2 LTHES4-BB08-KIT (battery back up)



### Tools Required for Installation

- Cordless drill or Philips Screwdriver and Flat Head Screwdriver
- Wire cutter/stripper
- Battery back up mounting hardware



### WARNING!

Risk of fire or electric shock. To reduce risk of electrical shock, turn off power supply before installation or servicing.

1. This product should be installed, inspected, and maintained by a qualified electrician only, in accordance with local building codes with the NEC (National Electric Code) and all local codes.
2. Use only UL (or other NRTL) approved wire for input/output connections.
3. Minimum 90°C supply conductors.
4. Make sure LEDs and drivers are cool to touch when performing maintenance.
5. Make sure the supply voltage is the same as the rated voltage of the luminaire.
6. Connections should be capped with UL approved wire connectors.
7. Wear gloves and safety goggles at all times when removing luminaires from carton, installing, servicing or performing maintenance.
8. Avoid direct eye exposure to the illuminated light source.
9. Put aside small parts and dispose packing material properly.
10. To avoid hazards and unnecessary failures due to misuse, please read carefully all warnings and instructions included and all labels.
11. Green ground screw provided in proper location. Do not relocate.
12. Suitable for Damp location, Type IC.
13. Always check the product before installation. Do not install damaged product.

### Battery Back Up Wiring Diagram

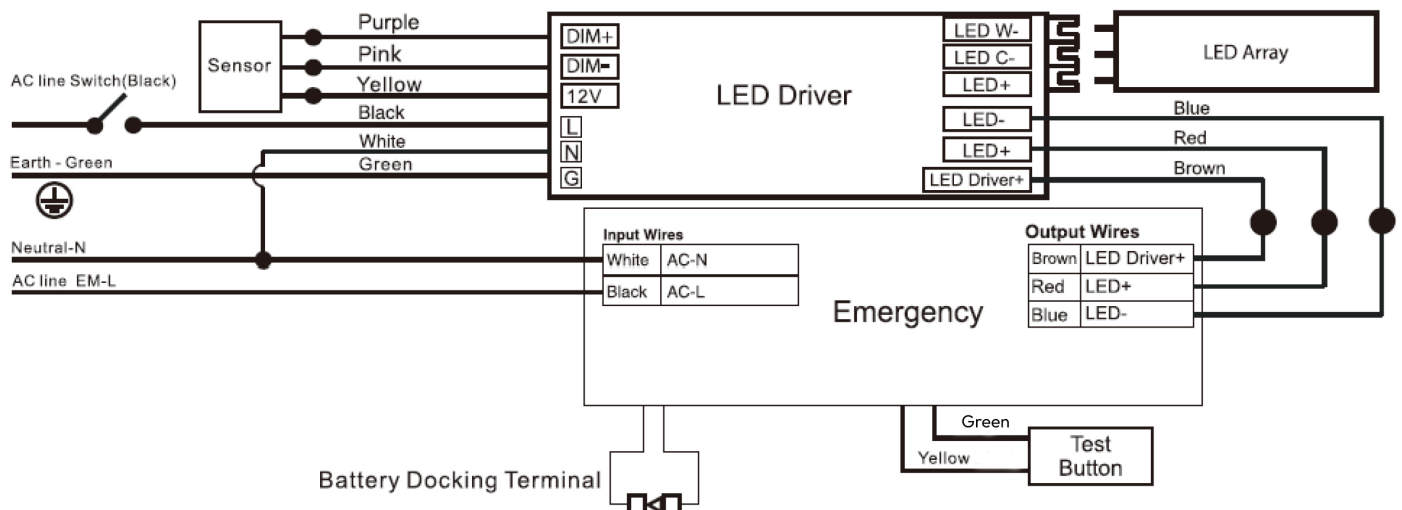

## Troffer Selectable, Gen 4

Instruction Number: P-INT-X-484

Product Series: TritonPro™ LTHES4

### Step-by-Step Instructions

**Note:** See standard instructions for CCT selection and chart.

- 1 Remove the fixture from packaging.
- 2 Turn off power supply from main circuit breaker.
- 3 Remove the driver cover and connect conduit to driver box/cover (See Fig. 1b).
- 4 Fasten emergency driver to the edge of the fixture by using (2) supplied screws.
- 5 Make electrical connections per NEC and local codes.
- 6 Connect test switch, run ribbon cable under driver cover.
- 7 Connect battery docking terminal.
- 8 Secure the drive cover to the fixture (See Fig. 2b, Fig. 3b and wiring diagram on Page 3).
- 9 Attach the test switch to the room facing side of the fixture.
- 10 Restore power and test the switch to confirm normal function of the battery back up (See Fig. 4b).

