

Troffer Retrofit Selectable, Gen 4

Instruction Number: P-INT-X-254

Product Series: TritonPro™ LDRES4

Use this instruction to convert a fluorescent recessed troffer to LED

Components

- 1 LDRES4 Fixture
- 2 Side Mounting Brackets and Trim Pieces

Tools Required for Installation

- Cordless drill or Philips Screwdriver and Flat Head Screwdriver
- Wire cutter/stripper



WARNING! Risk of fire or electric shock. Luminaire wiring and electrical parts may be damaged when drilling for installation of LED retrofit kit. Check for enclosed wiring and components.

WARNING! Risk of fire or electric shock. LED Retrofit Kit installation requires knowledge of luminaires electrical systems. If not qualified, do not attempt installation contact a qualified electrician.

WARNING! Risk of fire or electric shock. Install this kit only in the luminaires that have the constructions features and dimensions shown in the photographs and/or drawings and where the input rating of the retrofit kit does not exceed the input rating of the luminaire.

WARNING! To prevent wiring damage or abrasion, do not expose wiring to edges of sheet metal or other sharp objects.

WARNING! Do not make or alter any open holes in an enclosure of wiring or electrical components during kit installation.

CAUTION! Risk of fire. Consult a qualified electrician to ensure correct branch circuit conductor.

THIS PRODUCT MUST BE INSTALLED IN ACCORDANCE WITH THE APPLICABLE INSTALLATION CODE BY A PERSON FAMILIAR WITH THE CONSTRUCTION AND OPERATION OF THE PRODUCT AND THE HAZARDS INVOLVED. THE RETROFIT ASSEMBLY IS ACCEPTED AS A COMPONENT OF A LUMINAIRE WHERE THE SUITABILITY OF THE COMBINATION SHALL BE DETERMINED BY UL OR AUTHORITIES HAVING JURISDICTION. LUMINAIRE HOUSING BEING RETROFITTED MUST BE METAL IN ORDER TO PROVIDE APPROPRIATE PATH FOR BONDING.

1. Field installers are responsible for recognizing specific site requirements and making adjustments to assure a complete, functional installation.
2. Make all power connections using UL listed components.
3. Electrical connections must be made by a qualified electrician and in accordance with NEC and local codes.

Standard Wiring Diagram

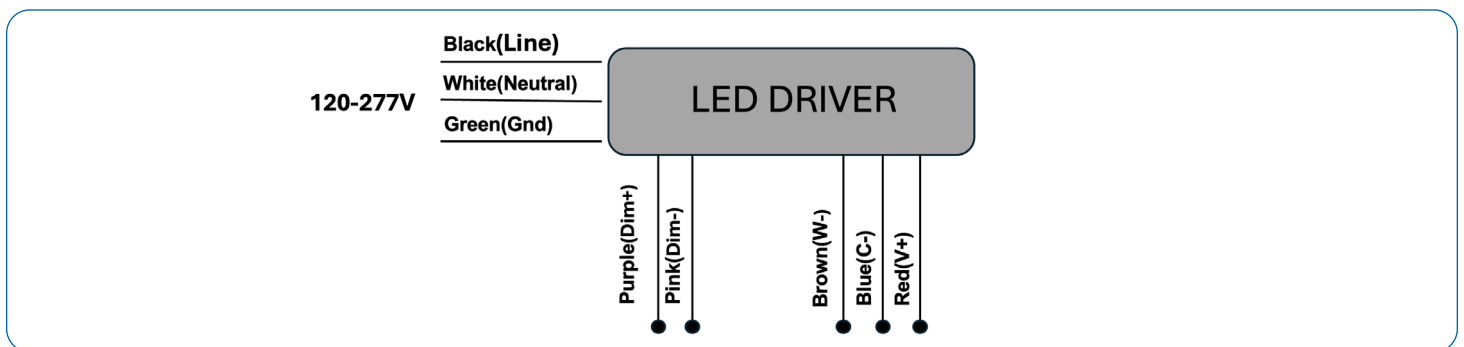

FCC Statement: Any changes or modifications to this unit not expressly approved by the party responsible for compliance could void the user's authority to operate the equipment.

NOTE: This equipment has been tested and found to comply with the limits for a Class A digital device, pursuant to part 15 of the FCC Rules. These limits are designed to provide reasonable protection against harmful interference when the equipment is operated in a commercial environment. This equipment generates, uses, and can radiate radio frequency energy and, if not installed and used in accordance with the instruction manual, may cause harmful interference to radio communications. Operation of this equipment in a residential area is likely to cause harmful interference in which case the user will be required to correct the interference at his own expense.

Troffer Retrofit Selectable, Gen 4

Instruction Number: P-INT-X-254

Product Series: TritonPro™ LDRES4

Step-by-Step Instructions

- 1 Remove the fixture from packaging.
- 2 Turn off power supply from main circuit breaker.
- 3 Remove existing door frame (if installed) and lamps. If clearance permits, abandon ballast and socket bars inside the existing fixture. Otherwise remove these as needed. Dispose of lamps, door frame, and ballast properly (See Fig. 1).
- 4 Use screws to attach the 2 brackets to the ends of the existing fixture housing (See Fig. 2).
- 5 Place the 2 trim strips between the existing housing and the T-Bar grid (See Fig. 3).
- 6 Lift the new troffer kit and slide into the 2 bracket keyhole slots that were attached in Step 4 (See Fig. 4).
- 7 Attach the safety tether and complete wiring per NEC and local codes (see wiring diagram on page 1).
- 8 Adjust the CCT and Wattage switches to desired output (reference Field Adjustable Wattage and CCT instructions below).
- 9 Close the retrofit kit and secure the latches (See Fig. 5).
- 10 Restore power and test fixture.

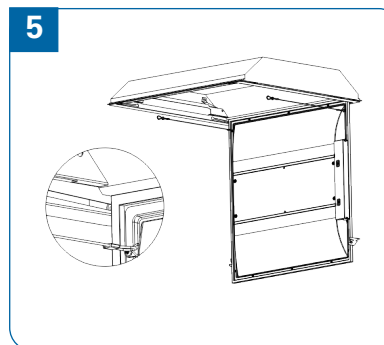
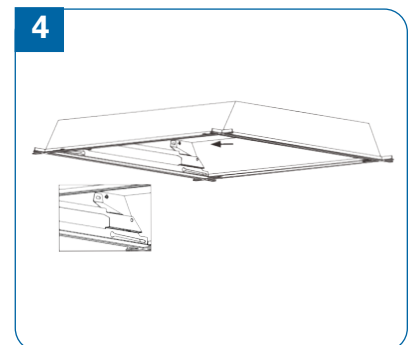
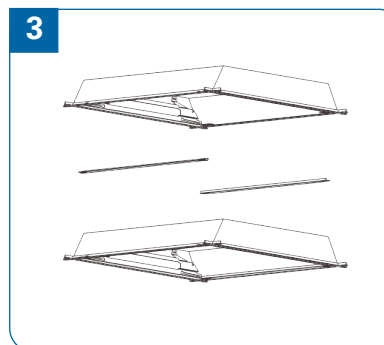
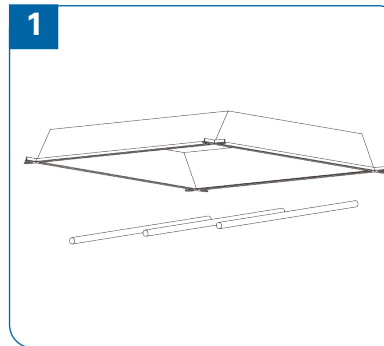

Field Adjustable Wattage and CCT

End users can adjust the color temperature and lumen output to the desired level by using the two dip switches located on the back of the driver.

CCT Adjustment	3500K	4000K	5000K	
	Fixture Size	Lumen Code	Wattage	Lumen Output
Wattage Adjustment	1' x 4'	A1	18w	2200lm
			26w	3300lm
			35w	4400lm
	2' x 2'	A1	18w	2200lm
			26w	3300lm
			35w	4400lm
	2' x 4'	B1	26w	3300lm
			35w	4400lm
			44w	5500lm

