

Flat Panel Backlit Selectable, Gen 1

Instruction Number: P-INT-X-478

Product Series: FPBS1

Use this instruction to install the FPBS1.

Components

- 1 FPBS1 Fixture

Tools Required for Installation

- Cordless drill or Philips Screwdriver and Flat Head Screwdriver
- Wire cutter/stripper



WARNING!

Risk of fire or electric shock. To reduce risk of electrical shock, turn off power supply before installation or servicing.

1. This product should be installed, inspected, and maintained by a qualified electrician only, in accordance with local building codes with the NEC (National Electric Code) and all local codes.
2. Use only UL (or other NRTL) approved wire for input/output connections.
3. Minimum 90°C supply conductors.
4. Make sure LEDs and drivers are cool to touch when performing maintenance.
5. Make sure the supply voltage is the same as the rated voltage of the luminaire.
6. Connections should capped with UL approved wire connectors.
7. Wear gloves and safety goggles at all times when removing luminaires from carton, installing, servicing or performing maintenance.
8. Avoid direct eye exposure to the illuminated light source.
9. Put aside small parts and dispose packing material properly.
10. To avoid hazards and unnecessary failures due to misuse, please read carefully all warnings and instructions included and all labels.
11. Green ground screw provided in proper location. Do not relocate.
12. Suitable for Damp location, Type IC.
13. Always check the product before installation. Do not install damaged product.

Standard Wiring Diagram

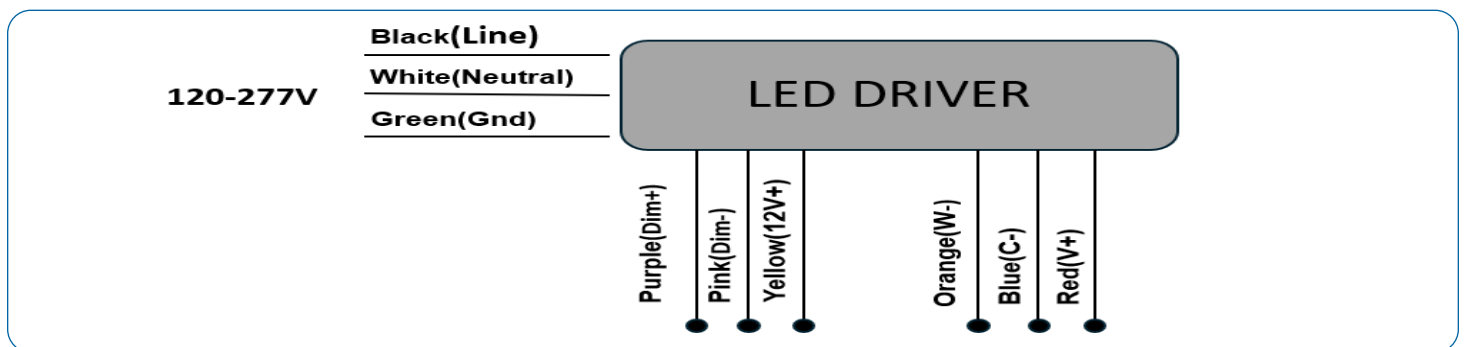

FCC Statement: Any changes or modifications to this unit not expressly approved by the party responsible for compliance could void the user's authority to operate the equipment.

NOTE: This equipment has been tested and found to comply with the limits for a Class A digital device, pursuant to part 15 of the FCC Rules. These limits are designed to provide reasonable protection against harmful interference when the equipment is operated in a commercial environment. This equipment generates, uses, and can radiate radio frequency energy and, if not installed and used in accordance with the instruction manual, may cause harmful interference to radio communications. Operation of this equipment in a residential area is likely to cause harmful interference in which case the user will be required to correct the interference at his own expense.

Flat Panel Backlit Selectable, Gen 1

Instruction Number: P-INT-X-478

Product Series: FPBS1

Step-by-Step Instructions

- 1 Remove the fixture from packaging.
- 2 Turn off power supply from main circuit breaker.
- 3 Unscrew driver covers and connect conduit to driver box. (See Fig. 1)
- 4 Connect coordinating wires. Secure driver covers to fixture. (See Fig. 2)
- 5 Confirm size of fixture to size of ceiling panel. Confirm ceiling can support weight of fixture. Replace existing light fixture with FPBS1. The fixture must be fully recessed into the channel. Space for adjustment cannot be more than 1/8", or fixture will fall. (see Fig. 3)
- 6 Use protective brackets for safety. (See Fig. 4)
- 7 Restore power and test fixture.

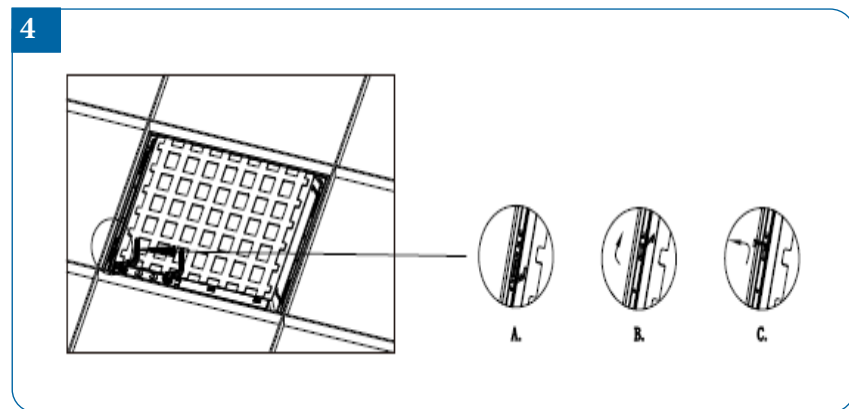
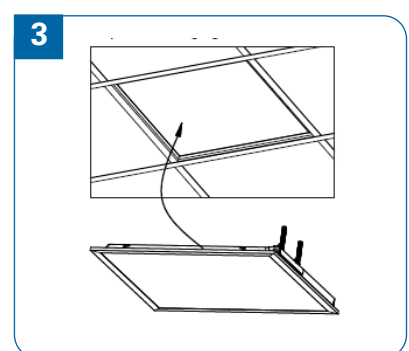
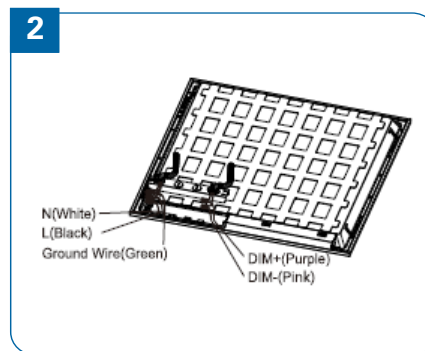
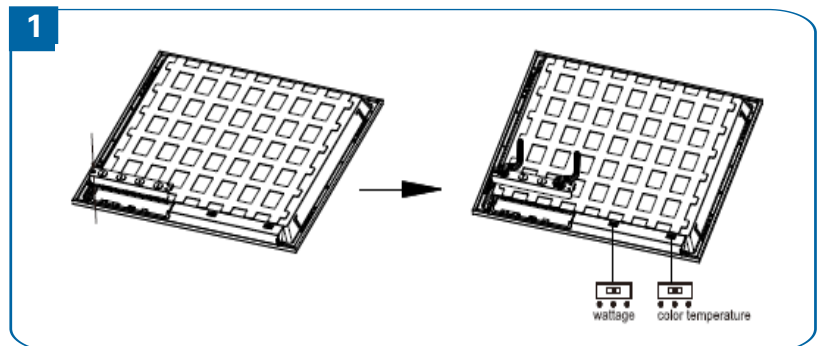

Field Adjustable Wattage and CCT

End users can adjust the color temperature and lumen output to the desired level by using the two dip switches located on the back of the driver. Each switch offers three options (3 lumen outputs and 3 color temperatures). See below for configurations and Fig. 5 for switch locations.

CTT	3500K	4000K	5000K
-----	-------	-------	-------

Size	Lumen Output		
1x4	2500	3750	5000
2x4	2500	3750	5000
2x4	3750	5000	6250

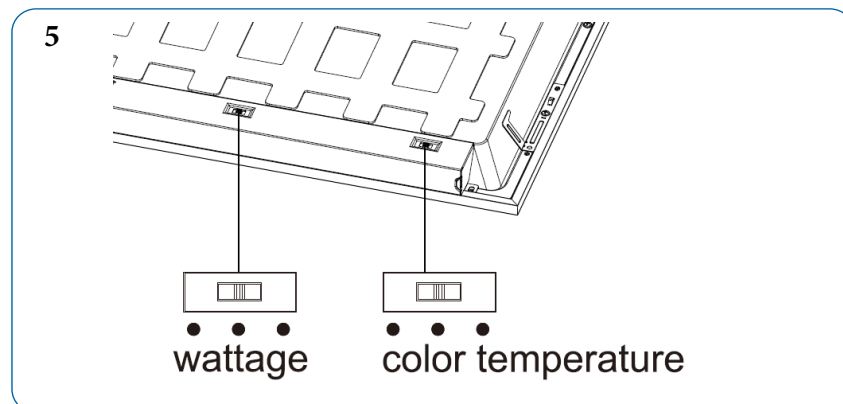

Flat Panel Backlit Selectable, Gen 1 Battery Back Up Installation

Instruction Number: P-INT-X-478.1

Product Series: FPBS1

Use this instruction to install a battery back up on an FPBS1 fixture.

FPBS1-BB08-KIT Components

- 1 WSD-EML08W27-XXX (1)
- 2 Junction Box Extender (1)
- 3 Ribbon Cable Style Battery Back Up Test Button (1)
- 4 Mounting Bars (x2)
- 5 Mounting Screws (x4)
- 6 Wire Nuts (x8)



Tools Required for Installation

- Cordless drill or Philips Screwdriver and Flat Head Screwdriver
- Wire cutter/stripper



WARNING! Risk of fire or electric shock. Luminaire wiring and electrical parts may be damaged when drilling for installation of LED retrofit kit. Check for enclosed wiring and components.
WARNING! Risk of fire or electric shock. LED Retrofit Kit installation requires knowledge of luminares electrical systems. If not qualified, do not attempt installation contact a qualified electrician.

- Before installing make certain the AC power to the fixture is off
- The electrical rating of this product is 100-347V ac, installer must confirm that there is 100-347V ac to the fixture before installation. To prevent electrical shock only mate unit connector after installation is complete and before the AC power to the fixture is back on. This LED emergency backup unit requires an un-switched AC power source of 100-347V ac
- Do not mount near gas or electric heaters
- Do not use outdoors
- The emergency LED driver is for use with grounded UL Listed LED luminaires
- Verify that all replacement lamp types marked on the installed luminaire are also identified as suitable for use with this emergency battery pack
- Equipment should be mounted in locations and at heights where it is subjected as suitable for use with this emergency battery pack
- Equipment should be mounted in locations and at heights where it is not be subjected to tampering by unauthorized personnel. The use of accessory equipment not recommended by the manufacturer and may cause an unsafe condition. Do not use this equipment for other than its intended use
- Use with grounded, UL Listed, dry or lamp location rated fixtures

Wiring Diagram

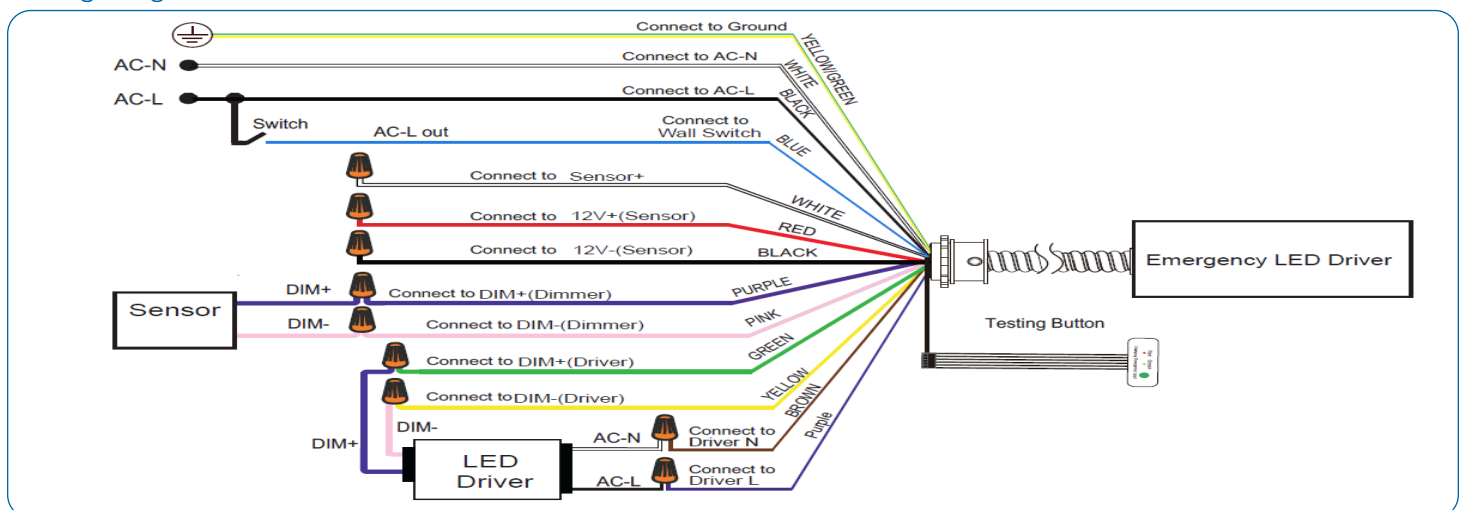

FCC Statement: Any changes or modifications to this unit not expressly approved by the party responsible for compliance could void the user's authority to operate the equipment.

NOTE: This equipment has been tested and found to comply with the limits for a Class A digital device, pursuant to part 15 of the FCC Rules. These limits are designed to provide reasonable protection against harmful interference when the equipment is operated in a commercial environment. This equipment generates, uses, and can radiate radio frequency energy and, if not installed and used in accordance with the instruction manual, may cause harmful interference to radio communications. Operation of this equipment in a residential area is likely to cause harmful interference in which case the user will be required to correct the interference at his own expense.

Flat Panel Backlit Selectable, Gen 1 Battery Back Up Installation

Instruction Number: P-INT-X-478.1

Product Series: FPBS1

NOTE

1. IN EMERGENCY MODE, DOUBLE-CLICK THE TEST SWITCH TO TURN OFF THE CURRENT EMERGENCY STATE.
2. TEST ACCESSORY LEADS-OBSERVE PROPER POLARITY WIRING.
3. EMERGENCY MODE OPERATES ONLY AT 5000K/CCT.

Operation

AC power is present, the LED load from the LED driver is normal power supply, AC LED driver output current can not exceed 4A, the emergency driver is charging in a standby mode. The green LED light flashing indicates that it is charging. The green LED light on indicates that it is full charged.

Emergency Operation

When the AC power goes out, the emergency driver detects the AC power outage and automatically switches to the emergency mode.

Self-Testing









This emergency driver is UL listed and is equipped with self-testing functionality.

Initial Self-Test After Installation

It will perform a functional test for 3 seconds after the driver is installed and then perform a second test in 120 minutes to check the wiring and battery output. The indicator will be off or flicker in case of a failure or a an error.

Monthly Self-Test

It will automatically perform a test every 30 seconds for 3 seconds,diagnosing wiring,and battery output. If the indicator LED is blinking or off,signifies there is a failure.

Indicator light introduction	 Green Flashing ① Charging  Green ON ② Full-charged  Red ON ③ Discharging(emergency mode)  Red Flashing ④ Discharging(emergency mode) finished soon  Yellow ON ⑤ Error
① Green/flashing: Charging ② Green/on: Full-charged ③ Red/on: Discharging(emergency mode) ④ Red/flashing: Discharging(emergency mode) finished soon ⑤ a: Yellow/on: Error (Test Plate) b: Red and green /flicker : Error (Skinny Test Button)	
Test switch introduction	  →  Press the test switch Green turns Red Emergency function is normal ✓
① Press the test switch to confirm whether the emergency function is normal ② In emergency mode, double-click the test switch to turn off the current emergency state	

Flat Panel Backlit Selectable, Gen 1 Battery Back Up Installation

Instruction Number: P-INT-X-478.1

Product Series: FPBS1

Step-by-Step Instructions

- 1 Turn off power supply from main circuit breaker.
- 2 Remove and discard existing junction box cover. Keep screw for future step. (See Fig. 1)
- 3 Attach supplied brackets to the existing T-Bar. (See Fig. 2)
- 4 Fasten emergency driver to the brackets from step 3 with self drilling screws. (See Fig. 3)
- 5 Connect whip from emergency driver to the junction box extender. Re-use screw from step 2 to attach the junction box extender to the fixture. (See Fig. 4 and 5)
- 6 Make electrical connections per NEC and local codes. Reference the wiring diagram on page 1. Connect the emergency test switch to the emergency driver and route ribbon cable under the junction box extender. (See Fig. 6)
- 7 Attach the test switch to the front frame of the fixture or T-Bar. (See Fig. 7)
- 8 Restore power and test the switch to confirm normal function of the fixture and battery.

