

VTON2

Applications

Orion Energy Systems VTON2 product is NSF/ANSI Standard 2. Durable, versatile fixture suitable for demanding environments that require a watertight seal such as food-processing facilities, milking parlor, wash down applications and cooler/freezer environments.

Project Name:	
Catalog Number:	
Type:	
Note:	
Date:	



VTON2410LUNVFD850LAFGHWSSSZCSP



Construction

- Offered in both 4' and 8' lengths
- Durable, lightweight, white UL 5VA reinforced fiberglass body
- Stainless steel 316 marine grade latches are standard, stainless steel mounting brackets included with fixture purchase
- Acrylic, impact resistant, linear ribbed frosted lens
- Various lumen outputs to meet required light levels

Additional Options

- Cold Temperature option
- Factory installed Battery Back Up available in 10w or 20w, Certified in CA Title 20

Electrical

- Available in 120v-277v, 347v, and 480v
- Factory wired for full dimming (0-10v) or ON/OFF applications
- 20kA/10kV surge protection available
- Power Factor > .90*
- Total Harmonic Distortion < 20%*

*Note: Varies based on option

Lumen Maintenance

See lumen maintenance table on page 2

Fixture Certification & Listings

- [NSF/ANSI Standard 2](#)
- UL/cUL Listed for Wet Locations
- UL 5VA (f1) fiberglass housing
- IP67
- NEMA 4X Housing
- High pressure washdown up to 1500 PSI
- DesignLights Consortium™ Standard qualified luminaire
- Visit the [DLC QPL](#) for listed models

Warranty

See Orion's [Product Limited Warranty](#) for more details and information

Performance Information 277v, ≥80 CRI, 5000K¹

Nominal Lumen Code	Actual Lumens	Wattage	LPW	Total Input Current
4'				
03L	3,193lm	21w	150	0.09A
06L	6,733lm	41w	165	0.16A
10L	10,495lm	66w	160	0.24A
14L	13,936lm	89w	157	0.33A
8'				
09L	8,828lm	58w	151	0.22A
15L	15,130lm	92w	164	0.35A
20L	20,783lm	131w	159	0.49A

Lumen Maintenance²

Fixture Size	Nominal Lumen Code	Nominal Lumens	Operating Temperature	Calculated Lumen Maintenance		
				L70	L80	L90
4'	03L	3,000	25°C	197,000	124,000	59,000
			55°C	149,000	93,000	44,000
4'	06L	6,000	25°C	197,000	124,000	59,000
			55°C	149,000	93,000	44,000
4'	10L	10,000	25°C	197,000	124,000	59,000
			55°C	149,000	93,000	44,000
4'	14L	14,000	25°C	197,000	124,000	59,000
			55°C	149,000	93,000	44,000
8'	09L	9,000	25°C	229,000	144,000	68,000
			55°C	157,000	98,000	46,000
8'	15L	15,000	25°C	229,000	144,000	68,000
			55°C	157,000	98,000	46,000
8'	20L	20,000	25°C	229,000	144,000	68,000
			55°C	157,000	98,000	46,000

Additional Specification Information

¹ Actual performance may vary by up to ±10% of values listed; facility factors and fixture options can affect performance values

² Calculated hours based on TM-21 projections and components used at the time of testing. Warranty is not associated with Calculated Lumen Maintenance

Physical Information

Fixture Size	Length	Width	Depth	Weight ³
4'	51.70"	6.77"	4.37"	15.10 lbs.
8'	100.00"	6.77"	4.37"	22.00 lbs

Ambient Operating Temperatures [Tested at 12" Surface Mounted Height]

Nominal Lumen Code	Fixture Size	120v-277v	347v/480v	120v-277v [-C Option]	347v/480v [-C Option]	With Battery Back Up
03L	4'	-20°C to 50°C [-4°F to 122°F]	-20°C to 55°C [-4°F to 131°F]	n/a	n/a	Min. Operating Temp. 0°C [32°F]
06L	4'	-20°C to 55°C [-4°F to 131°F]	-20°C to 55°C [-4°F to 131°F]	-40°C to 55°C [-40°F to 131°F]	-40°C to 55°C [-40°F to 131°F]	
10L	4'	-20°C to 45°C [-4°F to 113°F]	-20°C to 45°C [-4°F to 113°F]	-40°C to 45°C [-40°F to 113°F]	-40°C to 45°C [-40°F to 113°F]	
14L	4'	-20°C to 40°C [-4°F to 104°F]	-20°C to 40°C [-4°F to 104°F]	-40°C to 40°C [-40°F to 104°F]	-40°C to 40°C [-40°F to 104°F]	
09L	8'	-20°C to 55°C [-4°F to 131°F]	-20°C to 50°C [-4°F to 122°F]	-40°C to 55°C [-40°F to 131°F]	-40°C to 50°C [-40°F to 122°F]	
15L	8'	-20°C to 40°C [-4°F to 104°F]	-20°C to 40°C [-4°F to 104°F]	-40°C to 40°C [-40°F to 104°F]	-40°C to 40°C [-40°F to 104°F]	
20L	8'	-20°C to 50°C [-4°F to 122°F]	-20°C to 45°C [-4°F to 113°F]	-40°C to 50°C [-40°F to 122°F]	-40°C to 45°C [-40°F to 113°F]	

Certified by NSF Hangers [Factory Installed]

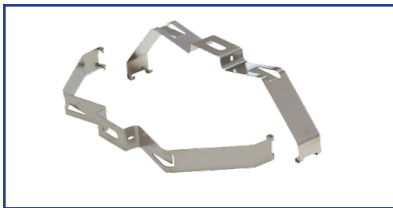

Surface Mounting Brackets
[Included with Fixture]

NSF Classification [NSF/ANSI Standard 170]

NSF Certification	Orion NSF Certified	USA Accredited Cert. Program Mark	Canada Accredited Cert. Program Mark	Equipment Location, Use & Explanation	Common Lighting Application
3.231.4	Yes-NSF2 [Non-Food Zone]	NSF® Certification Program is accredited by the American National Standards Institute.	NSF® Certification Program is accredited by the Standards Council of Canada.	Exposed equipment surfaces other than those in a food or splash zone.	Non-Food = Food preparation areas such as kitchens, food warehousing area may be damp.
3.231.7	Yes-NSF2 [Splash Zone]	NSF® Certification Program is accredited by the American National Standards Institute.	NSF® Certification Program is accredited by the Standards Council of Canada.	Equipment surfaces, other than those in a food zone, that are subject to splash, spillage, or other food soiling during operation of the equipment.	Splash Zone = Food processing areas where food may land on lighting fixture and pressure hose wash-downs are needed to clean area and lighting fixture. Area may be damp or wet.

Additional Specification Information

³ Weight will vary based on option selection

Ordering Information Example (NOTE: No dashes or spaces unless noted below)
VTON2410LUNVFD850LAFGHWSSSZCSP

Ordering Information (Enter Selected Catalog Number Below)

Series	Fixture Size	Nominal Lumen Code ⁴	Voltage	Driver Type	CRI; Color Temp	Lens Options	Power Connection	Latch Type	Additional Options	Special Certifications	Packaging
VTON2= ISON™ Vaportight Series Narrow Body, Gen 2	4= 4' 8= 8'	4' 03L= 3,000lm 06L= 6,000lm 10L= 10,000lm 14L= 14,000lm 8' 09L= 9,000lm 15L= 15,000lm 20L= 20,000lm	UNV= 120v-277v 347= 347v 480= 480v	FD= Full Dimming	840= 80CRI, 4000K 850= 80CRI, 5000K	LAFG= Lens Acrylic Frosted General 120°	HW= Hardwire [includes dimming leads] 06B= 6' Black Whip, no plug 11B= 11' Black Whip, no plug 06BD= 6' Black Whip, [includes dimming leads] no plug 11BD= 11' Black Whip, [includes dimming leads] no plug 07CE= 7' Hardwire Leads with Liquid Tight Conduit Elbow 07CED= 7' Hardwire Leads with Liquid Tight Conduit Elbow [includes dimming leads]	SS= Stainless Steel	[Blank]= No Options BB10= Battery Back Up, 10w ^{5,7} BB20= Battery Back Up, 20w ^{5,7} -C= Cold Temperature Environment [-40°C] ⁶ TS= 20kA/10kV Surge Protection	SZC= Splash Zone Certified	[blank]= Bulk Pack SP= Single Pack

Photometrics

Visit orionlighting.com to obtain all .IES files

VTON24 10L 840

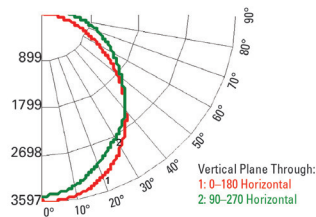

Additional Specification Information

⁴ For actual lumens, see performance table

⁵ Multiply 10w or 20w by the lumens per watt (LPW) of the fixture to calculate lumen output in emergency mode

⁶ Not available for **03L** option

⁷ Not available with Cold Temperature **-C** option