

ISON™ VAPORTIGHT NARROW BODY, GEN 2

VTON2

Applications

Durable, versatile high bay fixture suitable for demanding environments that require a watertight seal such as food-processing facilities, milking parlor, and wash down applications. This manufactured product meets the Build America, Buy America (BABA) requirement.



VTON2406LUNVFD850LAFGHWSPP-BABA

Project Name:	
Catalog Number:	
Type:	
Note:	
Date:	



IP67



Construction & Design

- This is a manufactured product in the United States that meets the 55% threshold for Build America Buy America (BABA) compliance
- Durable, lightweight, white UL 5VA reinforced fiberglass body
- Stainless steel 316 marine grade latches are standard, stainless steel mounting brackets included with fixture purchase
- Available in 4' and 8'
- Acrylic, impact resistant, linear ribbed frosted lens
- Various lumen outputs to meet required light levels

Additional Options

- Multiple mounting methods for compatibility in most environments (not BABA Compliant)
- Field installed Battery Back Up available in 10w, Certified in CA Title 20 (not BABA Compliant)

Electrical

- Available in 120v-277v, and 480v
- Hardwire and other power connection options available
- 6kV/3kA surge protection standard
- Power Factor > .90*
- Total Harmonic Distortion < 20%*

*Note: Varies based on option

Lumen Maintenance

See lumen maintenance table on page 2

Fixture Certification & Listings

- Build America Buy America Compliant
- UL/cUL Listed for Wet Locations
- UL 5VA (f1) fiberglass housing
- IP67
- High pressure washdown up to 1500 PSI
- NEMA 4X Housing
- DesignLights Consortium™ Standard qualified luminaire
- Visit the [DLC QPL](#) for listed models

Warranty

See Orion's [Product Limited Warranty](#) for more details and information

ISON™ VAPORTIGHT NARROW BODY, GEN 2

VT0N2

Performance Information 277v, ≥80 CRI, 5000K¹

Nominal Lumen Code	Actual Lumens	Wattage	LPW	Total Input Current
4'				
03L	3,193lm	21w	150	0.09A
06L	6,733lm	41w	165	0.16A
10L	10,495lm	66w	160	0.24A
14L	13,936lm	89w	157	0.33A
8'				
09L	8,828lm	58w	151	0.22A
15L	15,130lm	92w	164	0.35A
20L	20,783lm	131w	159	0.49A

Lumen Maintenance²

Fixture Size	Nominal Lumen Code	Nominal Lumens	Operating Temperature	Calculated Lumen Maintenance		
				L70	L80	L90
4'	03L	3,000	25°C	197,000	124,000	59,000
			55°C	149,000	93,000	44,000
4'	06L	6,000	25°C	197,000	124,000	59,000
			55°C	149,000	93,000	44,000
4'	10L	10,000	25°C	197,000	124,000	59,000
			55°C	149,000	93,000	44,000
4'	14L	14,000	25°C	197,000	124,000	59,000
			55°C	149,000	93,000	44,000
8'	09L	9,000	25°C	229,000	144,000	68,000
			55°C	157,000	98,000	46,000
8'	15L	15,000	25°C	229,000	144,000	68,000
			55°C	157,000	98,000	46,000
8'	20L	20,000	25°C	229,000	144,000	68,000
			55°C	157,000	98,000	46,000

Additional Specification Information

¹ Actual performance may vary by up to ±10% of values listed; facility factors and fixture options can affect performance values

² Calculated hours based on TM-21 projections and components used at the time of testing. Warranty is not associated with Calculated Lumen Maintenance

BABA-COMPLIANT FIXTURE ★ ★ ★

ISON™ VAPORTIGHT NARROW BODY, GEN 2

VTON2

Physical Information

Fixture Size	Length	Width	Depth	Weight ³
4'	51.70"	6.77"	4.37"	15.10 lbs.
8'	100.00"	6.77"	4.37"	22.00 lbs

Ambient Operating Temperatures (Tested at 12" Surface Mounted Height)

Nominal Lumen Code	Fixture Size	120v-277v	480v	Field Installed Battery Back Up
03L	4'	-20°C to 50°C [-4°F to 122°F]	-20°C to 55°C [-4°F to 131°F]	Min. Operating Temp. 0°C [32°F]
06L	4'	-20°C to 55°C [-4°F to 131°F]	-20°C to 55°C [-4°F to 131°F]	
10L	4'	-20°C to 45°C [-4°F to 113°F]	-20°C to 45°C [-4°F to 113°F]	
14L	4'	-20°C to 40°C [-4°F to 104°F]	-20°C to 40°C [-4°F to 104°F]	
09L	8'	-20°C to 55°C [-4°F to 131°F]	-20°C to 50°C [-4°F to 122°F]	
15L	8'	-20°C to 40°C [-4°F to 104°F]	-20°C to 40°C [-4°F to 104°F]	
20L	8'	-20°C to 50°C [-4°F to 122°F]	-20°C to 45°C [-4°F to 113°F]	

Additional Specification Information

³ Weight will vary based on option selection

ISON™ VAPORTIGHT NARROW BODY, GEN 2

VTON2

Ordering Information Example (NOTE: No dashes or spaces unless noted below)
VTON2410LUNVFD850LAFGHWSSSP-BABA

Ordering Information (Enter Selected Catalog Number Below)

Series	Fixture Size	Nominal Lumen Code	Voltage	Driver Type	CRI; Color Temp	Lens Options	Power Connection	Latch Type	Packaging	Fixture Certifications
VTON2= ISON™ Vaportight Series Narrow Body Gen 2	4= 4 ft. 8= 8 ft.	4' 03L= 3,000lm 06L= 6,000lm 10L= 10,000lm 14L= 14,000lm 8' 09L= 9,000lm 15L= 15,000lm 20L= 20,000lm	UNV= 120v-277v 480= 480v	FD= Full Dimming	840= 80CRI, 4000K 850= 80CRI, 5000K	LAFG= Lens Acrylic Frosted General 120°	HW= Hardwire (includes dimming leads) 06B= 6' Black Whip, no plug 11B= 11' Black Whip, no plug 06BD= 6' Black Whip, (includes dimming leads) no plug 11BD= 11' Black Whip, (includes dimming leads) no plug	SS= Stainless Steel	(blank)= Bulk Pack SP= Single Pack	-BABA= Buy America Build America Compliant <u>Note: This is a manufactured product in the United States that exceeds the 55% threshold for Build America Buy America (BABA) compliance</u>

Accessories (Factory Installed)

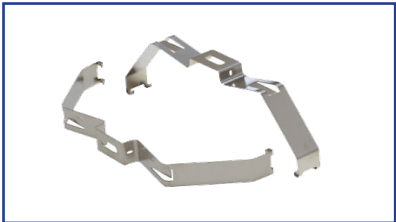

Surface Mounting Brackets
(Included with Fixture)

Additional Specification Information

⁴ For actual lumens, see performance table

BABA-COMPLIANT FIXTURE ★ ★ ★

ISON™ VAPORTIGHT NARROW BODY, GEN 2

VTON2

Not BABA Compliant Accessories (Field Installed)

Suspended Mounting Options	
VTON-ECAB19-KIT	Suspended Mounting Kit: 19" Cables with Snap Hooks and CT-BAIL
VTON-ECAB31-KIT	Suspended Mounting Kit: 31" Cables with Snap Hooks and CT-BAIL
VTON-HW-FC008-KIT	Suspended Mounting Kit: Hanging Cable Set: Adjustable 180", Loop, Y-Fit with Snap Hooks and CT-BAIL
CT-BAIL	Hanging Bail, for Narrow Vaportight Fixtures When Using Aircraft Hangers or Jack Chain (2 Needed per fixture)
Battery Back Up Option	
VT0-UNV-BB10-KIT ⁵	Field Installed Battery Back Up Kit, 10w, for VTON/VTOD UNV HW (120-277v hardwired) fixtures

Photometrics

Visit orionlighting.com to obtain all .IES files

VTON24 10L 840

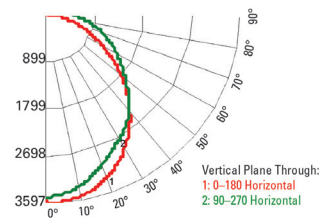

Additional Specification Information

⁵ Multiply 10w by the lumens per watt (LPW) of the fixture to calculate lumen output in emergency mode