

ISON™ VAPORTIGHT WIDE BODY, GEN 2

VTOD2

Applications

Durable and versatile fixture suitable for demanding environments that require a dust-proof fixture or watertight seal and wash down applications. This manufactured product meets the Build America, Buy America (BABA) requirement.

Project Name:	
Catalog Number:	
Type:	
Note:	
Date:	



VTOD2213LUNVFD850LAFGHWSS-BABA



IP67

IP69



Construction & Design

- This is a manufactured product in the United States that meets the 55% threshold for Build America Buy America (BABA) compliance
- Offered in both 2' and 4' lengths
- 316 stainless steel latches
- 316 stainless steel cable suspension brackets included as standard. Surface mount brackets must be ordered separately
- Durable, lightweight, white, UL 5VA (f1) reinforced fiberglass body
- Acrylic, impact resistant, shallow ribbed frosted lens
- Various lumen outputs to meet required light levels

Additional Options

- Multiple mounting methods for compatibility in most environments (not BABA Compliant)
- Field or Factory Installed Battery Back Up available in 10w

Electrical

- Available in 120v-277v, and 480v
- Factory wired for full dimming (0-10v) or ON/OFF applications
- 6kV/3kA surge protection standard
- Power Factor > .90*
- Total Harmonic Distortion < 20%*

*Note: Varies based on option

Lumen Maintenance

See lumen maintenance table on page 2

Fixture Certification & Listings

- Build America Buy America Compliant
- UL/cUL Listed for Wet Locations
- UL 5VA (f1) fiberglass housing
- IP67 for 4' fixtures
- IP69 for 2' fixtures
- NEMA 4X housing
- High pressure wash down up to 1500 PSI
- DesignLights Consortium standard qualified luminaire
- Visit the [DLC QPL](#) for listed models

Warranty

See Orion's [Product Limited Warranty](#) for more details and information

ISON™ VAPORTIGHT WIDE BODY, GEN 2

VTOD2

Performance Information 277v, ≥80 CRI, 5000K¹

Nominal Lumen Code	Actual Lumens	Wattage	LPW	Input Current
2'				
13L	13,750lm	87w	158	0.32A
16L	16,625lm	106w	158	0.39A
18L	18,540lm	121w	153	0.45A
4'				
21L	20,030lm	120w	167	0.44A
24L	23,756lm	143w	167	0.52A
32L	32,724lm	205w	160	0.76A
38L	37,733lm	234w	161	0.89A

Lumen Maintenance²

Fixture Size	Nominal Lumen Code	Nominal Lumens	Operating Temperature	Calculated Lumen Maintenance		
				L70	L80	L90
2'	13L	13,000	25°C	168,000	105,000	50,000
			55°C	138,000	86,000	41,000
2'	16L	16,000	25°C	168,000	105,000	50,000
			55°C	138,000	86,000	41,000
2'	18L	18,000	25°C	168,000	105,000	50,000
			55°C	138,000	86,000	41,000
4'	21L	21,000	25°C	174,000	109,000	52,000
			55°C	142,000	89,000	42,000
4'	24L	24,000	25°C	174,000	109,000	52,000
			55°C	142,000	89,000	42,000
4'	32L	32,000	25°C	174,000	109,000	52,000
			55°C	142,000	89,000	42,000
4'	38L	38,000	25°C	174,000	109,000	52,000
			55°C	142,000	89,000	42,000

Additional Specification Information

¹ Actual performance may vary by up to ±10% of values listed; facility factors and fixture options can affect performance values

² Calculated hours based on TM-21 projections and components used at the time of testing. Warranty is not associated with Calculated Lumen Maintenance

ISON™ VAPORTIGHT WIDE BODY, GEN 2

VTOD2

Physical Information

Size	Length	Width	Depth	Weight ³
2'	26.70"	14.50"	5.80"	16.50lbs.
4'	51.90"	14.60"	5.90"	26.00lbs.

Ambient Operating Temperatures (When Fixture is Suspended 12" From Mounting Surface)

Nominal Lumen Code	Fixture Size	Range 120v-277v	480v	Battery Back Up
13L	2'	-20°C to 45°C [-4°F to 113°F]	-20°C to 40°C [-4°F to 104°F]	Min. Operating Temp 0°C [32°F]
16L	2'	-20°C to 45°C [-4°F to 113°F]	-20°C to 40°C [-4°F to 104°F]	
18L	2'	-20°C to 40°C [-4°F to 104°F]	-20°C to 40°C [-4°F to 104°F]	
21L	4'	-20°C to 50°C [-4°F to 122°F]	-20°C to 50°C [-4°F to 122°F]	
24L	4'	-20°C to 50°C [-4°F to 122°F]	-20°C to 50°C [-4°F to 122°F]	
32L	4'	-20°C to 50°C [-4°F to 122°F]	-20°C to 50°C [-4°F to 122°F]	
38L	4'	-20°C to 45°C [-4°F to 113°F]	-20°C to 45°C [-4°F to 113°F]	

Additional Specification Information

³ Weight will vary based on option selection

ISON™ VAPORTIGHT WIDE BODY, GEN 2

VTOD2

Ordering Information Example (NOTE: No dashes or spaces unless noted below)
VTOD2213LUNVFD850LAFGHWSS-BABA

Ordering Information (Enter Selected Catalog Number Below)

Series	Fixture Size	Nominal Lumen Code ⁴	Voltage	Driver Type	CRI; Color Temp	Lens Options	Power Connection	Latch Type	Factory Installed Options	Packaging	Fixture Certifications
VTOD2= ISON™ Vaportight Series Wide Body, Gen 2	2= 2 ft. 4= 4 ft.	2' 13L= 13,000lm 16L= 16,000lm 18L= 18,000lm 4' 21L= 21,000lm 24L= 24,000lm 32L= 32,000lm 38L= 38,000lm	UNV= 120v-277v 480= 480v	FD= Full Dimming	840= 80CRI, 4000K 850= 80CRI, 5000K	LAFG= Lens Acrylic Frosted General 120°	HW= Hardwire [includes dimming leads] 06B= 6' Black Whip, no plug 11B= 11' Black Whip, no plug 06BD= 6' Black Whip, [includes dimming leads] no plug 11BD= 11' Black Whip, (in- cludes dim- ming leads) no plug	SS= Stainless Steel	(blank)= No Options BB10= Battery Back Up, 10w ⁵	(blank)= Bulk Pack SP= Single Pack	-BABA= Buy America Build America Compliant <u>Note: This is a manufactured product in the United States that exceeds the 55% threshold for Build America Buy America [BABA] compliance</u>



CT4-MB Cable Suspension Brackets
[4, Included with Fixture]



Stainless Steel Latches
[Included with Fixture]

Additional Specification Information

⁴ For actual lumens, see performance table

⁵ Multiply 10w by the lumens per watt (LPW) of the fixture to calculate lumen output in emergency mode

BABA-COMPLIANT FIXTURE ★ ★ ★

ISON™ VAPORTIGHT WIDE BODY, GEN 2

VTOD2

BABA Compliant Accessories (Field Installed)

Battery Back Up Option	
VT0-UNV-BB10-KIT-BABA ⁵	Field Installed Battery Back Up Kit, 10w, for VT0N/VTOD UNV HW (120-277v hardwired) fixtures

Not BABA Compliant Accessories (Field Installed)

Suspended Mounting Options	
ECAB19	19" Cables with Snap Hooks (2 Required per Fixture)
ECAB31	31" Cables with Snap Hooks (2 Required per Fixture)
HW-FC008	Hanging Cable Set: Adjustable 180", Loop, Y-Fit with Snap Hooks
HW-FC020-SH	Hanging Cable Set: Adjustable 120", loop, Y-fit with (2) Loops, (2) Snap Hooks Included (Not Attached)
CT4-VHOOK	Stainless Steel Flexible Ceiling Mount that Attaches to Supplied Fixture Mounting Clips. Also, Compatible with Chain or Cable Hanging Methods. (1 required per Fixture)

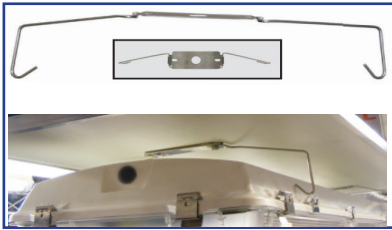

CT4-CM1.25

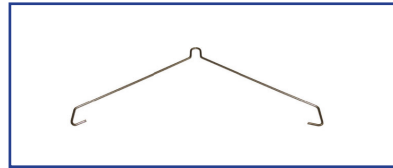

CT4-VHOOK

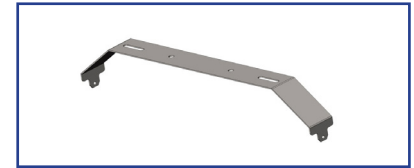

LED-VTOD1-RMBSS-KIT

Photometrics

Visit orionlighting.com to obtain all .IES files

VTOD22 16L 840

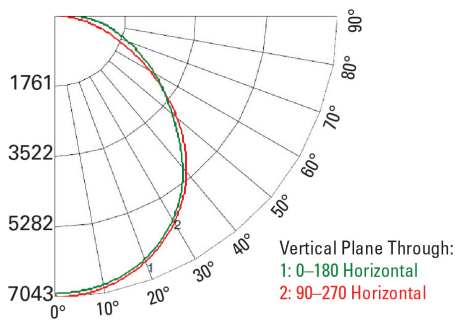

VTOD24 32L 840

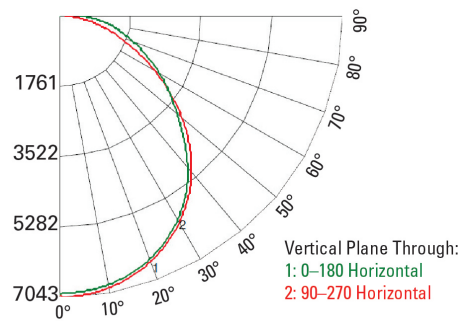

Additional Specification Information

⁵ Multiply 10w by the lumens per watt (LPW) of the fixture to calculate lumen output in emergency mode