

## Standard Assembly Instructions

Instruction Number: P-INT-X-464

Product Series: MPHL

Use this instruction for standard assembly instructions for the MPHL fixture.

### Components

- 1 Fixture Assembly (Body, Cover, Array(s), Driver)
- 2 (2) end caps
- 3 4 screws for end cap assembly

Note: Kit varies based on fixture size (4' or 8'), lens, no lens and baffle fixture models. Image A shows end cap for lens version. Image B shows end cap for no lens and baffle version.

- Optional End Mounted Sensor (Sold Separately-OEM Instructions included)
- Optional Whip Assembly (Sold Separately)

### Tools Required for Installation

- Cordless drill
- Wire Strippers

### Step-by-Step Instructions



#### WARNING!

Risk of fire or electric shock. To reduce risk of electrical shock, turn off power supply before installation or servicing.

1. Field installers are responsible for recognizing specific site requirements and making adjustments to assure a complete, functional installation.
2. Make all power connections using UL listed components.
3. Electrical connections must be made by a qualified electrician and in accordance with NEC and local codes.

- 1 Remove all fixture components from packaging listed above.  
NOTE: Some components ship separately for ease of assembly in the field.

- 2 Fixture cover is attached to pan when shipped from factory; remove fixture cover for ease of install of fixture end caps. Remove the desired knockout for whip or conduit (See Fig. 1)  
NOTE: See Page 2 for whip installation.

- 3 With provided screws, attach fixture end caps to each end of the pan; 2 screws needed per end cap. (See Fig. 2 and Fig. 3)

- 4 Reattach the cover to the pan by securely snapping in place. Ensure cover is secured along entire fixture body. (See Fig. 4 and Fig. 5 for correct position of prewired strip on pan, and see Fig. 6 for incorrect position by pushing the cover too far onto the pan)

NOTE: Do not pinch wires.

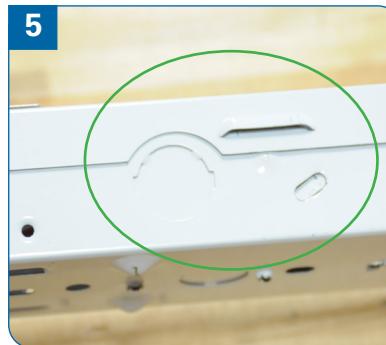
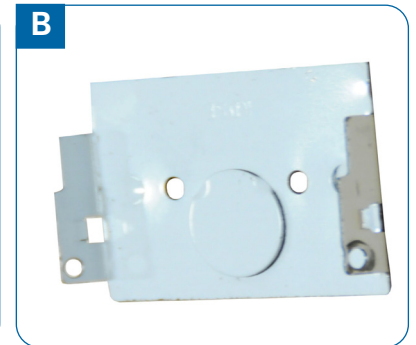

## Whip Assembly Instructions

Instruction Number: P-INT-X-464

Product Series: MPHL

- 1 Desired knockout location needs to be removed for power supply cord entry (end or back of fixture pan). (See Fig. 1b for sample location circled in green)
- 2 See Fig. 2b and Fig. 3b for install of power cord. Electrical connectors supplied with whip assembly.

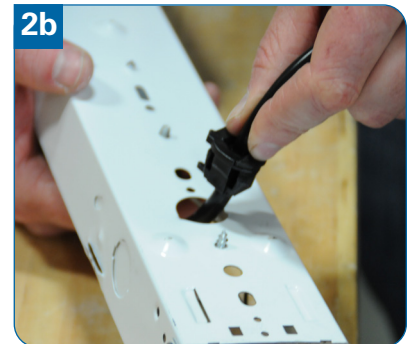

## End Mounted Sensor

Instruction Number: P-INT-X-464

Product Series: MPHL

- 1 Unthread the outer nut from sensor. Pull the sensor wires through the end cap knockout. (See Fig. 1)
- 2 Slide the provided nut over the sensor wires. (See Fig. 2)
- 3 Tighten nut so sensor is secured to the pan. (See Fig. 3)
- 4 Follow the OEM instructions for wiring to complete sensor set up.

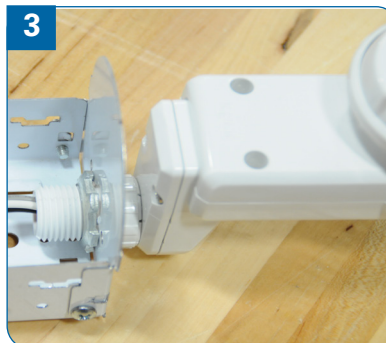
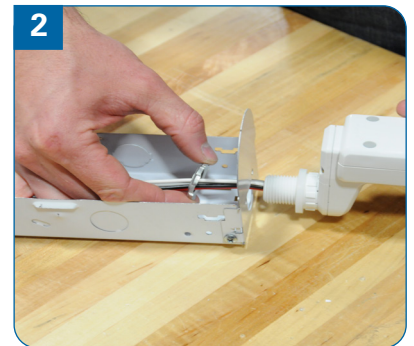
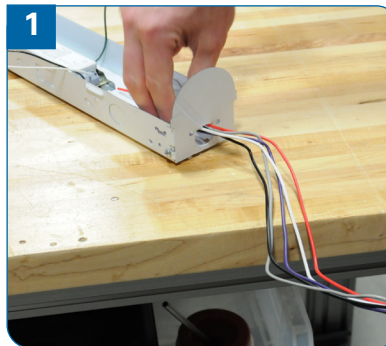

## Fixture Wireguard Installation

Instruction Number: P-INT-X-464.2

Product Series: MPHL

Use this instruction to install a fixture wireguard in the field for the MPHL product series.

### Components

- 1 MPHL Series Fixture (ordered separately)
- 2 LED-MPHL-WG01-KIT-SP or LED-MPHL-WG01-KIT  
NOTE: 4' Kit Includes: Fixture wireguard, hardware (4 screws, 4 loop clamps) (See Fig. A for provided hardware)

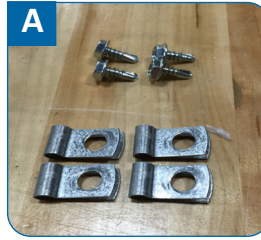

### Tools Required for Installation

-Cordless Drill

### Step-by-Step Instructions



#### **WARNING!**

Risk of fire or electric shock. To reduce risk of electrical shock, turn off power supply before installation or servicing.

1. Field installers are responsible for recognizing specific site requirements and making adjustments to assure a complete, functional installation.
2. Make all power connections using UL listed components.
3. Electrical connections must be made by a qualified electrician and in accordance with NEC and local codes.

- 1 Unpack components.
- 2 Place (4) loop clamps onto designated locations on wireguard and pinch closed with a flat nose pliers or fingers. Flat side of the loop clamp should be facing inward for ease of mounting flush to fixture. (See Fig.1 for loop clamp locations and placement on the wireguard-the first section from the end of the wireguard)
- 3 Place wireguard onto fixture body.
- 4 Insert screw into the loop clamp and fasten to the fixture body. Repeat this step for all 4 loop clamp locations to secure wireguard to fixture. For the (See Fig. 2 and Fig. 3 for completed install of wireguard)
- 5 Proceed to mount fixture per customer selected mounting method and complete electrical connections to NEC/local code.

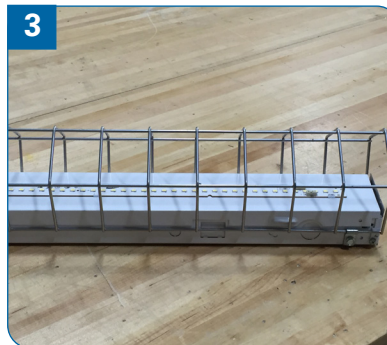
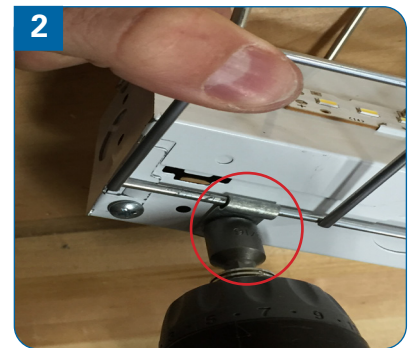
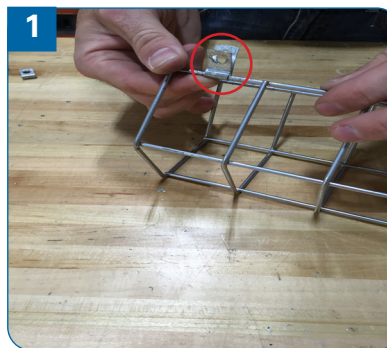

### For 8' Fixtures

2 kits will need to be ordered for 8' fixtures. When installing a wireguard onto an 8' fixture, use self tapping screws (not provided) for installation of the wireguard tabs and placement in the center of the fixture body (4 self tapping screws needed).



## MPHL2 Sensor Installation (VL, EN2/EN3, & P2/P3)

Instruction Number: P-INT-X-464.3



- Risk of fire or electrical shock. To reduce risk of electrical shock, turn off power supply before installation or servicing.**
1. Field installers are responsible for recognizing specific site requirements and making adjustments to assure a complete, functional installation.
  2. Make all power connections using UL listed components.
  3. Electrical connections must be made by a qualified electrician and in accordance with NEC and local codes.

### Components

Orion MPHL2 Fixture  
Plastic Endcap including Sensor  
8-18 x 1/4" Philips Screw

### Tools Required

#2 Philips Screwdriver

### Components

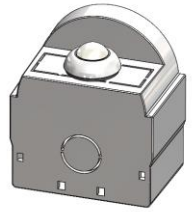

1



Install fixture as desired and wire per NEC and local codes.  
If hanging, suspend after endcaps are installed.

2



Wire sensor to fixture  
as shown below.

3

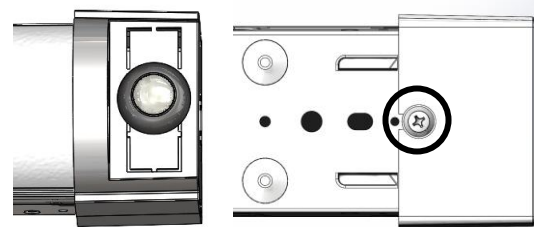

Install endcap on fixture. Fasten  
using screw on back.

