

LED Lumen Select Wall Pack Semi Cut Off, Gen 2

Instruction Number: P-INT-X-480

Product Series: LSWS2

Tools Required for Installation

- Cordless drill or Philips Screwdriver and Drill Bit Set
- Wire cutter/stripper



WARNING!

Risk of fire or electric shock. To reduce risk of electrical shock, turn off power supply before installation or servicing

This product should be installed, inspected, and maintained by a qualified electrician only, in accordance with the NEC (National Electric Code) and all local codes

Use only UL (or other NRTL) approved wire for input/output connections

Minimum 90°C supply conductors

Make sure LEDs and drivers are cool to touch when performing maintenance

Make sure the supply voltage is the same as the rated voltage of the luminaire

Mount fixture to surface with Lens facing down

CAUTION! For wet location compliance, fixture must be properly sealed. For moisture seal, apply silicone caulking between the mounting surface and back housing, as well as around the sides of the housing.

1. Field installers are responsible for recognizing specific site requirements and making adjustments to assure a complete, functional installation.
2. Make all power connections using UL listed components.
3. Electrical connections must be made by a qualified electrician and in accordance with NEC and local codes.

Standard Wiring Diagram

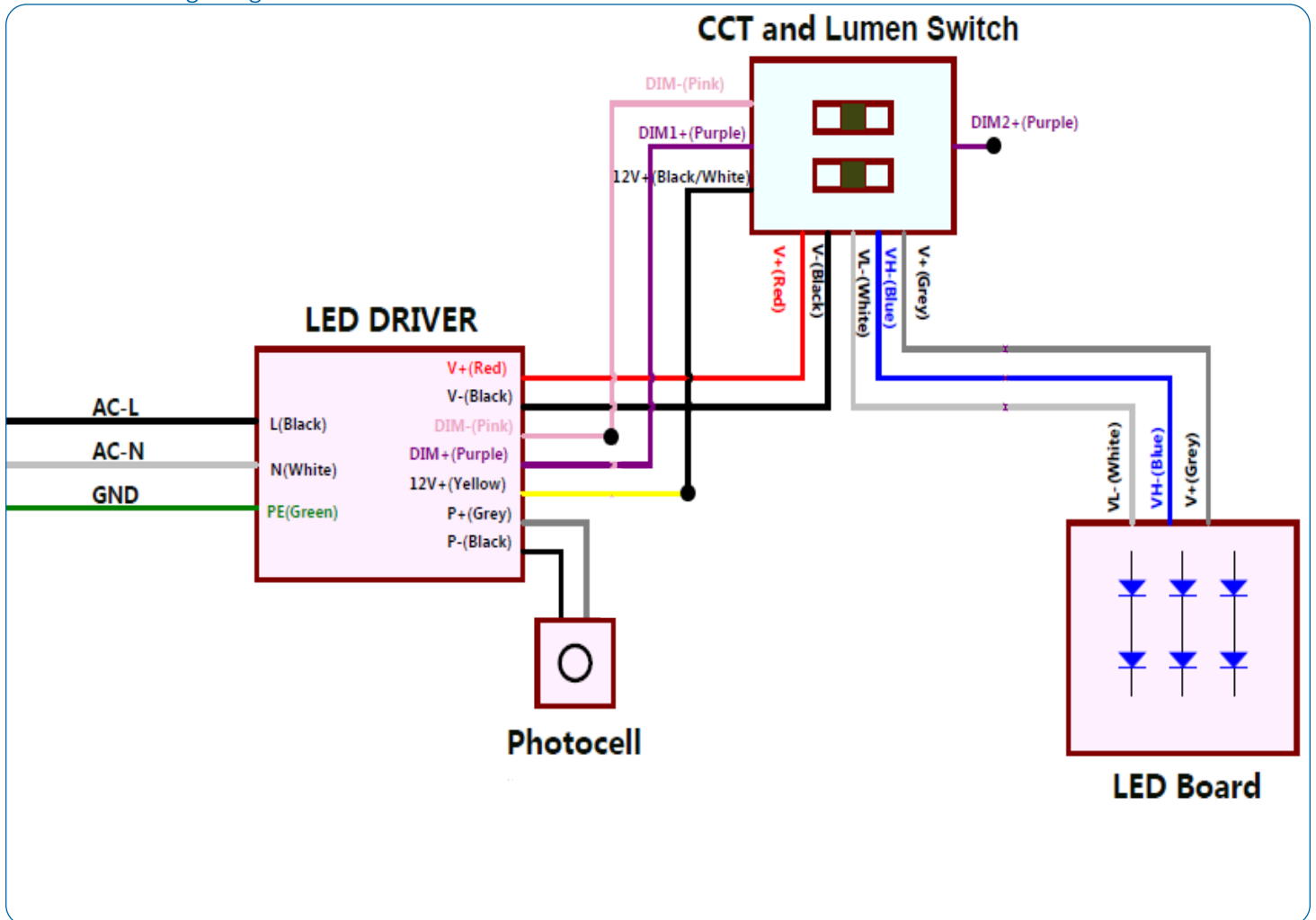

LED Lumen Select Wall Pack Semi Cut Off, Gen 2

Instruction Number: P-INT-X-480

Product Series: LSWS2

Battery Back Up Wiring Diagram

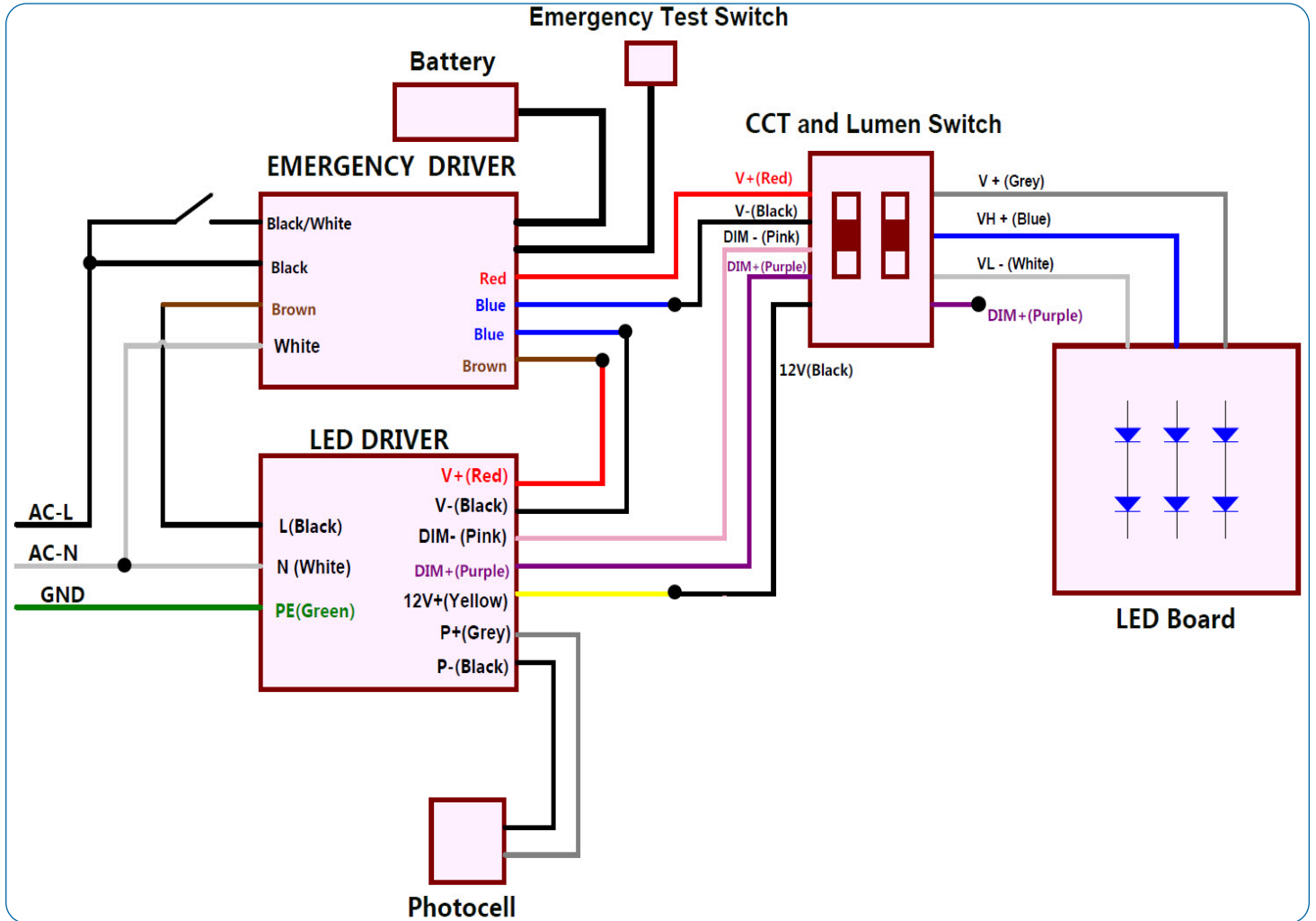

LED Lumen Select Wall Pack Semi Cut Off, Gen 2

Instruction Number: P-INT-X-480

Product Series: LSWS2

Mounting Instructions

Note: The back housing has a cast-in drill and knock-out template to match any standard recessed junction box, multiple knock-outs for mounting holes and three 1/2" NPS tapped holes for surface conduit.

- 1 Turn off power before installation. Open fixture by loosening the two screws. (See Fig. 1)
- 2 Disconnect the quick connect terminal before removing the front cover. (See Fig. 2)
- 3 Loosen and remove the center plug on the back of housing (See Fig. 3). Drill preferred installation mounting holes and attached sealing pad (provided) to the mounting back surface. (See Fig. 4 and Fig. 5)
- 4 Feed the wiring through the center hole.
- 5 Attach back housing to the wall or junction box using appropriate hardware (not provided). (See Fig. 6)
- 6 Make connections per NEC and local codes. Note: Photocell comes standard. If photocell is not needed disconnect plug. (See first page for standard wiring and battery back up diagrams)
- 7 Remove side plug and adjust CCT and lumens as needed. (See Fig. 1a on next page)
- 8 Reinstall the front cover and connect the quick connect terminal and close the front cover (See Fig. 6)
- 9 Make sure hinges are engaged properly and tighten the screws to secure cover (See Fig. 7).
- 10 Insert protective cap (4x provided) to each screw holes. One on each side, hinge screws (Fig. 6), and two at the top (Fig. 7).
- 11 Apply sealant to the top and side edges of the luminaire where contact is made with the wall ensuring a water tight seal. Restore power to fixture.

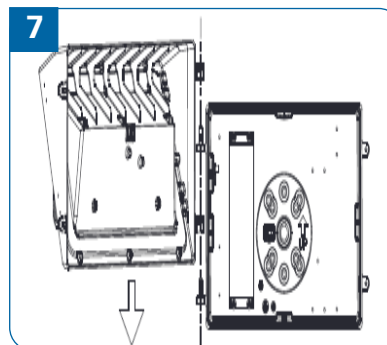
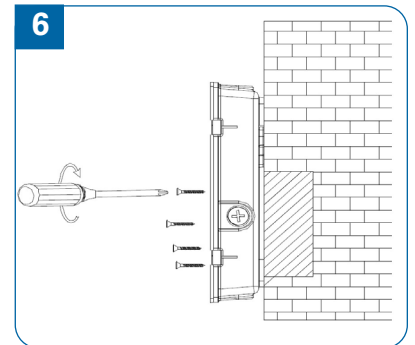
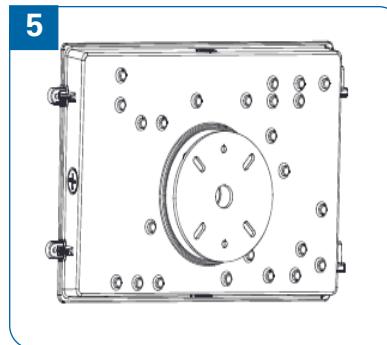
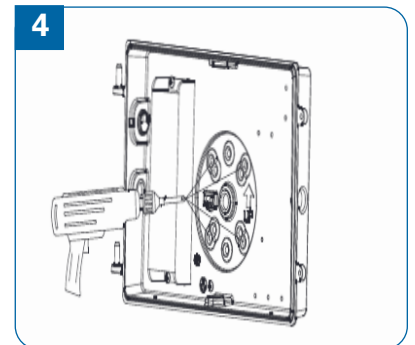
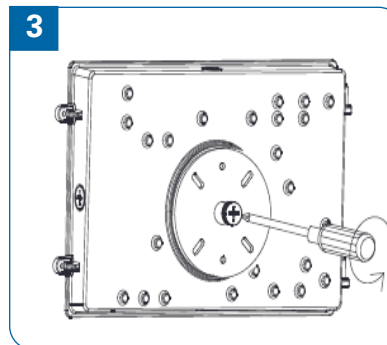
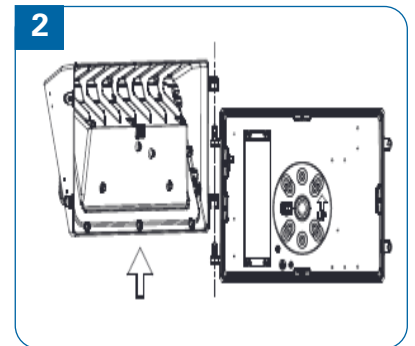
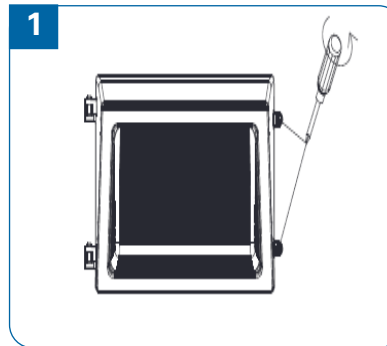

LED Lumen Select Wall Pack Semi Cut Off, Gen 2

Instruction Number: P-INT-X-480

Product Series: LSWS2

Field Adjustable CCT and Wattage

Note: All fixtures are set to max lumen output/wattage and 5000K at the factory.

- 1 If fixture is installed, turn off power supply.
- 2 Un-screw plug with a screwdriver.
- 3 Adjust CCT by switching to 3000K, 4000K, or 5000K. Adjust the lumens by switching to desired lumen output. (See Fig. 1a)
- 4 Reinstall the plug and tighten flush with top surface for proper seal.
- 5 Restore power to fixture.

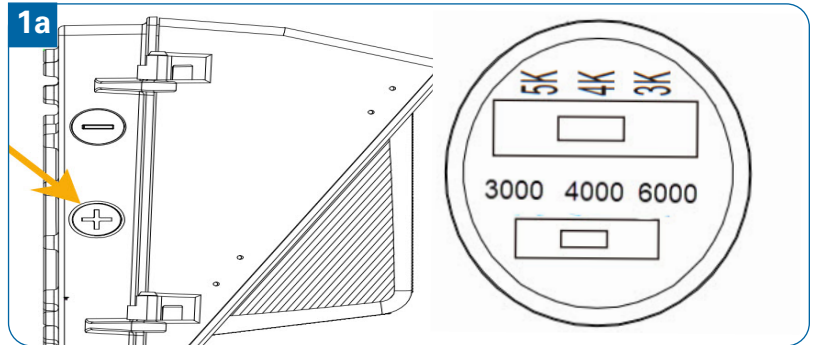

Photocell Instructions

Note: Photocell comes standard.

- 1 Disconnect connector to turn off photocell. (See Fig. 2a and 2b)

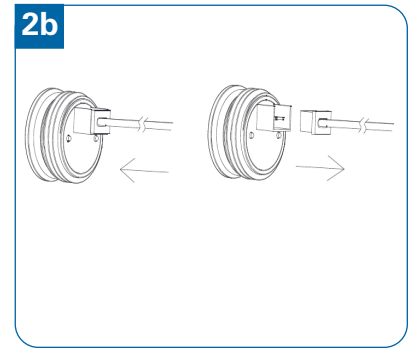
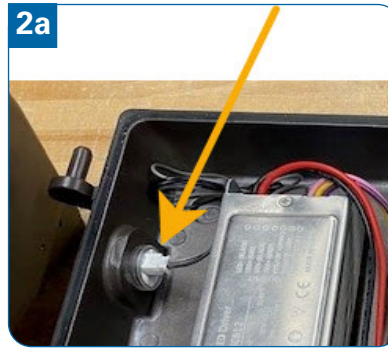

Wire Guide Instructions

- 1 Turn off power supply.
- 2 Unpack the wire guard and 4 screws (M3x6).
- 3 Align the wire guard with the holes in the fixture. Make sure the wire guard is in the right position and follows the lens shape. (See Fig 3a)
- 4 Fasten the screws on the housing with the screwdriver. (See Fig 3b)
- 5 Restore power to fixture.

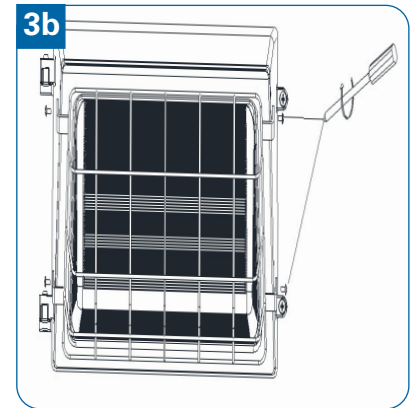
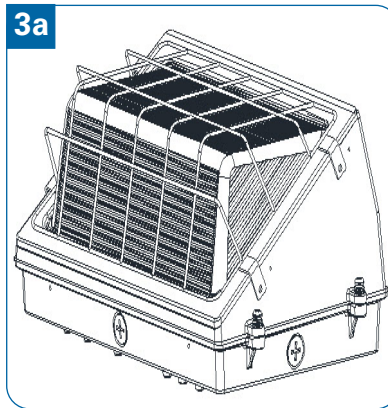

Light Shield Instructions

- 1 Turn off power supply.
- 2 Unpack the light shield and 4 screws (M3x6).
- 3 Align the shield with the holes of one side of the fixture and screw it with the screwdriver but do NOT tighten. (See Fig 4a)
- 4 Align the shield with the holes of the other side of the fixture and screw it with the screwdriver.
- 5 Tighten all four screws on both sides with the screwdriver. (See Fig 4b)
- 6 Restore power to fixture.

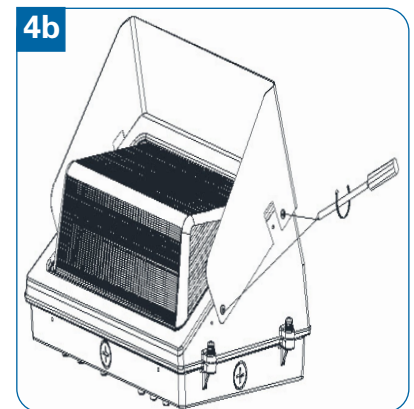
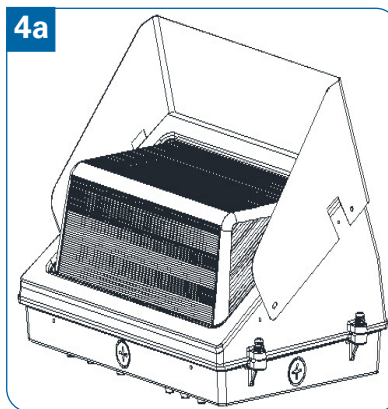

LED Lumen Select Wall Pack Semi Cut Off, Gen 2 Sensors and Controls Installation

Instruction Number: P-INT-X-480.1

Product Series: LSWS2

LSWS2-KBWP40

LSWS2-KAWP40

LSWS2-KAWCN

Tools Required for Installation

-Cordless drill or Philips Screwdriver and Drill Bit Set

-Wire cutter/stripper

Kit Includes (Image to the Right):

1. Aux Socket
2. Gasket
3. Wire Harness
4. Wire Connectors
5. Aux Socket Extension
6. Sensor

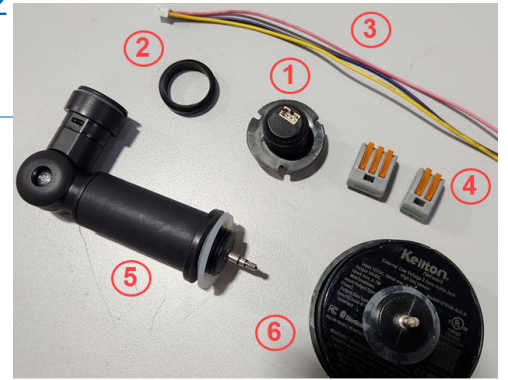

WARNING!

- Risk of fire or electric shock. To reduce risk of electrical shock, turn off power supply before installation or servicing
- This product should be installed, inspected, and maintained by a qualified electrician only, in accordance with the NEC (National Electric Code) and all local codes
- Use only UL approved wires and connectors
- Make sure LEDs and drivers are cool to touch when performing maintenance

CAUTION!

- Field installers are responsible for recognizing specific site requirements and making adjustments to assure a complete, functional installation.

Wiring Diagram - Sensor

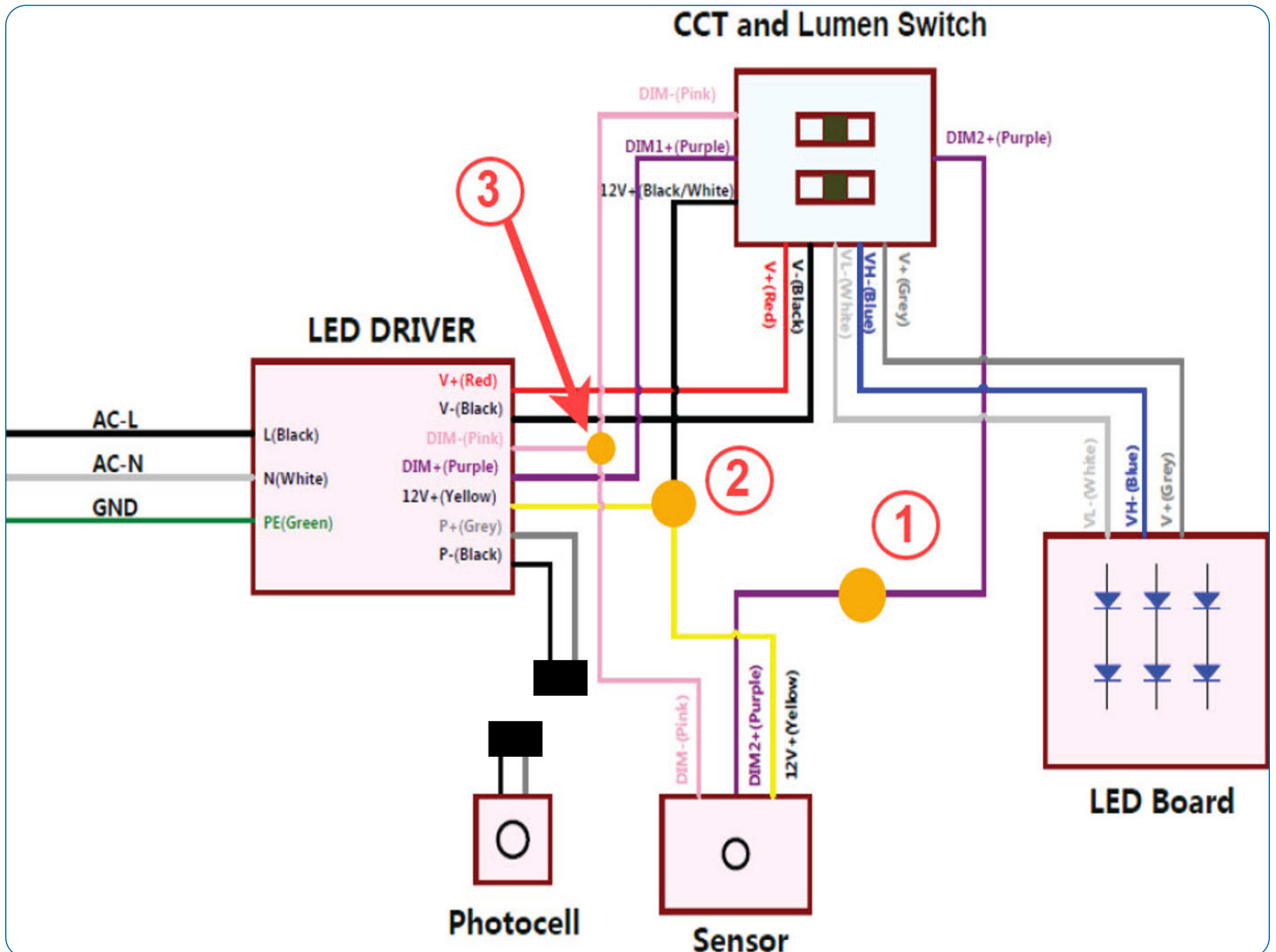

LED Lumen Select Wall Pack Semi Cut Off, Gen 2 Sensors and Controls Installation

Instruction Number: P-INT-X-480.1

Product Series: LSWS2

- 1 Turn off power before installation. Open fixture by loosening the two screws. (See Fig. 1)
- 2 Disconnect the quick connect terminal before removing the front cover. (See Fig. 2)
- 3 Un-screw side plug with screwdriver, plug on right side opposite to hinge. (See Fig. 3)
- 4 Slide Gasket (item 2) in place over Aux Socket (item 1). (See Fig. 4)
- 5 Screw Aux Socket in threaded entry hole. Tighten with finger only, ensure the Gasket touches the outside surface of the fixture. (See Fig. 5)
- 6 Connect Wire Harness (item 3) to Aux Socket. (See Fig. 6)
- 7 Make connections with Wire Connectors provided per NEC and local codes. Three (1, 2, 3) connections per wiring diagram and Fig. 7
- 8 **Note:** Photocell comes standard. Disconnect connector to photocell. (See Fig. 8)
- 9 Reinstall the front cover and connect the quick connect terminal and close the front cover. (See Fig. 9)
- 10 Make sure hinges are engaged properly and tighten the screws to secure cover.
- 11 Assemble Aux Socket Extension (item 5) to Aux Socket. Tighten for proper gasket seal. (See Fig.10)
- 12 Adjust Aux Socket Extension position for aiming Sensor away from wall. (See Fig.10)
- 13 Connect Sensor and tighten to Aux Socket Extension. (See Fig.10)
- 14 Restore power to fixture and test Sensor.

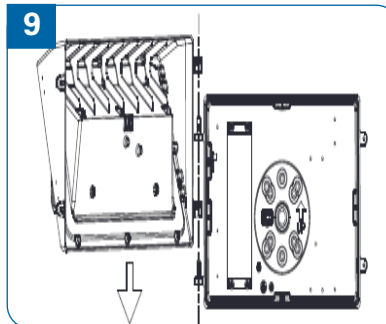
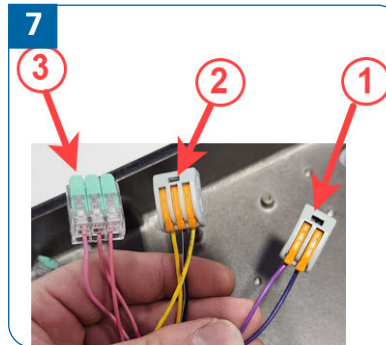
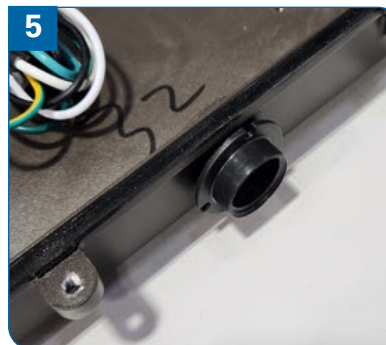
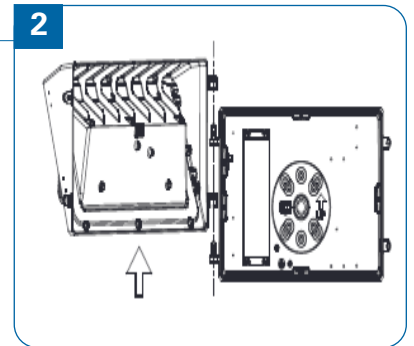
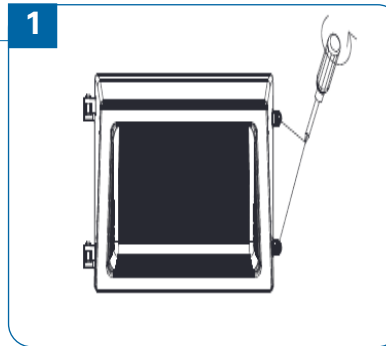

LED Lumen Select Wall Pack Semi Cut Off, Gen 2 Battery Back Up Installation

Instruction Number: P-INT-X-480.2

Product Series: LSWS2

Tools Required for Installation

- Cordless drill or Philips Screwdriver and Drill Bit Set
- Wire cutter/stripper

WARNING!



1. Field installers are responsible for recognizing specific site requirements and making adjustments to ensure a complete, functional installation.
2. Electrical connections must be made by a qualified electrician and in accordance with NEC and local codes.
3. Make all power connections using UL listed components.
4. Make sure the supply voltage is the same as the rated voltage of the luminaire.
5. Proper grounding is required to ensure safety.
6. Please wear gloves to avoid injury before installation.
7. Check if there is any damage during shipping. If so, contact manufacturer immediately.
8. Read the installation instruction carefully to check whether all the accessories are included. After confirmation, then install the fixture according to installation steps.
9. Appropriate safety equipment needed during installation, to be determined by installer and per applicable safety standards and precautions.
10. Risk of fire or electrical shock. DO NOT cover fixture with insulation or similar material.
11. DO NOT install on unstable or easily breakable surface

Battery Back Up Wiring Diagram

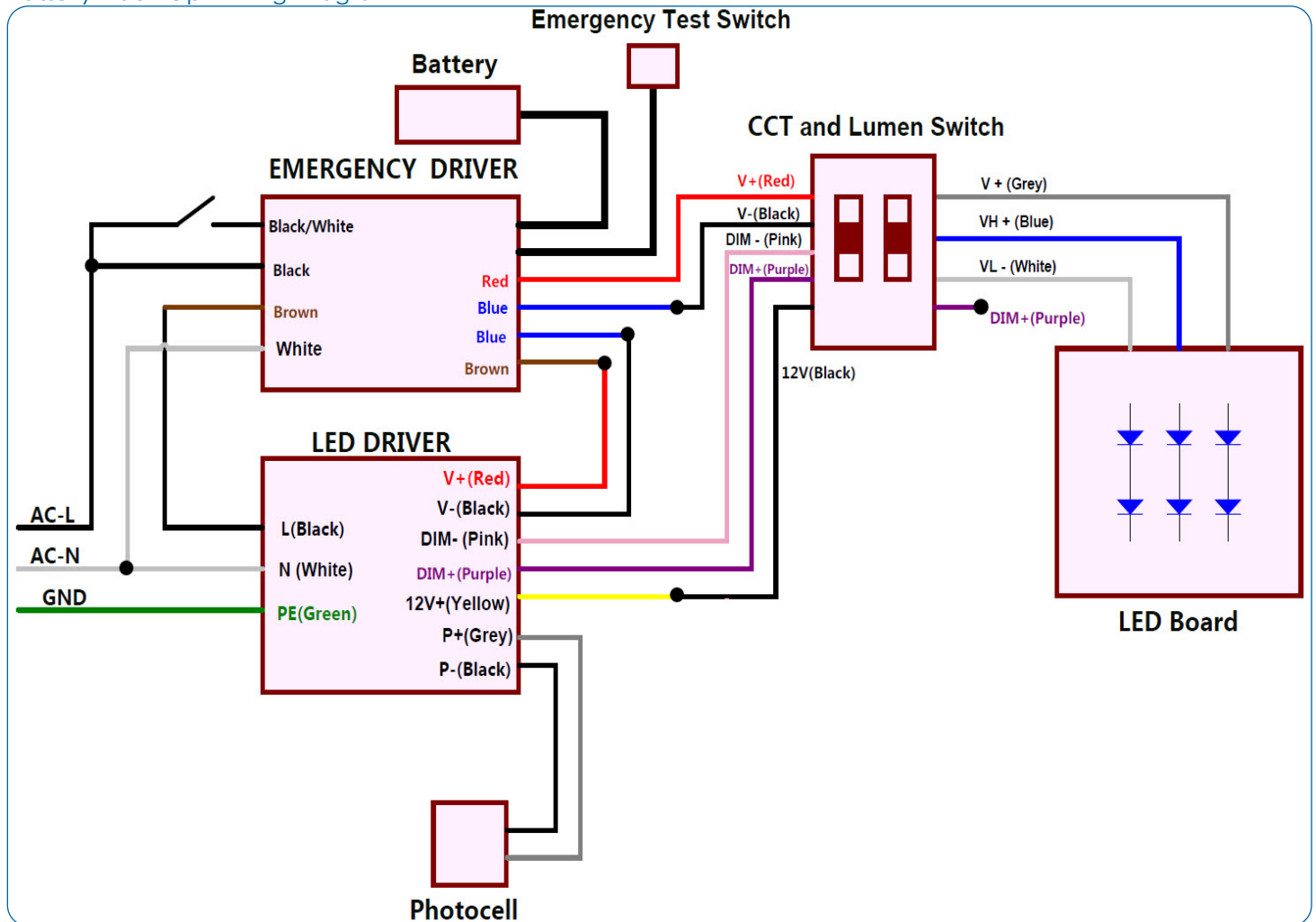

LED Lumen Select Wall Pack Semi Cut Off, Gen 2 Battery Back Up Installation

Instruction Number: P-INT-X-480.2

Product Series: LSWS2

EXT-LSWS2-BB08-KIT

Use these standard install instructions for installing battery back up in the field on the LSWS2 fixture.

Kit Components (see image to the right):

- Emergency Driver 8w
- Battery Pack
- Test Switch
- Wire Connectors
- Screws
- Wire and Cord
- Bracket (discard, not needed for the LSWS2 fixture)

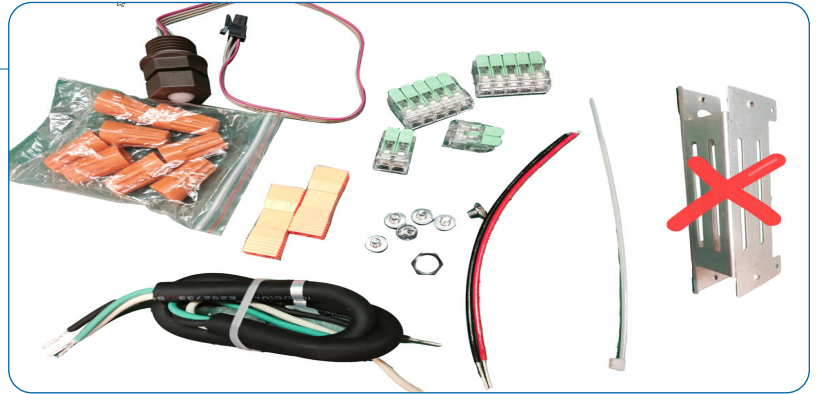

- 1 Turn off power before installation. Open fixture by loosening the two screws. (See Fig. 1)
- 2 Disconnect the quick connect terminal before removing the front cover. (See Fig. 2)
- 3 Loosen and remove bottom surface conduit entry plug (See Fig.3)
- 4 Mount Emergency Driver and Battery Pack in position shown in Fig. 5. Align with holes in housing and secure with screws provided .
- 5 Install Test Switch to bottom threaded entry hole. Tighten for proper gasket seal. (See Fig. 4)
- 6 Connect Test Switch wire connector to Emergency Driver connector.
- 7 Make wiring connections to Emergency Driver output wires (Red, Blue, Blue, Brown) per NEC and local codes. See wiring diagram.

Note: Photocell comes standard. If photocell is not needed disconnect plug.

- 8 Make wiring connections to Emergency Driver input wires (White, Brown, Black, Black/White). A separate un-switched AC power source is required for charging the battery. Complete the power source wiring per NEC and local codes.
- 9 Connect Battery Pack connector to Emergency Driver connector.
- 10 Reinstall the front cover and connect the quick connect terminal and close the front cover. (See Fig. 6)
- 11 Make sure hinges are engaged properly and tighten the screws to secure cover (See Fig. 1).
- 12 Restore power to fixture.

