

## LED Lumen Select Wall Pack Full Cut Off, Gen 2

Instruction Number: P-INT-X-479

Product Series: LSWF2

### Tools Required for Installation

- Cordless drill or Philips Screwdriver and Drill Bit Set
- 4mm Metric Hex Bit
- Wire cutter/stripper

#### WARNING!



Risk of fire or electric shock. To reduce risk of electrical shock, turn off power supply before installation or servicing

This product should be installed, inspected, and maintained by a qualified electrician only, in accordance with the NEC (National Electric Code) and all local codes

Use only UL (or other NRTL) approved wire for input/output connections

Minimum 90°C supply conductors

Make sure LEDs and drivers are cool to touch when performing maintenance

Make sure the supply voltage is the same as the rated voltage of the luminaire

Mount fixture to surface with Lens facing down

**CAUTION!** For wet location compliance, fixture must be properly sealed. For moisture seal, apply silicone caulking between the mounting surface and back housing, as well as around the sides of the housing.

1. Field installers are responsible for recognizing specific site requirements and making adjustments to assure a complete, functional installation.
2. Make all power connections using UL listed components.
3. Electrical connections must be made by a qualified electrician and in accordance with NEC and local codes.

### Standard Wiring Diagram

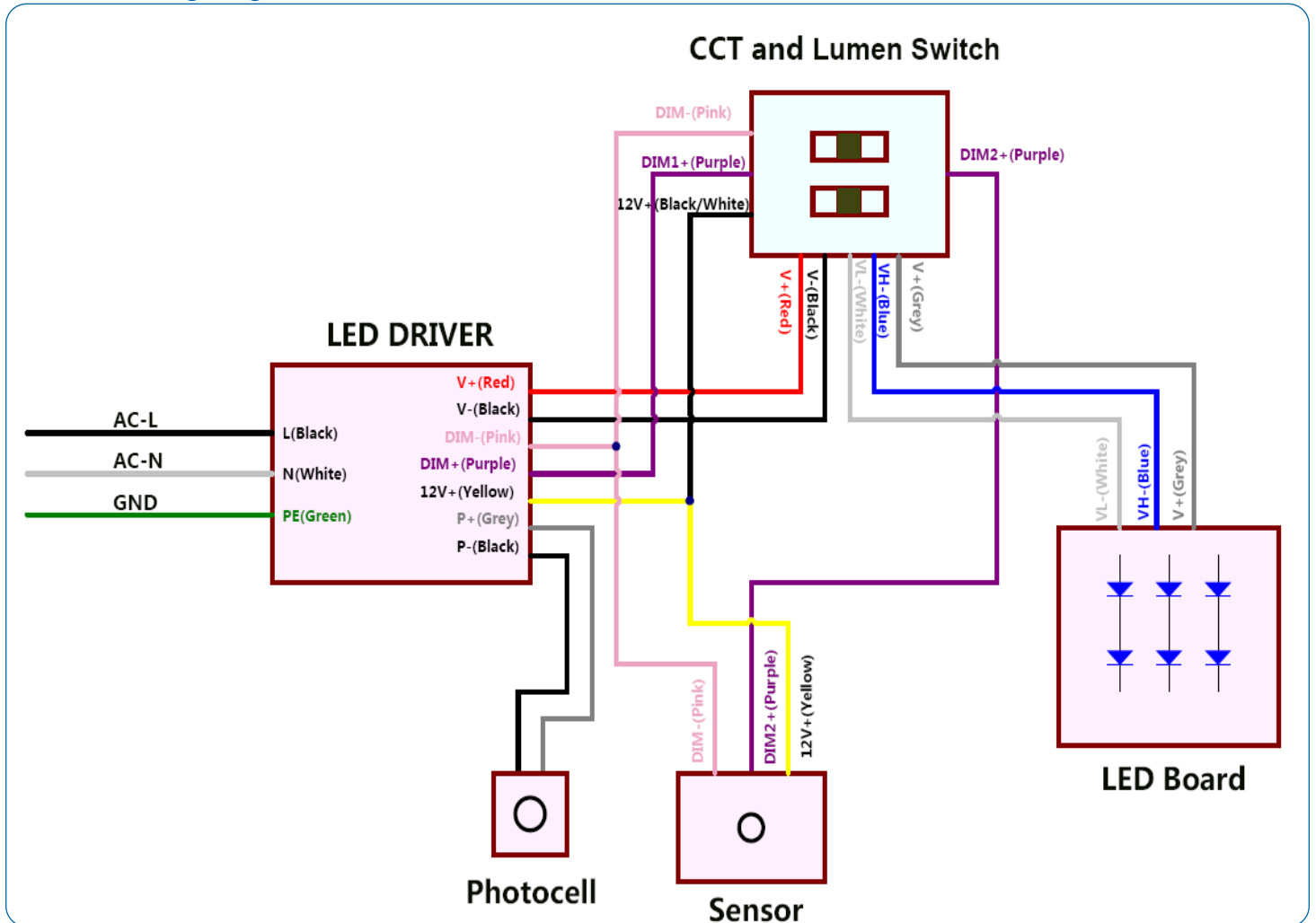

LED Lumen Select Wall Pack Full Cut Off, Gen 2

Instruction Number: P-INT-X-479

Product Series: LSWF2

Battery Back Up Wiring Diagram

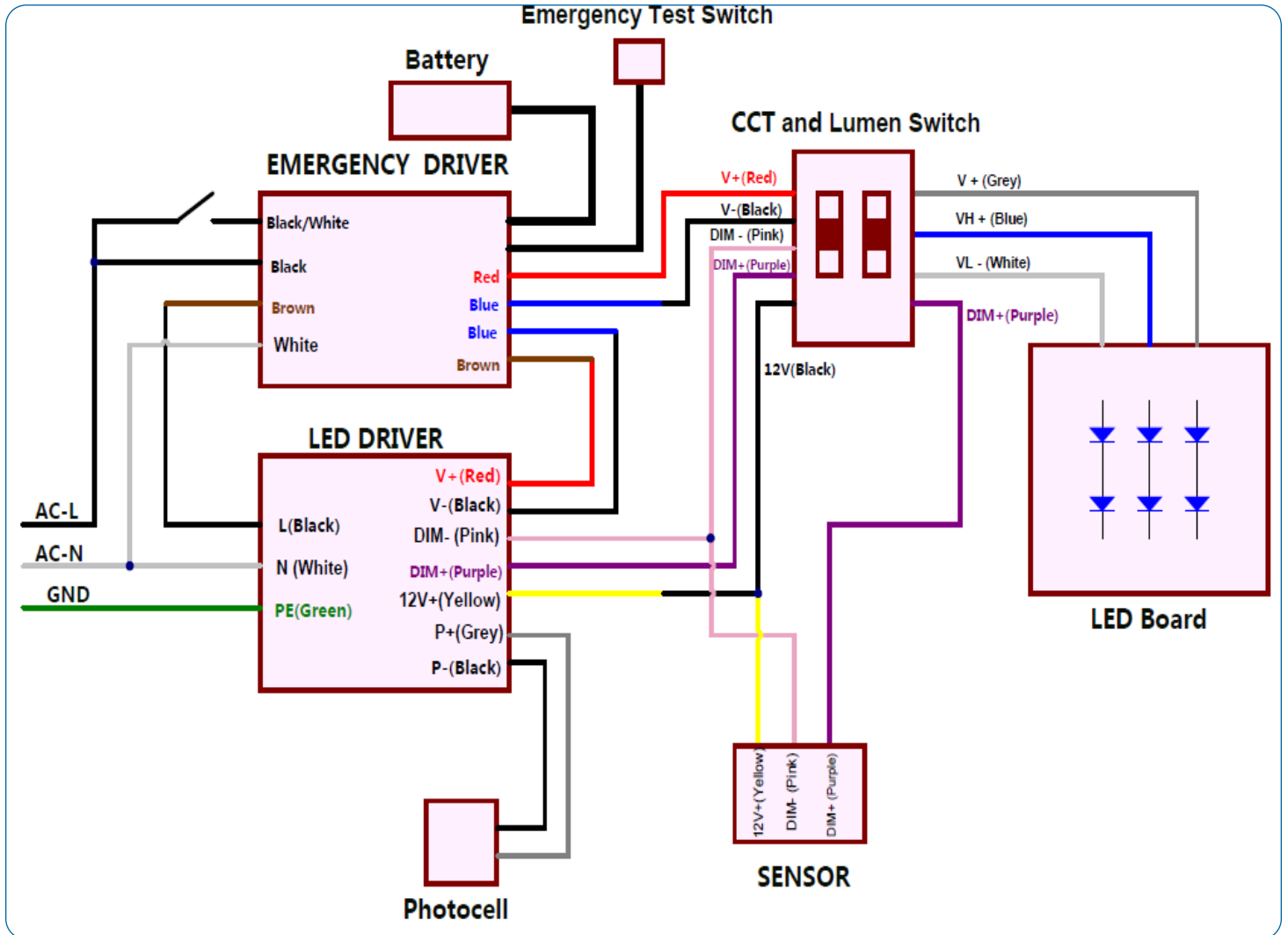

## LED Lumen Select Wall Pack Full Cut Off, Gen 2

Instruction Number: P-INT-X-479

Product Series: LSWF2

### Mounting Instructions

**Note:** The back housing has a cast-in drill and knock-out template to match any standard recessed junction box, multiple knock-outs for mounting holes.

- 1 Turn off power before installation. Open fixture by loosening the four screws using the 4mm hex bit, not provided. (See Fig. 1)
  - 2 Remove the front cover (See Fig. 2)
  - 3 Loosen and remove the center plug on the back of housing (See Fig. 3). Drill preferred installation mounting holes and attached sealing pad (provided) to the mounting back surface. (See Fig. 4)
  - 4 Feed the wiring through the center hole.
  - 5 Attach back housing to the wall or junction box using appropriate hardware (not provided). (See Fig. 5)
  - 6 Remove side plug and adjust CCT and lumens as needed. (See Fig. 1a on next page)
  - 7 Reinstall the front cover and make electrical connections per NEC and local code. Connect ground to ground wire on back of housing and close the front cover (See Fig. 6)
- Note:** Photocell comes standard if photocell is not needed disconnect the plug. (see wiring diagrams on the first and second pages)
- 8 Make sure hinges are engaged properly and tighten the screws to secure cover (See Fig. 7).
  - 9 Insert protective cap (4x provided) to each screw holes. One on each side, hinge screws (See Fig. 6), and two at the top (See Fig. 7).
  - 10 Apply sealant to top and side of the edges of the luminaire where contact is made with the wall ensuring a water tight seal. Restore power to fixture.

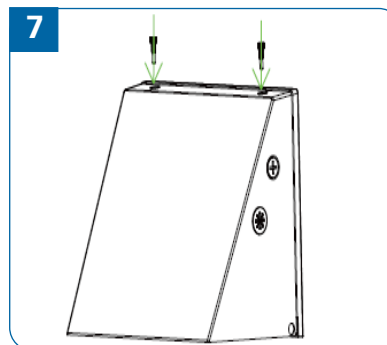
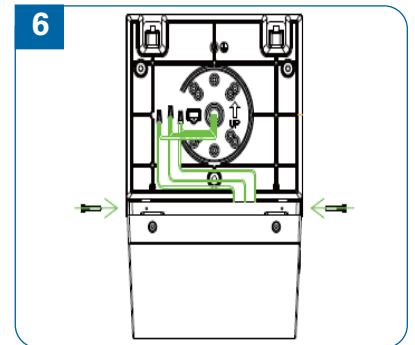
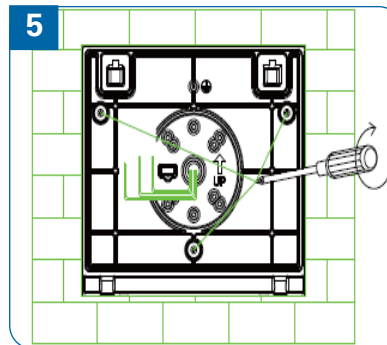
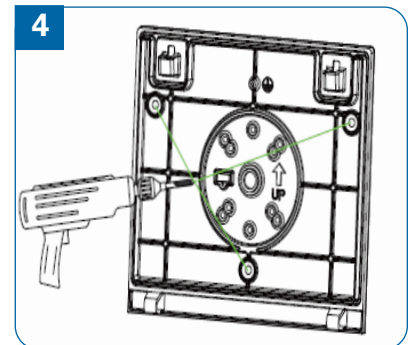
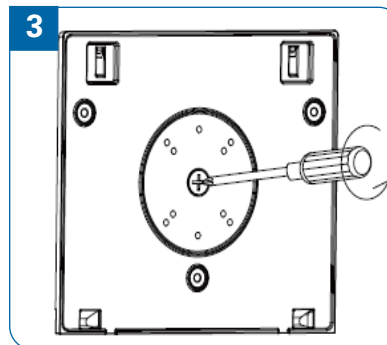
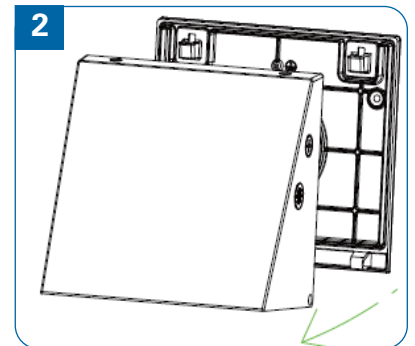
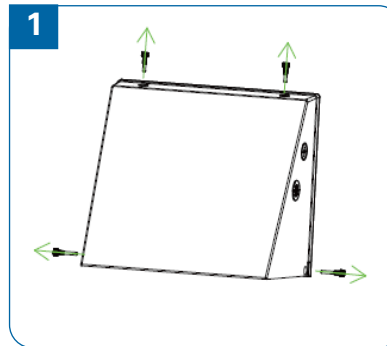

## LED Lumen Select Wall Pack Full Cut Off, Gen 2

Instruction Number: P-INT-X-479

Product Series: LSWF2

### Field Adjustable CCT and Wattage

**Note:** All fixtures are set to max lumen output/wattage and 5000K at the factory.

- 1 If fixture is installed, turn off power supply.
- 2 Un-screw plug with a screwdriver.
- 3 Adjust CCT by switching to 3000K, 4000K, or 5000K. Adjust the lumens by switching to desired lumen output. (See Fig. 1a)
- 4 Reinstall the plug and tighten flush with top surface for proper seal.
- 5 Restore power to fixture.

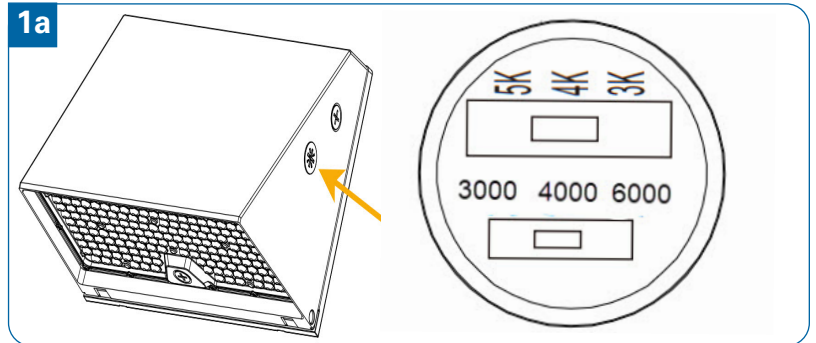

### Photocell Instructions

**Note:** Photocell comes standard.

- 1 Disconnect connector to turn off photocell. (See Fig. 2a and 2b)

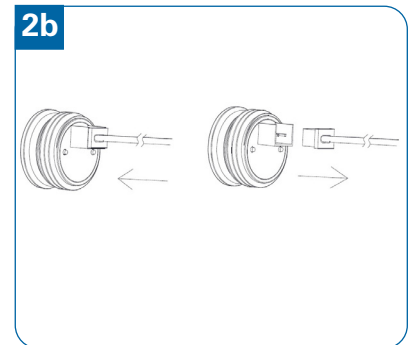
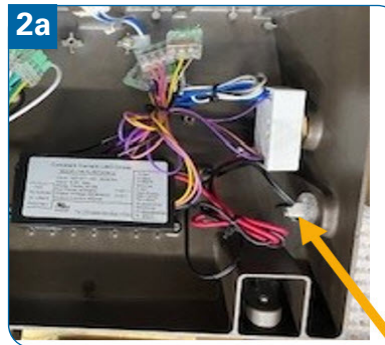

### Motion Sensor Instructions

**Note:** This fixture includes a pre-wired sensor receptacle.

**WARNING: Disconnect Photocell before installing the sensor**

- 1 Turn off power supply.
- 2 Take the DC PIR or Microwave Sensor out of the package.
- 3 Un-screw plug with screwdriver. (See Fig. 3a)
- 4 Ensure gasket is properly in place on sensor module.
- 5 Screw sensor module until snug for watertight seal. (See Fig. 3b)
- 6 Adjust the DC PIR or Microwave Sensor settings to get the function needed by using the remote control RM51 (ordered separately).
- 7 Restore power to fixture.

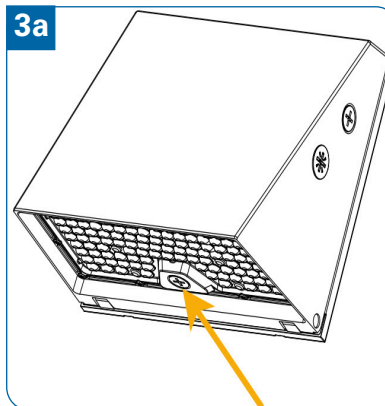

## LED Lumen Select Wall Pack Full Cut Off, Gen 2 Battery Back Up Installation

Instruction Number: P-INT-X-479.1

Product Series: LSWF2

### Tools Required for Installation

- Cordless drill or #2 Philips Screwdriver and Flat Head Screwdriver
- 4mm Metric Hex Bit
- Wire cutter/stripper
- 1/2" Drill Bit (0.500")

#### WARNING!



- Field installers are responsible for recognizing specific site requirements and making adjustments to ensure a complete, functional installation.
- Electrical connections must be made by a qualified electrician and in accordance with NEC and local codes.
- Make all power connections using UL listed components.
- Make sure the supply voltage is the same as the rated voltage of the luminaire.
- Proper grounding is required to ensure safety.
- Please wear gloves to avoid injury before installation.
- Check if there is any damage during shipping. If so, contact manufacturer immediately.
- Read the installation instruction carefully to check whether all the accessories are included. After confirmation, then install the fixture according to installation steps.
- Appropriate safety equipment needed during installation, to be determined by installer and per applicable safety standards and precautions.
- Risk of fire or electrical shock. DO NOT cover fixture with insulation or similar material.
- DO NOT install on unstable or easily breakable surface.

### Battery Back Up Wiring Diagram

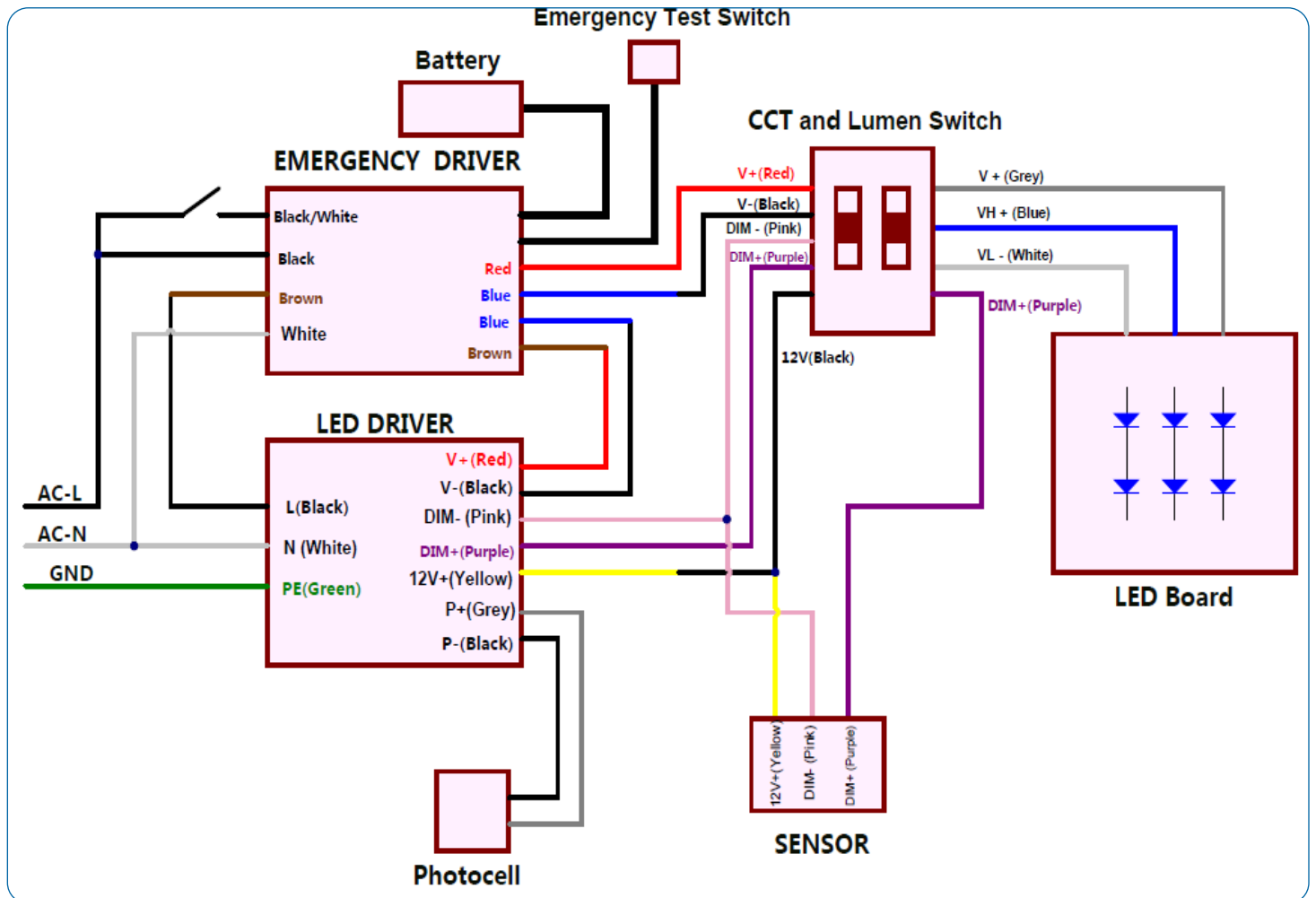

## LED Lumen Select Wall Pack Full Cut Off, Gen 2 Battery Back Up Installation

Instruction Number: P-INT-X-479.1

Product Series: LSWF2

### EXT-LSWF2-BB08-KIT

**Use these instructions to install the battery back up in the field on the LSWF2 fixture.**

#### Kit Components (see image to the right):

- Emergency Driver 8w
- Battery Pack
- Test Switch Assembly
- Wire Connectors
- 1/2" Nut and Screws
- Wire and Cord
- Mounting Bracket

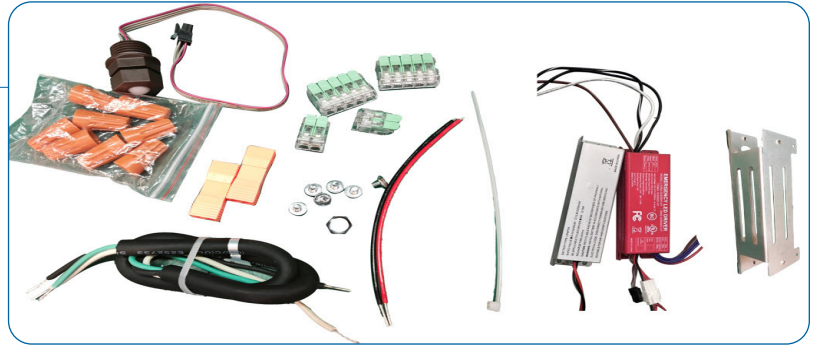

- 1 Turn off power before installation.
- 2 Disassemble Test Switch from brown plastic housing. Discard housing. Remove white rubber cover and place over button area of Test Switch. (See Fig.1)
- 3 Open fixture by loosening the four screws using the 4mm hex bit, not provided. (See Fig. 2) Remove the front Housing.
- 4 Drill .500" Diameter hole on right side surface of front cover per dimensions. (See Fig.3)  
**LSWF2A1/B1** X = 2.5 Y=2.1"  
**LSWF2C1** X= 3.4" Y=2.5"
- 5 Install Test Switch with rubber cover into .500" hole. Tighten in place with Nut provided. (See Fig.4)
- 6 Mount Emergency Driver and Battery Pack onto Bracket with screws provided. (See Fig.5)
- 7 Mount Bracket assembly inside housing with screws provided. (See Fig.6)
- 8 Connect Test Switch wire connector to Emergency Driver connector. Make wiring connections to Emergency Driver output wires (Red, Blue, Blue, Brown) per NEC and local codes. See wiring diagram.  
**Note:** Photocell comes standard. If photocell is not needed disconnect the plug.
- 9 Make wiring connections to Emergency Driver input wires (White, Brown, Black, Black/White) per NEC and local codes. A separate un-switched AC power source is required for charging the battery.
- 10 Install back housing to the wall per Installation Instructions provided with the fixture.
- 11 Reinstall the front housing to back housing the front cover. (See Fig. 7)
- 12 Make power connections per NEC and local codes. Connect Battery Pack connector to Emergency Driver connector. See wiring diagram.
- 13 Make sure hinges are engaged properly and tighten the screws to secure cover (See Fig. 8) Restore power to fixture.

