

ALLED3 Series Area Lights

SAVE THESE INSTRUCTIONS



BEFORE YOU BEGIN

Read and follow all safety instructions



WARNING

RISK OF FIRE, EXPLOSION AND ELECTRIC SHOCK

- This product should be installed, inspected, and maintained by a qualified electrician only, in accordance with the NEC (National Electric Code) and all local codes.
- Turn off electrical power before inspection, installation or removal.
- Use only UL (or other NRTL) approved wire for input/output connections. Minimum size 18 AWG or 14 AWG for continuous runs.
- Make sure LEDs and drivers are cool to touch when performing maintenance. Make sure the supply voltage is the same as the rated voltage of the luminaire.
- Do not install in a hazardous atmosphere, except where the ambient temperature does not exceed the rated operating temperature of the fixture.
- Keep tightly closed when in operation



Prepare Electrical Wiring



Electrical Requirements

- The LED driver must be supplied with 120 to 277V, 50/60 Hz (or 347 to 480V, 50/60 Hz, when applicable - refer to product label) and connected to an individual, properly grounded branch circuit protected by a 20 Ampere circuit breaker. Use min. 75°C supply.



Grounding Instructions

- The grounding and bonding of the overall system shall be done in accordance with NEC Article 600 and local codes

LED Area Light

ALLED3 Series

Installation Guide

Tools and Materials Required:

#2 Phillips Screw Driver
Wire Strippers
Wire Cutters
Hex Bit Socket Wrench or Combo Wrench (1/2")
Silicone Caulk

- Before starting ensure that the power is disconnected.
- Unpack fixture and ensure that there are no damaged parts.

Pole Mounting:

- Remove the pole mounting arm cover.
- Feed the included bolts, lock and flat washers through the mounting arm holes.
- Align with the holes in the pole and thread through the plate on the inside of the pole.
- Hand tighten the bolts to 20 lbf-in.
- Open the LED driver compartment from the underside of the fixture.
- Feed the included bolts, lock and flat washers through the inside of the driver compartment, fixture mount gasket, and attach the fixture to the pole mount.
- Feed the power cable through the strain relief and pole mount arm and connect the power leads with the included wire nuts according to the wiring diagram on Page 4. **Make sure the strain relief is installed correctly**
- Close the LED driver compartment door and secure it with the supplied screws
- Replace the pole mount arm gasket and attach the cover with the supplied screws

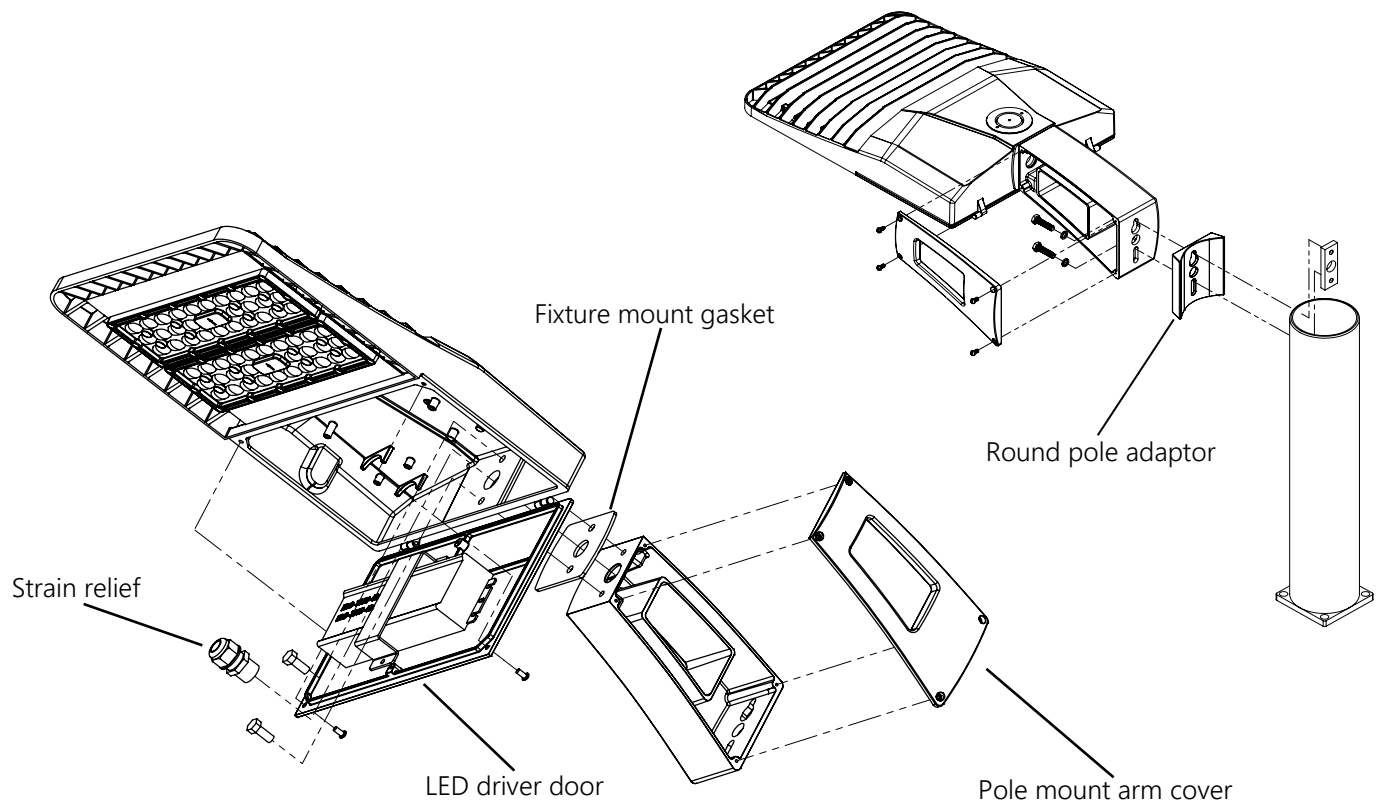
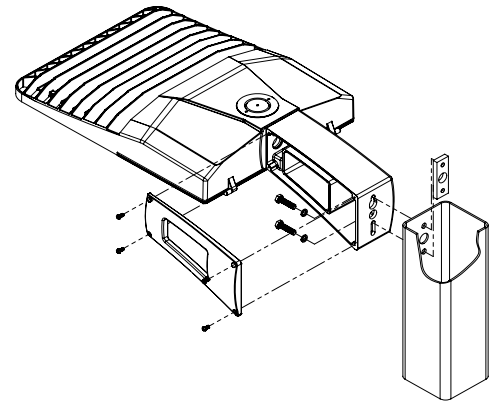
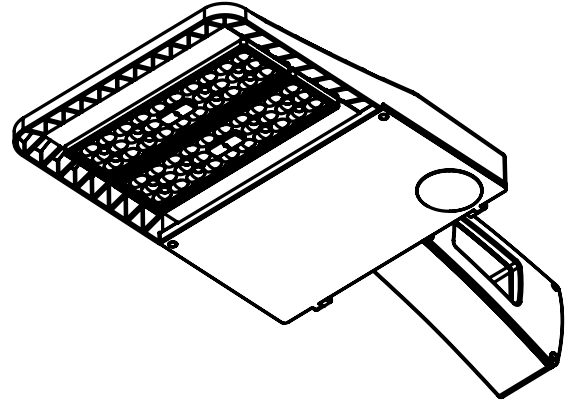

Slip fitter (Knuckle) Mounting:

- Slide the slip fitter mount over the tenon bracket
- Ensure that the power cord is not pinched when feeding through the tenon mount
- Remove round slip fitter cover and loosen bolt to adjust tilt angle on fixture
- When desired angle is reached, tighten the center to lock the slip fitter in place. Replace cover
- Tighten the 2 set screws on the slip fitter to 15 ft-lbs to secure it to the tenon
- Make wiring connections as shown on Page 4

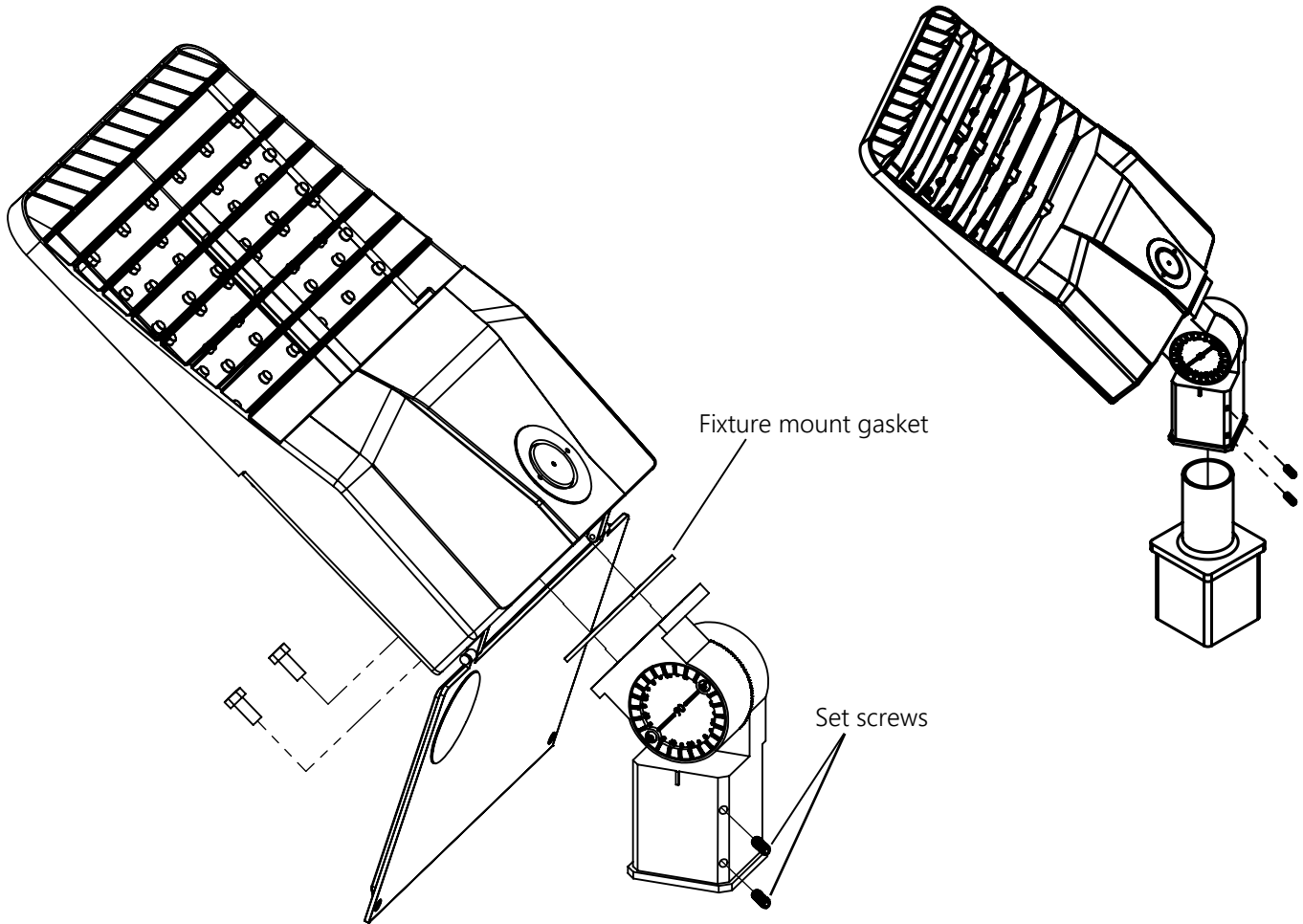

U-Bracket Mounting:

- Remove U-bracket from fixture by removing the 2 bolts on each side
- Drill holes in the mounting surface and bolt the U-bracket in place
- Align the fixture to the U-bracket and secure by tightening the bolts on each side
- Apply silicone around bolts from inside the driver compartment for water-proofing
- Rotate fixture until desired angle is achieved and tighten bolts on each side
- Route the cord into a junction box and make wiring connections shown below
Black to Black (Hot), White to White (Neutral), Green to Green (Ground)
- Ensure that the entry into the junction box is water tight with a bushing or other water sealing device

Trunnion Mounting:

- Drill holes in the mounting surface matching the pattern of the trunnion and bolt in place
- Rotate fixture until desired angle is achieved and tighten bolts on each side
- Route the cord into a junction box and make wiring connections shown below
Black to Black (Hot), White to White (Neutral), Green to Green (Ground)
- Ensure that the entry into the junction box is water tight with a bushing or other water sealing device

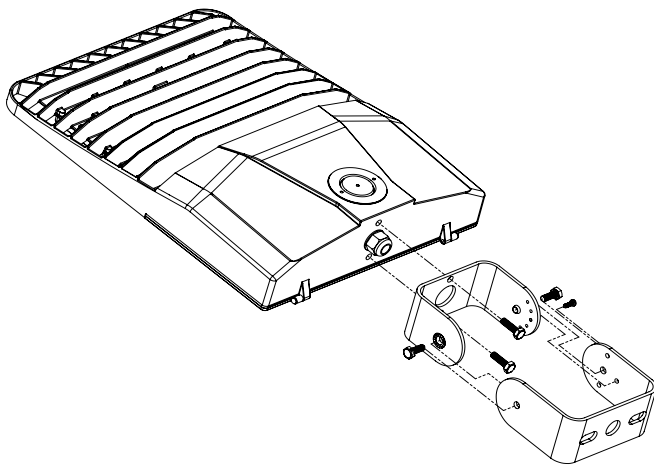

Trunnion Mounting

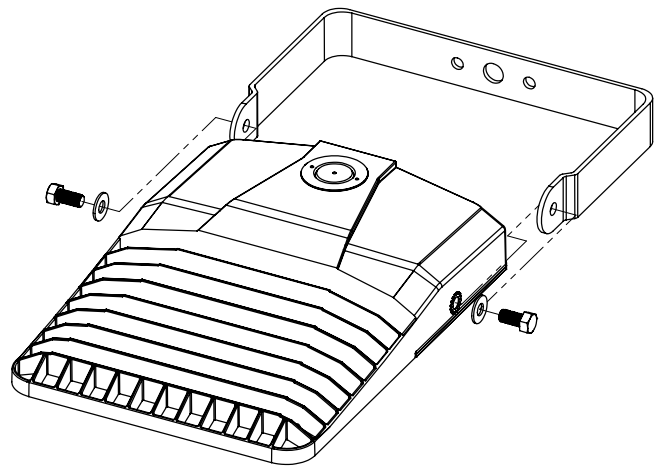

U-Bracket Mounting

Standard Wiring Diagram

