

# Keilton + autani

## WPPA102-W Series

Plug and Play Bluetooth  
Long-Range Controller Node



WPPA102-BH4-W.B1



WPPA102-AUX-W.B1



WPPA102-Z10-W.B1

## Description

The WPPA102-W is a Bluetooth control node designed for integration with wet-listed sensors. It features an enhanced antenna capable of transmitting signals up to 328 feet (100 meters), making it ideal for outdoor applications where extended distances between system nodes are required. The controller is housed in an IP66-rated enclosure, ensuring protection against dust and powerful water jets. The housing is constructed from UV-rated nylon material and finished in black to complement commercial outdoor luminaires. This robust design allows the WPPA102-W to withstand harsh outdoor environments while maintaining reliable wireless communication within the Keilton+autani lighting control system.

## Features

- Magnetic reset function: Factory settings restored by 3-second magnet proximity
- Wireless connectivity: Links to other Keilton+autani devices
- Environmental rating: IP66, suitable for wet locations
- Application: Designed for outdoor and wet location installations
- Housing: UV-rated nylon with black finish
- Antenna: Enhanced long-range capability
- Bluetooth transmission range: Up to 328 ft (100 m)

## Requirement

- Requires Dim-to-Off LED drivers with 12V AUX output
- Requires a mating receptacle, ex. WSC01-AUX, BH4W Z10 (by others), sold separately
- Magnet required to reset to factory settings

## Specifications

Input Voltage	DC 12V
Input Current	41mA Max
Input Power	0.5W
Output Current	10mA Max
Output Power	0.1W
Dimming	Class 2, 0-10V DC 10mA Max
Sinking Current	10mA Max
Bluetooth Transmit	328ft Max
Radio Frequency	2.4GHz ± 75MHz
Bluetooth Version	5.0
Housing Material	UL 94-5VA
Indoor/Outdoor Use	Outdoor Use
Operating Temperature	-30°C to 65°C, -22°F to 149°F
Storage Temperature	-30°C to 85°C, -22°F to 185°F
IP Rating	IP66/Wet Location
Color	Black
Warranty	5 year warranty
Compliance	UL8750, UL1376, RoHS
Compliant Standard Interfaces	Zhaga book 18
Safety	cULus Listed LED Controller E504054 FCC ID: 2A26YLTKVT2022 DID: D061367 DLC: NLTRC5KL0TN

Mating Receptacle (not included in the product package)



Ordering Information - WPPA102-W Series

Model	BASE	Color	Bluetooth Version	Description
WPPA102-BH4-W.B1	BH4	Black	5.0	Plug and Play Bluetooth Long-Range Controller Node
WPPA102-AUX-W.A0	AUX	Black	5.0	
WPPA102-AUX-W.B1	AUX	Black	5.0	
WPPA102-Z10-W.B1	Zhaga Z10	Black	5.0	

Ordering Information - Accessories

Model	Type	Description
WSC01-AUX	Base	Wet Location AUX Receptacle
BH4W	Base	Wet Location BH4 Receptacle
WSC03-AUX	Accessory/Adapter	Wet Location AUX Socket Extension Adapter

Wiring

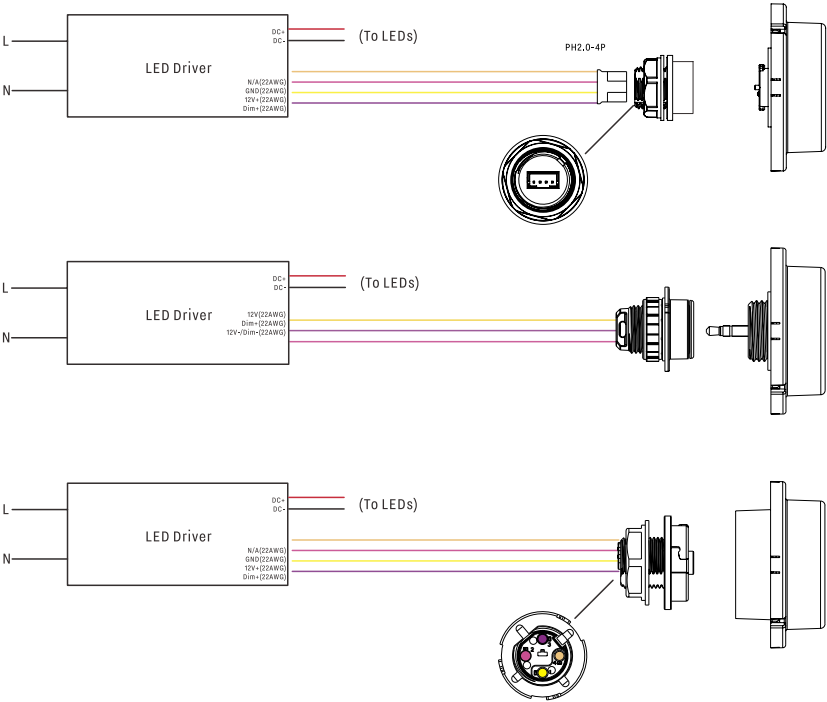

Socket Mounting Dimensions		
Size	T.P.I - inch	Major Dia. - inch
R1/2	14	0.825

Dimensions

Unit:inch/mm

WPPA102-BH4-W

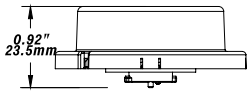

WPPA102-AUX-W

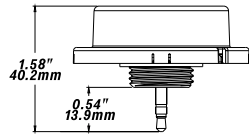

WPPA102-Z10-W

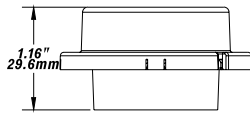

Dimensions - Accessories

WSC01-AUX

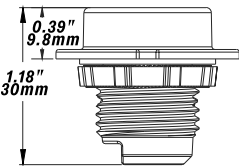

Zhaga Z10 (By Others)

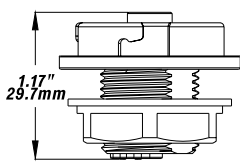

WSC03-AUX

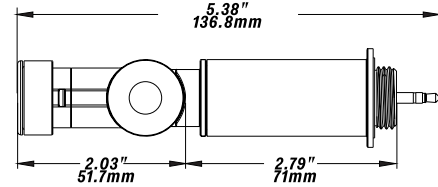

BH4W

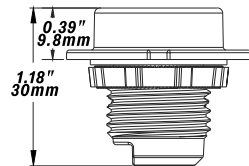

Socket Mounting Dimensions		1/2 inch US standard knockout
Size	T.P.I - inch	Major Dia. - inch
R1/2	14	0.825

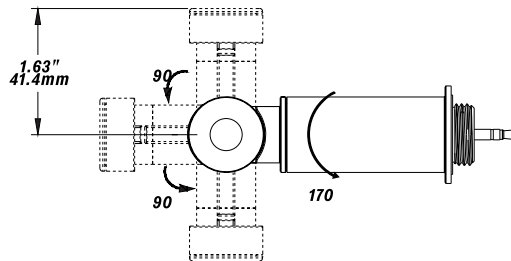

Transmission

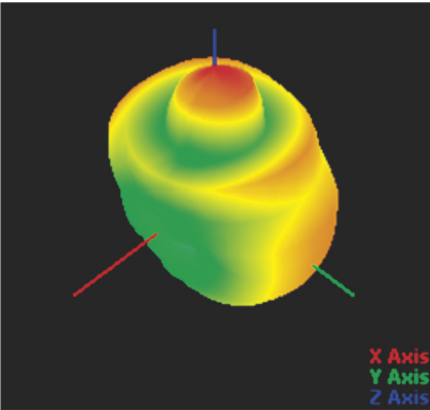

T45-P4 5T

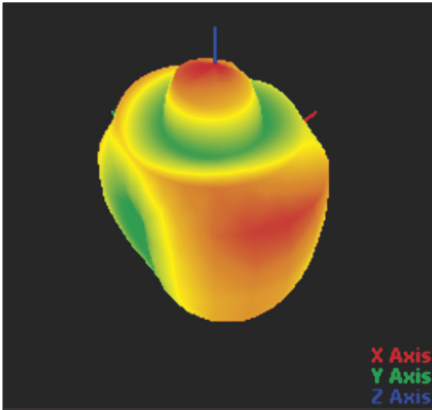

45-P22 5T

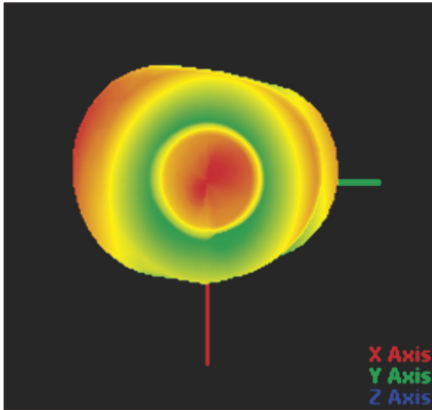

0-P0

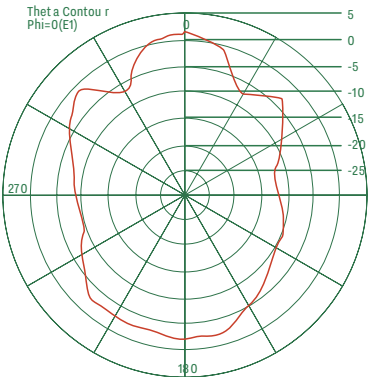

X0Z

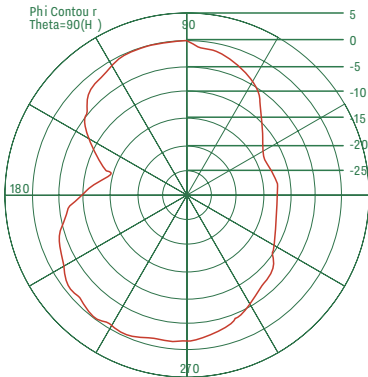

XOY

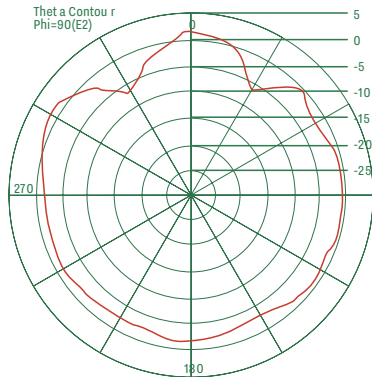

YOZ

Transmission

Wireless Signal Strength	
Transmission Distance	RSSI(dbm)
82ft(25m)	-76
164ft(50m)	-79
246ft(75m)	-87
328ft(100m)	-90

**Note:** The test transmission distance of two WPPA102-W

Product Label

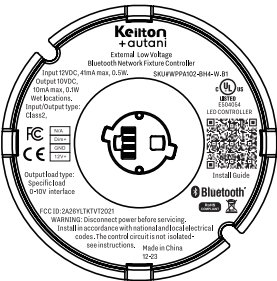

WPPA102-BH4-W.B1



WPPA102-AUX-W.A0



WPPA102-AUX-W.B1

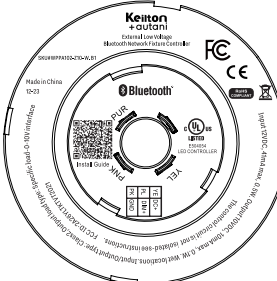

WPPA102-Z10-W.B1

The Bluetooth word mark and logos are registered trademarks owned by Bluetooth SIG, Inc. and any use of such marks by LiteTrace is under license. Other trademarks and trade names are those of their respective owners.

App Download



Due to our continued efforts to improve our products, specifications are subject to change without notice.

Contact Us

7001 Columbia Gateway Drive, Suite 210, Columbia, MD 21046, USA  
T: +1 443-320-2233 (M-F 9am-5pm ET)  
E: support@autani.com