



EFS07-W Series DC Basic High Bay Sensor Plug&Play Type



EFS07-AUX-W
(Lens Sold Separately)



EFS07-BH4-W
(Lens Sold Separately)



EFS07-Z10-W
(Lens Sold Separately)

PHOTOCELL VALUE			
LOW	HIGH	CAL	OFF
5FC	20FC	Configurable LUX	Disable

Description

The EFS07-W series high bay sensors are specifically designed for outdoor use. These sensors feature a photocell, passive infrared (PIR) motion detection, integrated long-range antennas, and a UV-rated nylon housing with a black finish. They are designed for plug-and-play installation in outdoor luminaires equipped with compatible receptacles. Utilizing the advanced AlgoH2 algorithm, the EFS07-W sensors provide accurate motion detection for high bay applications up to 40 feet while minimizing false triggers.

Features

- Photocell and PIR sensing technology with AlgoH2 algorithm for accurate detection up to 40 ft.
- Photocell for Hold ON/OFF operation.
- Compatible with WHBL1 series lens options (sold separately).
- IP66-rated for outdoor and wet locations.
- UV-resistant black nylon housing.

Requirements

- A lens, such as the WHBL1-2-B, is required and sold separately.
- Compatible with Dim-to-Off LED drivers featuring a 12V AUX output.
- Requires a mating receptacle, such as WSC01 or BH4W (sold separately).

Specifications

Input Voltage	DC 12V
Input Current	15mA
Input Power	0.2W
Output Current	10mA Max
Output Power	0.1W
Dimming	Class 2, 0-10V DC 10mA Max
Sinking Current	10mA Max
Housing Material	UL 94-5VA
Detection Range	40-80ft
Mounting Height	20-40ft
IR Remote Distance	Max 26' Indoor/Outdoor Use
Operating Temperature	-30°C to 70°C, -22°F to 158°F
Storage Temperature	-30°C to 85°C, -22°F to 185°F
IP Rating	IP66
Color	Black
Warranty	5-year warranty
Compliance	UL8750, RoHs
Safety	cULus Listed LED Controller E504054

Ordering Information (not included in the product package)



WHBL1



BH4W



WSC01



WSC03

Ordering Information

Model	Description
EFS07-AUX-W.B1	Outdoor photo/PIR Motion sensor of 3.5mm audio jack base
EFS07-BH4-W.B1	Outdoor photo/PIR Motion sensor of BH4 base
EFS07-Z10-W.B1	Outdoor photo/PIR Motion sensor of Z10 base by others

Ordering Information -Accessories table

Model	Type	Description
WHBL1-2-B	Lens	High Bay Lens for wet locations, IP66
BH4W	Base	Wet Location BH4 Receptacle
WSC01	Base	Wet Location AUX Receptacle
WSC03	Accessory/Adapter	Wet Location AUX Socket Extension Adapter

Wiring

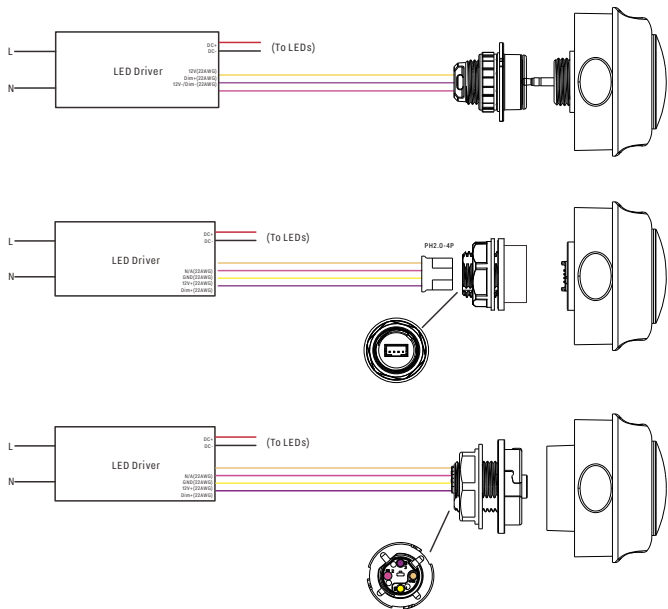

Socket Mounting Dimensions		½ inch US standard knockout
Size	T.P.I - inch	Major Dia. - inch
R1/2	14	0.825

Dimensions

Unit:inch/mm

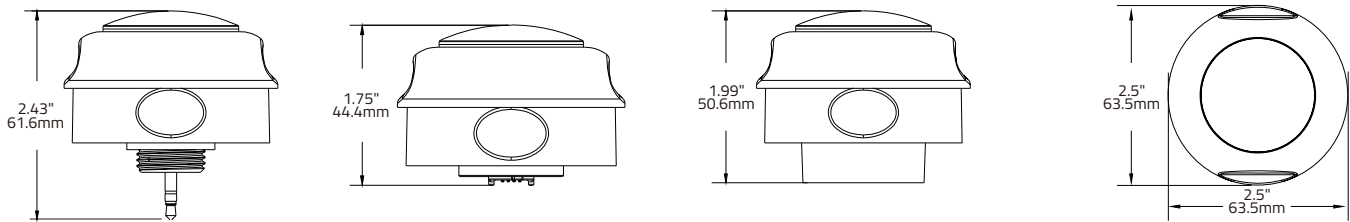

Dimensions - Accessories

Unit: inch/mm

WHBL1 **Note:** SOLD Separately

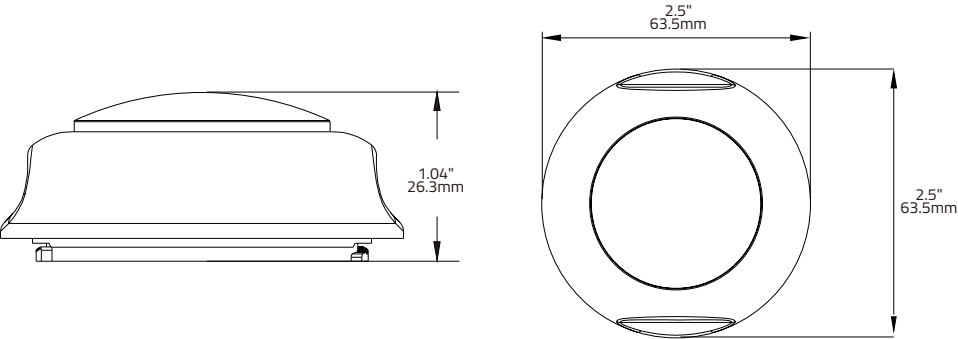

Coverage Side View

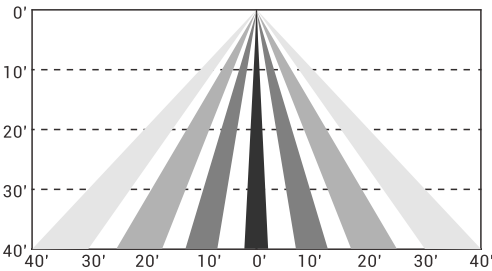

Coverage Top View

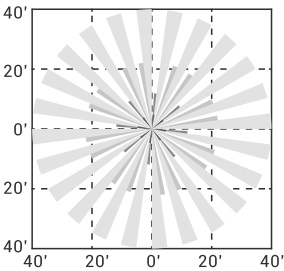

Height 40ft

BH4W

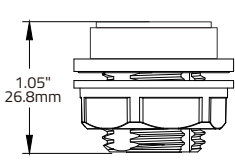

WSC01-AUX

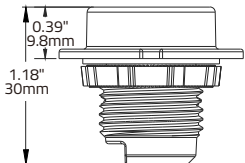

WSC03-AUX

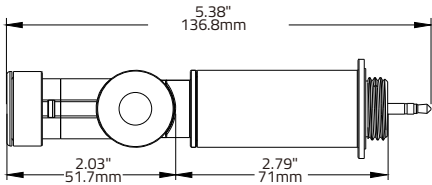

Socket Mounting Dimensions		1/2 inch US standard knockout
Size	T.P.I - inch	Major Dia. - inch
R1/2	14	0.825

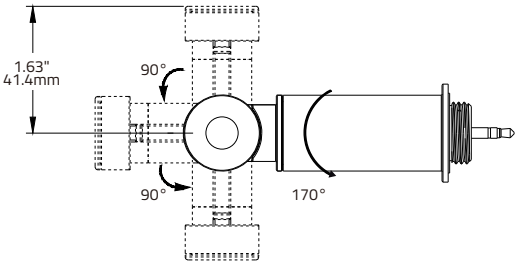

Product Label

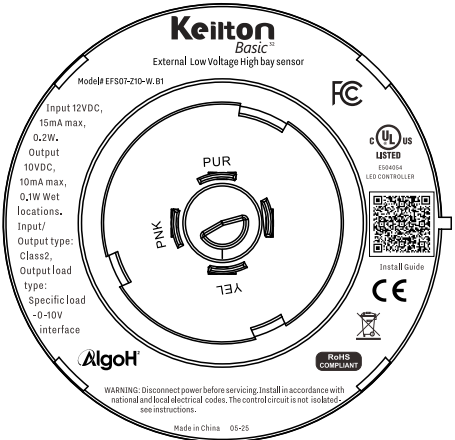
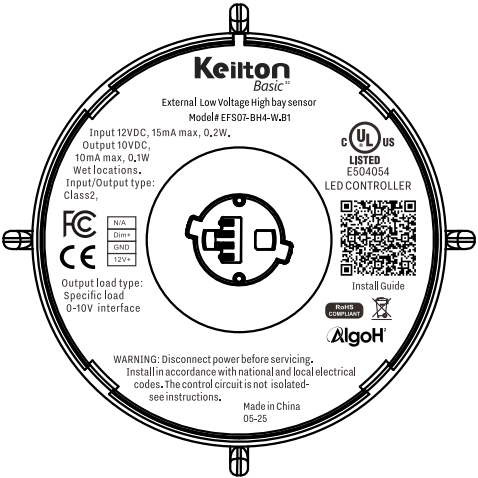

Remote Instructions

Memory Mode (Commissioning)

To begin commissioning, follow these steps:

1. Select a memory profile: A, B, C, D, or E.
2. The remote's indicator lights will flash, indicating the currently saved settings.
3. Settings can be configured by pressing the appropriate buttons in the highlighted gray area of the remote (TRIM-LEVEL, SENSITIVITY, HOLD TIME, STANDBY DIM, STANDBY TIME, and PHOTOCELL). Review the selected settings and make changes as needed.
4. Point the remote at the desired luminaire and press "SEND."
5. The luminaire will flash twice to confirm the settings are saved. Changing a parameter in a memory profile will automatically override previous settings.
6. If configuring multiple luminaires, repeat steps 4 and 5 after selecting the configured memory mode.

* **E Mode** allows for visual adjustment to choose the desired dimming level.

Daylight Harvesting (F Mode)

Continuous Adjustment Mode adjusts dimming levels based on daylight.

1. Point the remote at the desired luminaire and press "ON," then press DIM+ or DIM- to adjust the dimming level.
2. Press "F." The indicator lights on the remote will show the current saved settings. **Note:** Only TRIM-LEVEL, SENSITIVITY, and HOLD TIME can be selected for Daylight Harvesting settings
3. Review the selected settings and make changes as necessary. Press "SEND"
4. If the configuration is successful, the luminaire will flash twice to confirm the setting is saved. If configuring multiple luminaires, select the configured Daylight Harvesting settings, then follow step 1, step 2 and step 3.

ON	Turns ON luminaires.
OFF	Turns OFF luminaires.
TEST	The fixture enters the test mode and exit automatically after 5 minutes, the test mode parameters are configured as follows: Trim-level: 100%, Sensitivity: HIGH, Hold time : 2s, Standby dim: 50%, Standby time: 2s.
RESET	Trim= 100% , Sensitivity = High , T1 = 5 min , Standby Dim = 30% , T2 = 60 min , Photocell = OFF .
DIM+/-	Press Dim+ or Dim- to adjust brightness in 0.5V increments. Hold the button for continuous dimming
TRIM-LEVEL	Set Maximum brightness.
SENSITIVITY	Set the motion sensitivity of the sensor LOW: 50% / HIGH: 100%, OFF: disable the motion detection function.
HOLDTIME	The duration that elapses without occupancy detection before transitioning to standby dim.
STANDBY DIM	Select any standby dim level.
STANDBY TIME	Standby time, when the time is set to "∞", the daylight detection function is activated.
PHOTOCELL	visible light threshold, the fixture is allowed to be turned on when it falls below the threshold LOW: 5fc / HIGH: 20fc, CAL: Collect the current visible light illuminance as the threshold, OFF: disable PHOTOCELL function.
MODE	Default configuration parameters for mode A to F .
SEND	Send settings to sensor.
DEFAULT MODE A	Trim= 100% , Sensitivity = Low , T1 = 30 min , Standby Dim = 50% , T2 = ∞, Photocell = CAL .
DEFAULT MODE B	Trim= 100% , Sensitivity = Low , T1 = 30 min , Standby Dim = 50% , T2 = 15 min , Photocell = CAL .
DEFAULT MODE C	Trim= 100% , Sensitivity = Low , T1 = 30 min , Standby Dim = 50% , T2 = 15 min , Photocell = OFF .
DEFAULT MODE D	Trim= 50% , Sensitivity = Low , T1 = 30 s , Standby Dim = 50% , T2 = 30 min , Photocell = CAL .
DEFAULT MODE E	Manual Dimmer Mode, Trim= 100% .
DEFAULT MODE F	Daylight Harvesting, Trim= 50% , Sensitivity = Low , T1 = 15 min .

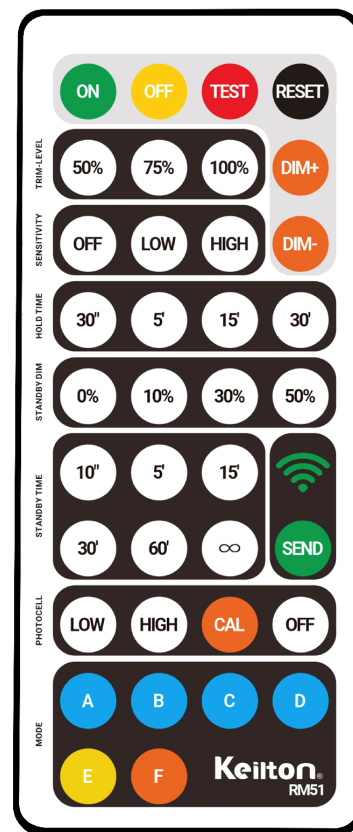

Contact Us

7001 Columbia Gateway Drive, Suite 210, Columbia, MD 21046, USA

T: +1 443-320-2233 (M-F 9am-5pm ET)

E: support@autani.com