

VTOD VTON

APOLLO® VAPORTIGHT HIGH BAY SERIES



HIGH EFFICACY • HIGH EFFICACY • HIGH EFFICACY

2.5X LIFE*

HIGH EFFICACY • HIGH EFFICACY • HIGH EFFICACY

1 2.5X LIFE
VTOD and VTON L70 ratings of 139,000 hours is a minimum of 2.5x as long as the typical economy vapor tight fixture.

2 CONFIGURABLE POWER CONNECTIONS
Hardwire, whip, or liquid tight power connections available. Configured per order.

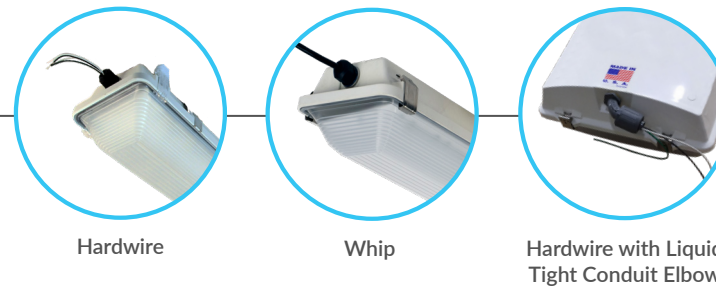

3 DUST PROOF, WATERTIGHT, RUGGED FIXTURE BODY
Durable and versatile fixture suitable for demanding environments with frosted impact resistant, shallow or linear ribbed frosted lens. 316 Marine Grade latches. Lightweight, white, IP67, IP69 and UL 5VA (f1) reinforced fiberglass body. Two fixture sizes available in VTOD1 models: 2' x 2' and 2' x 4'. Two fixture sizes available in VTON1 models: 1' x 4' and 1' x 8'.

4 NSF/ANSI STANDARD 2 SPLASH ZONE CERTIFIED



VTOD1



VTON1



CONTROLS & ACCESSORIES
Factory and field installed options available.



End-mounted Control

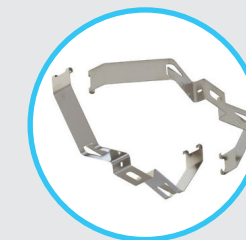

Flush Mount

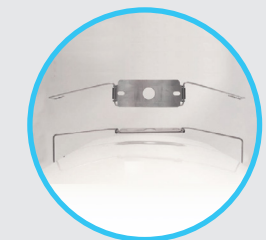

Hanging Bracket CT4

6 HIGH PERFORMANCE COMPONENTS
Top tier electrical components from suppliers with brand and quality integrity. Up to 167 Lumens Per Watt.

5 MULTIPLE FIXTURE OPTIONS

- 10w Battery Back Up
- 10 kV Surge Protection
- Cold temperature as low as -35°C
- End Mounted Wet Rated Sensors

VTOD1 available in lumen packages from 13,000 to 15,000 lumens in 2' and 20,000 to 36,000 lumens in 4'. 120v-277v, 347v, 480v
VTON1 available in lumen packages from 3,000 to 12,000 lumens in 4' and 15,000 to 19,000 lumens in 8'. 120v-277v, 347v, 480v
*LED rated life based on VTOD14C1UNVXXXXSTFR840 and VTON14C1UNVXXXXSTFR840 L70 @ 25°C ambient vs. Economy Vapor Tight Fixture with L70 life at 25°C ambient.



IP67 IP69

