

ILEA SUITE

Features and Specifications

Applications

Ideal for surface lots, walkways, auto-dealerships, area and street lighting.

Certification & Listings

- UL Listed for Wet Locations.
- DesignLights Consortium™ qualified.
- Visit the DLC QPL for listed models.
- Dark Sky Friendly.

Construction

Die-cast aluminum alloy housing. Aluminum conducts heat 5 times faster than steel and provides excellent thermal management. Bladed design of the modular light engines makes for minimal dirt accumulation and better heat transfer.

Optics

The linear LED arrays are expertly fitted to each polycarbonate optic for optimal light distribution. The array spacing and board design maximize conductive heat transfer and extends the LED lifetime. Available in 5000K color temperature and 70 CRI.

Electrical

Available in 120-277v, 347v and 480v. Hardwired, 5 foot whip standard. Includes 10 kV of surge protection standard to protect fixture against voltage spikes. Offering a 12v auxiliary power option to incorporate security cameras, wi-fi and a variety of devices.

Rated Life

125,000 hours.

Operating Temperature

Thermal cycling temperature for 12M series rated at -40°F to 122°F [-40°C to 50°C]. Thermal cycling temperature for 24M series rated at -40°F to 108°F [-40°C to 42°C].

Finish

Textured corrosion resistant powder-coat available in bronze, white, gray, and black. Custom colors available.

Warranty

Orion LED ISON™ Class exterior fixtures are covered by a ten-year limited warranty. Accessories and individual components are covered by separate OEM supplier warranties.



Required Ordering Information

Series	
ILEA	ISON™ LED Area Light

Nominal Lumens	
100L	10,000 lm
130L	13,000 lm
163L	16,300 lm
195L	19,500 lm
227L	22,700 lm
259L	25,900 lm
291L	29,100 lm
324L	32,400 lm
355L	35,500 lm
388L	38,800 lm

Voltage	
UNV	120-277v
347	347v
480	480v

Driver Type	
NDX	Non-Dimming
FDX	Full Dimming ¹

Light Distribution	
T3M	Type 3, Medium
T5M	Type 5, Medium

CRI/Color Temperature	
750	70 CRI; 5000K

Fixture Finish Color*	
BR	Bronze
WH	White
GR	Gray
BL	Black
CC	Custom Color

Auxiliary Power Option*	
(blank)	No Power Option
AD	Auxiliary Direct

Housing Design*	
12M	12 Module Series
24M	24 Module Series

Note, for custom colors, you must contact your sales representative to ensure paint compatibility. Please have an RAL#, or color name & manufacturer available for matching purposes. You will receive a custom part number to reflect your color option once a match has been determined.

* Factory installed 12v DC transformer for auxiliary power.

*See individual specs for lumen package offering per housing design.

Control Options*	
(blank)	No Controls
-PE	Photo Eye
-MS	Motion Sensor with photo eye
-WP	Wireless with Photo Eye ²
-WM	Wireless with Motion and Photo Eye ²

Exterior bracket suite sold separately

Reference specification sheet 'EXT-BRKT'

*Factory wired.

PATENT | PENDING



ILEA SUITE

Performance Information³

Series	Model Type	Nominal Lumens	Light Distribution Type	Input Voltage	Input Power	Input Current	Power Factor	Light Output ⁴	CCT	CRI
ILEA	12M	100L	T5	277v	93w	0.335 A	≥0.90	10,001 lm	5000K	≥70
ILEA	12M	130L	T5	277v	126w	0.454 A	≥0.90	13,254 lm	5000K	≥70
ILEA	12M	163L	T5	277v	159w	0.574 A	≥0.90	16,508 lm	5000K	≥70
ILEA	12M/24M	195L	T5	277v	192w	0.693 A	≥0.90	19,761 lm	5000K	≥70
ILEA	24M	227L	T5	277v	217w	0.783 A	≥0.90	23,015 lm	5000K	≥70
ILEA	24M	259L	T5	277v	258w	0.931 A	≥0.90	26,268 lm	5000K	≥70
ILEA	24M	291L	T5	277v	292w	1.054 A	≥0.90	29,521 lm	5000K	≥70
ILEA	24M	324L	T5	277v	325w	1.173 A	≥0.90	32,775 lm	5000K	≥70
ILEA	24M	355L	T5	277v	358w	1.292 A	≥0.90	36,028 lm	5000K	≥70
ILEA	24M	388L	T5	277v	391w	1.411 A	≥0.90	39,281 lm	5000K	≥70

Physical Information 12M

EPA	Length	Width	Height ⁵	Weight ⁶
1.68	33.695"	13.75"	6.961"	29-44 pounds

Physical Information 24M

EPA	Length	Width	Height ⁵	Weight ⁶
1.68	33.695"	27.5"	6.961"	53 - 83 pounds

Photometrics

Quick photometrics can be run or IES files downloaded on Orion's website at orionlighting.com for all lumen packages. Each lumen package specification sheet includes candela graphs for Type 3 and Type 5 light distribution patterns and physical and performance information.

Housing Design Configurations

Each lumen package offers a variety of standard housing designs. Custom designs are also available by contacting an Orion sales representative. The illustrations below showcase some of Orion's standard configurations.

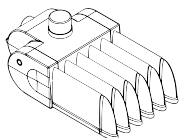

12M 100L D

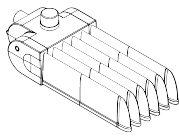

12M 195L A

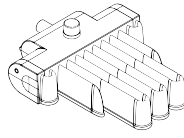

24M 227L A

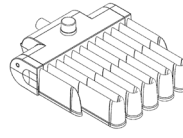

24M 355L

Additional Specification Information

¹ Full dimming driver recommended with 3rd party control system

² Engineering consultation recommended

³ Actual performance may vary by up to ±10% of values listed

⁴ Actual lumens may vary.

⁵ Height is 9.568" with photo cell

⁶ 347v and 480v increases overall weight by 9 to 12 pounds

Important Note

Reference installation instructions or application guide for detailed wiring diagrams, control specifications, bracket assembly, etc.

Installation

Accepts 2.375" O.D. horizontal tenon. A complete suite of brackets sold separately. Exceeds ANSI C136.31-2010 1.5G vibration test. Engineered to 120mph wind speed. [reference installation instructions].